

**TYPICAL CROSS SECTION**  
Scale N.T.S.

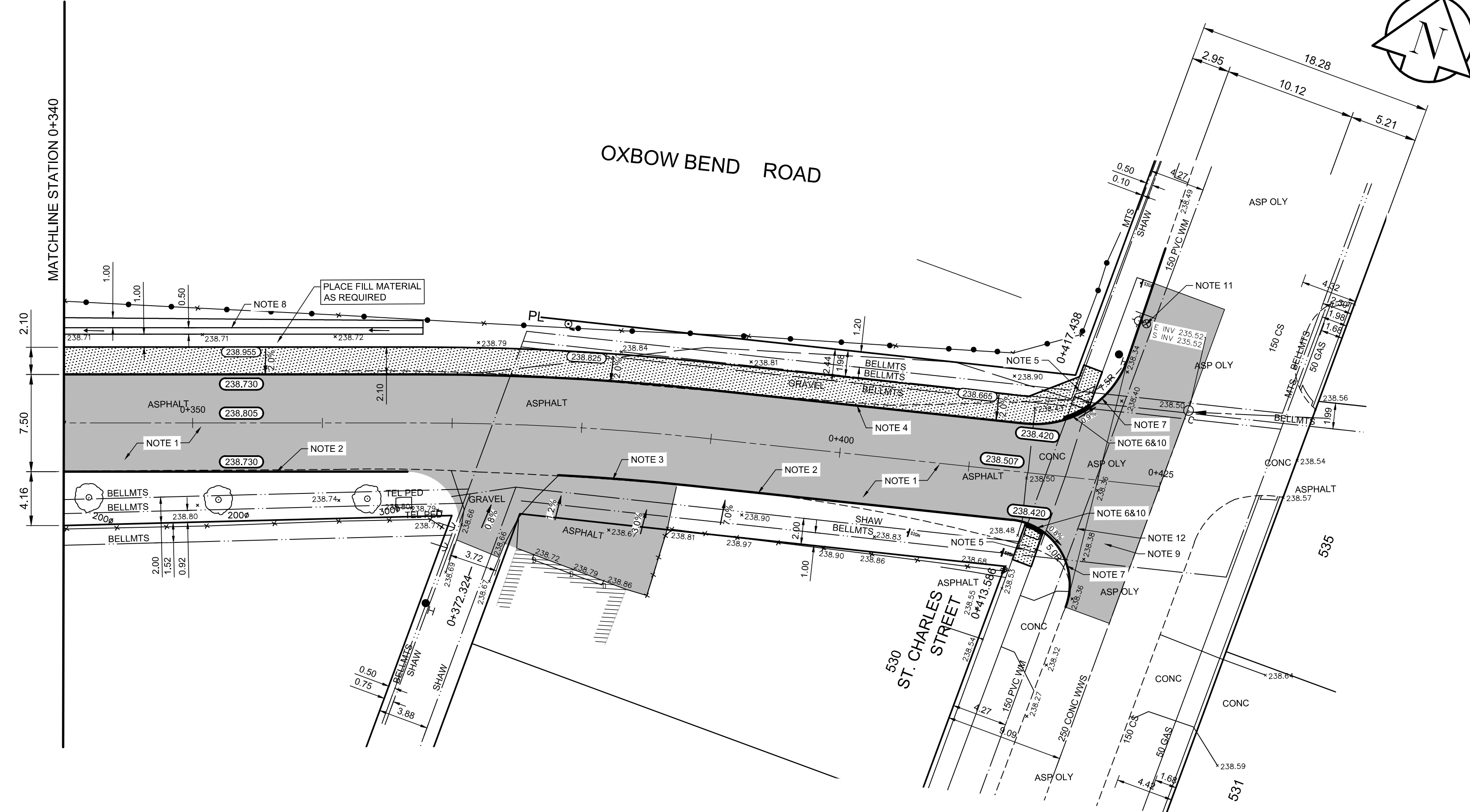

**REFERENCE NOTES:**

- PAVEMENT DIMENSIONS ARE TO BACK OF CURB
- PROPERTY LINES OBTAINED FROM CITY OF WINNIPEG L.B.I.S., AND NO SCALE FACTOR WAS APPLIED
- REFER TO AECOM FIELD BOOK NO. 5185

**CONSTRUCTION NOTES:**

- REMOVE EXISTING PAVEMENT AND CONSTRUCT NEW 50mm TYPE MS1 AND 75mm TYPE MS2 ASPHALT PAVEMENT
- CONSTRUCT NEW CONCRETE BARRIER CURB AND REVERSED GUTTER FOR ASPHALT PAVEMENT (180mm HT.)
- CONSTRUCT NEW CONCRETE LIP CURB (40mm HT.) THROUGH PRIVATE APPROACH
- INSTALL NEW 100mm MONOLITHIC CONCRETE CURB AND SIDEWALK
- RENEW EXISTING 100mm CONCRETE SIDEWALK
- RENEW EXISTING CURB RAMP (10-12mm HT. MONOLITHIC)
- INSTALL NEW CONCRETE MODIFIED BARRIER CURB WITH REVERSED GUTTER FOR ASPHALT PAVEMENT (180mm HT.)
- CONSTRUCT NEW SWALE
- MILL EXISTING ASPHALT PAVEMENT IN SOUTHBOUND LANE OF ST. CHARLES STREET AND PLACE NEW ASPHALT PAVEMENT OVERLAY TYPE MS1 (50mm AVERAGE THICKNESS)
- INSTALL NEW DETECTABLE WARNING SURFACE TILE
- ADJUST EXISTING WATER VALVE TO GRADE
- INSULATE EXISTING WATER MAIN UNDER ROADWAY (3.0m IN WIDTH)

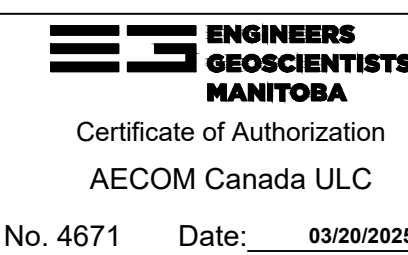

**METRIC**  
WHOLE NUMBERS INDICATE MILLIMETRES  
DECIMALIZED NUMBERS INDICATE METRES

150 mm W.M.	WATERMAIN	150 mm W.M.	HYDRO	HYDRO	PROFILE	LOCATION APPROVED
◇	HYDRANT	◇	M.T.S.	M.T.S.	—X—X—	UNDERGROUND STRUCTURES
⊙	VALVE	⊙	CONCRETE	CONCRETE	—□—□—	
300mm L.D.S.	LAND DRAINAGE SEWER	300mm L.D.S.	ASPHALT	ASPHALT	—◇—◇—	
250mm W.W.S.	WASTEWATER SEWER	250mm W.W.S.	PROPERTY LINE	PROPERTY LINE	—○—○—	
○	MANHOLE	●	SURVEY BAR	SURVEY BAR	—	
□	CATCH BASIN	■	ELEVATION	ELEVATION	(35.750)	
▽	CATCH PIT	▼	TREE	TREE	—	
↑	TRAFFIC SIGNAL POLE	↑	SIDEWALK RAMP	SIDEWALK RAMP	—	
↑	STREET LIGHT	↑	CONCRETE SIDEWALK	CONCRETE SIDEWALK	—	
—	GAS	—	FENCE	FENCE	—	
EXISTING	LEGEND - PLAN	PROPOSED	EXISTING	LEGEND - PLAN	PROPOSED	EXISTING

150 mm W.M.	WATERMAIN	150 mm W.M.	HYDRO	HYDRO	PROFILE	LOCATION APPROVED
◇	HYDRANT	◇	M.T.S.	M.T.S.	—X—X—	UNDERGROUND STRUCTURES
⊙	VALVE	⊙	CONCRETE	CONCRETE	—□—□—	
300mm L.D.S.	LAND DRAINAGE SEWER	300mm L.D.S.	ASPHALT	ASPHALT	—◇—◇—	
250mm W.W.S.	WASTEWATER SEWER	250mm W.W.S.	PROPERTY LINE	PROPERTY LINE	—○—○—	
○	MANHOLE	●	SURVEY BAR	SURVEY BAR	—	
□	CATCH BASIN	■	ELEVATION	ELEVATION	(35.750)	
▽	CATCH PIT	▼	TREE	TREE	—	
↑	TRAFFIC SIGNAL POLE	↑	SIDEWALK RAMP	SIDEWALK RAMP	—	
↑	STREET LIGHT	↑	CONCRETE SIDEWALK	CONCRETE SIDEWALK	—	
—	GAS	—	FENCE	FENCE	—	
EXISTING	LEGEND - PLAN	PROPOSED	EXISTING	LEGEND - PROFILE	PROPOSED	EXISTING

DESIGNED BY	BC	CHECKED BY	RC
DRAWN BY	RAM	APPROVED BY	RC
HOR. SCALE:	1:250	RELEASED FOR CONSTRUCTION BY:	
VERTICAL:	1:10	DATE	01/31/2025
0 ISSUED FOR TENDER	03/20/2025	BC	
A ISSUED FOR REVIEW	01/31/2025	BC	
NO. REVISIONS	DATE	BY	

ENGINEER'S SEAL	THE CITY OF WINNIPEG PUBLIC WORKS DEPARTMENT ENGINEERING DIVISION	CITY DRAWING NUMBER
CONSULTANT DRAWING NO. CT-22	2025 LOCAL STREET RENEWAL PROGRAM	SHEET 22 OF 33
	OXBOW BEND ROAD - WEST END TO ST. CHARLES STREET PAVEMENT RECONSTRUCTION STATION 0+340 TO ST. CHARLES STREET	