

SHERBROOK STREET - STAGE 3 (BROADWAY TO ELLICE AVE) & STAGE 2 (ELLICE AVE TO SARGENT AVE)

Scale 1:500

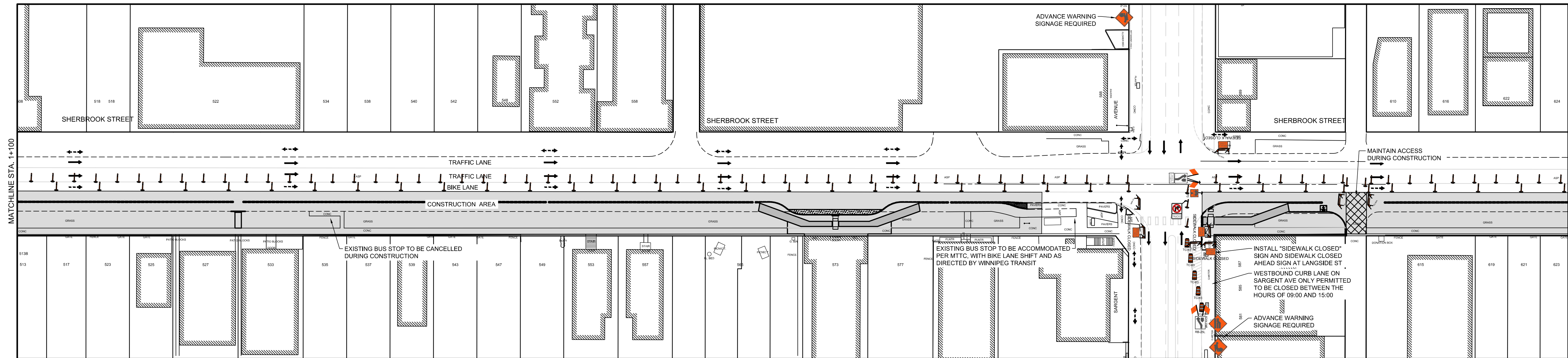

SHERBROOK STREET - STAGE 2 (ELLICE AVE TO SARGENT AVE) & STAGE 1 (SARGENT AVE TO CUMBERLAND AVE)

Scale 1:500

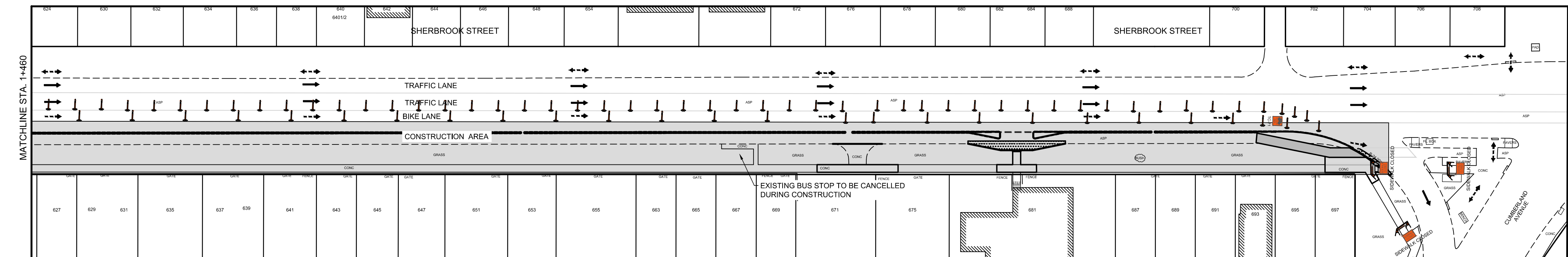

SHERBROOK STREET - STAGE 1 (SARGENT AVE TO CUMBERLAND AVE)

Scale 1:500

- LEGEND
- CONSTRUCTION AREA - PHASE A
 - CONSTRUCTION AREA - PHASE B
 - TRAFFIC
 - CYCLIST
 - PEDESTRIAN

- NOTES:
- ALL TEMPORARY SIGNAGE AND TRAFFIC CONTROL IN ACCORDANCE WITH THE LATEST EDITION OF THE MANUAL OF TEMPORARY TRAFFIC CONTROL ON CITY STREETS.
 - CONTRACTOR TO MAINTAIN VEHICLE ACCESS TO ALL SIDE STREETS AND PRIVATE APPROACHES AT ALL TIMES UNLESS NOTED BY THE CONTRACT ADMINISTRATOR. ANY DISRUPTION TO BE APPROVED BY THE CONTRACT ADMINISTRATOR AND CONTRACTOR TO ADVISE OWNER.
 - CONTRACTOR TO MAINTAIN PEDESTRIAN ACCESS ON ONE SIDE OF SHERBROOK STREET AND ONE EAST-WEST AND NORTH-SOUTH PEDESTRIAN CROSSING AT THE INTERSECTIONS OF SHERBROOK STREET WITH BROADWAY AND PORTAGE AVENUE AT ALL TIMES.
 - PROPERLY EQUIPPED FLAG PERSONS ARE REQUIRED WHEN MOVING ANY CONSTRUCTION VEHICLES INTO OR OUT OF TRAFFIC.
 - CONTRACTOR TO INSTALL AND MAINTAIN ALL REQUIRED SIGNAGE. CONTRACTOR IS RESPONSIBLE FOR TRAFFIC CONTROL SIGNAGE AND REGULATORY SIGNAGE, WHICH INCLUDES POSTING PARKING RESTRICTIONS FOR CONSTRUCTION ACCESS AND TEMPORARY LOADING ZONES.
 - TYPICAL SPACING BETWEEN POLYPOSTS IS 9.0m.

LOCATION APPROVED UNDERGROUND STRUCTURES

SUPV. U/G STRUCTURES COMMITTEE DATE

NOTE:
LOCATION OF UNDERGROUND STRUCTURES AS SHOWN ARE BASED ON THE BEST INFORMATION AVAILABLE. BUT NO GUARANTEE IS GIVEN THAT ALL EXISTING UTILITIES ARE SHOWN OR THAT THE GIVEN LOCATIONS ARE EXACT. CONFIRMATION OF EXISTENCE AND EXACT LOCATION OF ALL SERVICES MUST BE OBTAINED FROM THE INDIVIDUAL UTILITIES BEFORE PROCEEDING WITH CONSTRUCTION.

B.M. ELEV.

0	ISSUED FOR TENDER	08/28/2025	RC		
A	ISSUED FOR REVIEW	08/20/2025	BC		
NO.	REVISIONS	DATE	BY	DATE	08/20/2025

AECOM

DESIGNED BY	RC	CHECKED BY	BC
DRAWN BY	PAAP	APPROVED BY	RC
HOR. SCALE:	1:500	RELEASED FOR CONSTRUCTION BY:	
VERTICAL:	N/A		

ENGINEER'S SEAL

CONSULTANT DRAWING NO. CT-02

ENGINEERS
GEOSCIENTISTS
MANITOBA

Certificate of Authorization
AECOM Canada ULC

No. 4671 Date: August 28, 2025

METRIC

WHOLE NUMBERS INDICATE MILLIMETRES
DECIMALIZED NUMBERS INDICATE METRES

THE CITY OF WINNIPEG
PUBLIC WORKS DEPARTMENT
ENGINEERING DIVISION

SHERBROOK STREET BIKE LANE IMPROVEMENTS

CONSTRUCTION STAGING AND TRAFFIC MANAGEMENT PLAN
NORTH OF PORTAGE AVENUE TO CUMBERLAND AVENUE

CITY DRAWING NUMBER

SHEET 01 OF 08