

**1**  
M2 **PARTIAL MAIN FLOOR PLAN - PLUMBING RENOVATION**  
SCALE 1/4" = 1'-0"

- RENOVATION NOTES:**
- NEW WALL MOUNTED LAVATORY
  - NEW FLOOR MOUNTED WATER CLOSET
  - NEW 1/2" DCW AND DHW LINE C/W 1/2" INSULATION, CONNECTED TO EXISTING DCW AND DHW LINES IN THE CEILINGS SPACE
  - NEW VENT LINE CONNECTED TO THE EXISTING VENT LINE IN CEILING SPACE
  - NEW 1 1/2" UNDERSLAB SANITARY LINE, CONNECT TO THE EXISTING SANITARY LINE
  - CONNECT NEW SINK TO THE EXISTING PLUMBING LINES IN THE WALL
  - NEW 3" UNDERSLAB SANITARY LINE CONNECT TO THE EXISTING SANITARY LINE

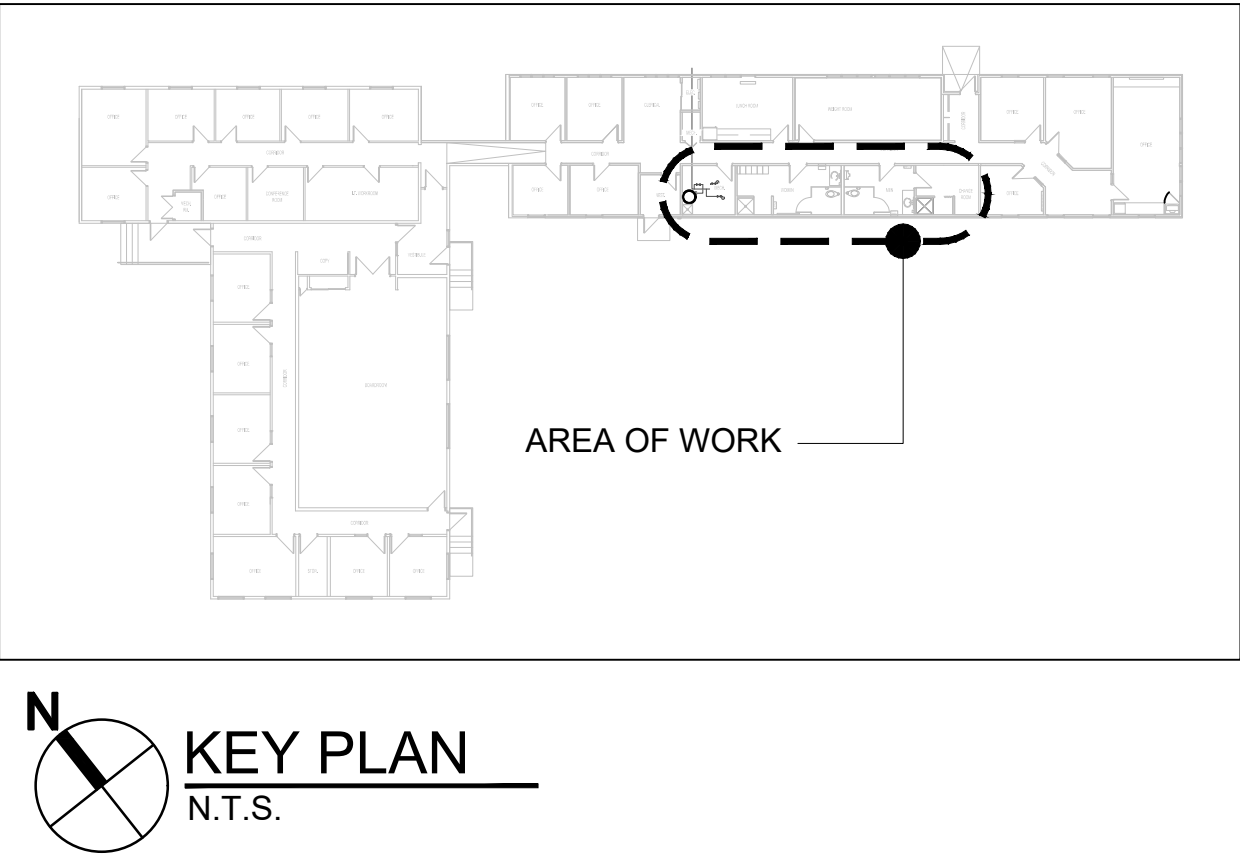

- GENERAL NOTES**
- THIS DRAWING SHALL NOT BE SCALED.
  - THE CONTRACTOR SHALL VISIT THE SITE AND SATISFY ONESELF ALL DIMENSIONS, DATUM, AND DETAILED INFORMATION SHOWN ARE CORRECT.
  - THE CONTRACTOR IS TO REVIEW AND COORDINATE ALL ARCHITECTURAL, MECHANICAL, AND ELECTRICAL DRAWINGS FOR ADDITIONAL OPENINGS THROUGH FLOORS, WALLS, AND CEILINGS FOR DUCT, PIPE AND ELECTRICAL RISERS AND ALL OPENINGS NOT SHOWN ON DRAWINGS.
  - ALL OPENING THROUGH FIRE ASSEMBLIES ARE TO BE FIRED STOPPED AND SEALED WITH ULC APPROVED FIRE STOPPING TO MAINTAIN THE INTEGRITY OF THE FIRE SEPARATION, AND PROVIDE A SMOKE TIGHT BARRIER.
  - ALL PRODUCTS AND MATERIALS TO BE USED AND INSTALLED SHALL CONFORM WITH MANUFACTURER'S SPECIFICATIONS & APPLICABLE CODES.
  - THE CONTRACTOR SHALL BE RESPONSIBLE TO PATCH AND MAKE GOOD ALL EXISTING CONSTRUCTION AFFECTED BY THE REMOVAL OF ALL ITEMS FORMING PART OF THE RENOVATION WORK.
  - THE CONTRACTOR IS RESPONSIBLE FOR INSTALLING RISERS, SWING JOINTS AND DEEP CUP ESCUTCHEONS AS REQUIRED.
  - ELECTRICAL WIRING SHALL BE PERFORMED BY A QUALIFIED ELECTRICAL SUBTRADE.



0	ISSUED FOR CONSTRUCTION	XYW	05.01 2025
No.	REVISION/DESCRIPTION	BY	DATE

SEAL

2025.05.01	XYW	HA	XYW	XYW
DATE	DESIGNED	DRAWN	CHECKED	APPROVED

**Winnipeg** THE CITY OF WINNIPEG  
ASSETS & PROJECT MANAGEMENT  
DEPARTMENT  
MUNICIPAL ACCOMMODATIONS DIVISION  
3-65 GARRY STREET, R3C 4K4

PROJECT  
FLEET MANAGEMENT OFFICES  
WASHROOM UPGARDE

770 ROSS AVENUE

SHEET TITLE  
PARTIAL MAIN FLOOR PLAN  
PLUMBING RENOVATION

SCALE	PROJECT No:	SHEET No:
AS SHOWN	2024-119	M2

DRAWING SHEET SIZE: D (24" x 36") PLOT 1:1

## ASBESTOS

ASBESTOS MAYBE PRESENT  
BEHIND WALLS, CEILING SPACES & FLOORS.  
IF ASBESTOS OR ANY HAZARDOUS MATERIAL  
IS FOUND, STOP WORK IMMEDIATELY AND  
CONTACT CITY OF WINNIPEG CENTRAL  
CONTROLS @ 204 986-2351.