

- NOTES
1. ADJUST MH AND CB RIMS TO NEW GRADES.
  2. LAMP STANDARDS, HYDRO POLES, AND ANCHORS THAT REQUIRE TEMPORARY SUPPORT, REMOVAL OR REPLACEMENT, TO BE DONE SO AT THE EXPENSE OF THE CONTRACTOR AS NECESSARY.
  3. CONTRACTOR TO TAKE PRECAUTIONARY STEPS TO PROTECT EXISTING TREES WITHIN THE LIMITS OF CONSTRUCTION FROM DAMAGE FROM CONSTRUCTION ACTIVITIES AS OUTLINED IN THE SPECIFICATIONS.
  4. CONTRACTOR TO CONFIRM THE LOCATION OF ALL UTILITIES/SERVICES IN THE FIELD PRIOR TO CONSTRUCTION.
  5. CB SD-023 & SD-024 OFFSETS ARE DIMENSIONED TO BOC. CB SD-025 OFFSETS ARE DIMENSIONED O/C. TF-100 OFFSETS ARE DIMENSIONED TO FACE OF CURB.
  6. REFER TO TENDER FOR DETAILS REGARDING TRAFFIC MANAGEMENT.
  7. REFER TO TENDER SPECIFICATIONS FOR CONSTRUCTION REQUIREMENTS NEAR EXISTING GAS MAINS OR SERVICES.
  8. ADD 200,000 m TO ABBREVIATED ELEVATIONS TO OBTAIN GEODETIC ELEVATIONS.
  9. BULLNOSES SHALL BE MONOLITHIC CONCRETE AS PER SD-227C, TRANSITION FROM 100mm MOUNTABLE CURB OVER 3.0m.
  10. PRIVATE APPROACHES SHALL BE FINISHED WITH A MINIMUM 300mm GRANULAR A BASE COURSE AND 60mm SP 1 TO BACK OF RADI.

- EXISTING PAVEMENT
- THE CONTRACTOR SHALL BE AWARE THAT SOME OF THE EXISTING PAVEMENT WAS LEFT IN PLACE DURING THE PREVIOUS RECONSTRUCTION OF SOUTHBOUND PEMBINA HIGHWAY.
  - THE DEPTH OF THE PAVEMENT IS BETWEEN 450mm AND 600mm BELOW EXISTING GRADE.
  - EXISTING PAVEMENT WITHIN THE PROPOSED PAVEMENT STRUCTURE SHALL BE REMOVED AND PAID AS CONCRETE PAVEMENT REMOVAL AND SHALL BE BACKFILLED WITH SUITABLE SITE FILL.

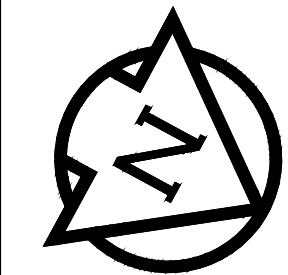

**METRIC**  
WHOLE NUMBERS INDICATE MILLIMETRES  
DECIMALIZED NUMBERS INDICATE METRES

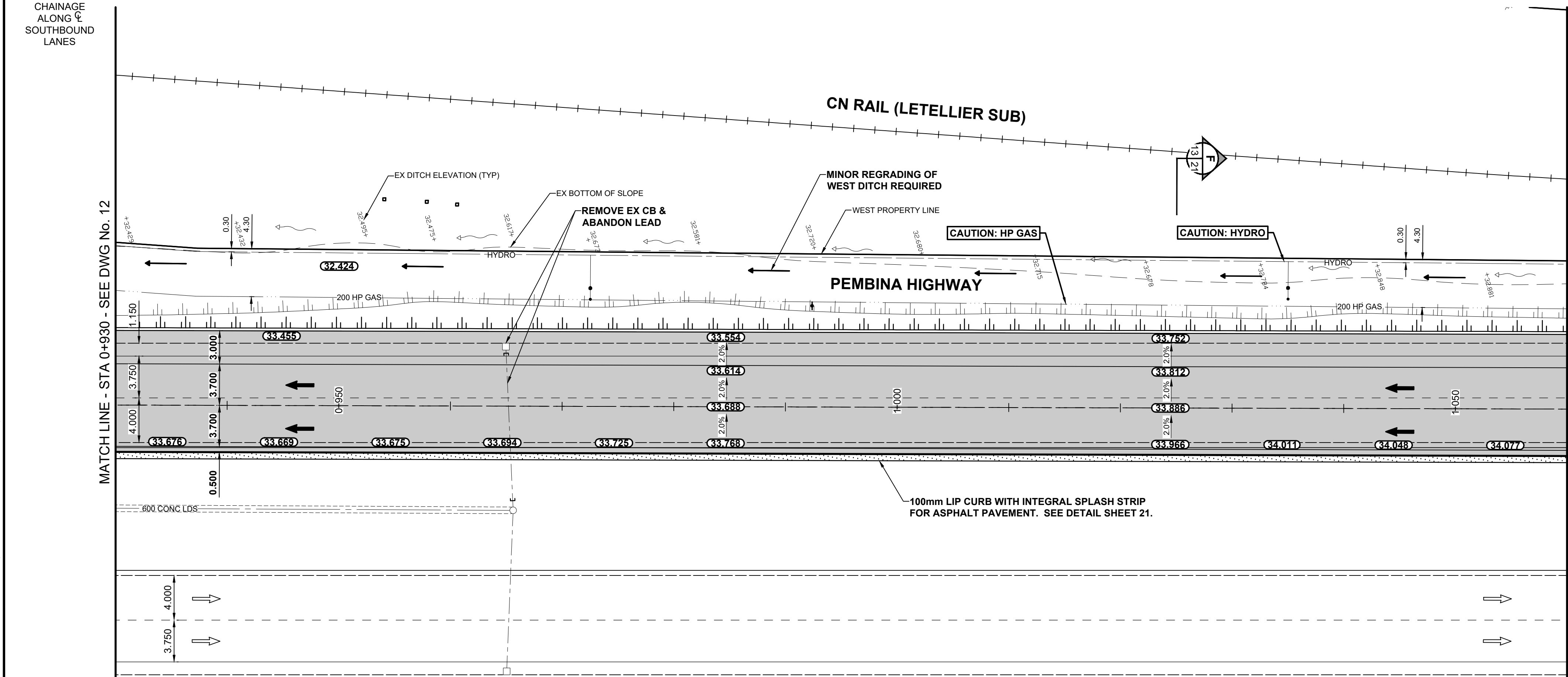

EXISTING	LEGEND - PLAN	PROPOSED	EXISTING	LEGEND - PLAN	PROPOSED	EXISTING	LEGEND - PLAN	PROPOSED
	HYDRANT			LDS / WWS			CONCRETE	
	VALVE			WATER MAIN			CONC SIDEWALK / MEDIAN	
	CURB STOP			GAS			ASPHALT	
	MANHOLE			TRAFFIC SIGNALS			PAVING STONE	
	CATCH BASIN / CATCH PIT			HYDRO / STREET LIGHT			GRAVEL	
	CURB INLET			COMMUNICATIONS			PLANING / REMOVAL	
	POLE			CURB RENEWAL			DITCH FLOW	
	LIGHT STANDARD			PROPERTY LINE			TOP OF SLOPE	
	TRAFFIC SIGNAL POLE			RAMP CURB			CULVERT	
	SURVEY BAR			ELEVATIONS			SEWER FLOW DIRECTION	
	GEODETIC BENCH MARK			TREE / TREELINE			TH-12	
	LEGEND - PLAN			LEGEND - PLAN			LEGEND - PLAN	

**LOCATION APPROVED**  
UNDERGROUND STRUCTURES

SUPR. U/G STRUCTURES DATE

**NOTE:**  
LOCATION OF UNDERGROUND STRUCTURES AS SHOWN ARE BASED ON THE BEST INFORMATION AVAILABLE BUT NO GUARANTEE IS GIVEN THAT ALL EXISTING UTILITIES ARE SHOWN OR THAT THE GIVEN LOCATIONS ARE EXACT. CONFIRMATION OF EXISTENCE AND EXACT LOCATION OF ALL SERVICES MUST BE OBTAINED FROM THE INDIVIDUAL UTILITIES BEFORE PROCEEDING WITH CONSTRUCTION.

BM	88-012	W. side Pembina Hwy., Tbl. in S. Conc. foundation of No. 3525/3527 Pembina Hwy., 1.0 m W. & 0.3 m below brick from S.E. Cor. of Bldg. (Post Office)		
ELEV	233.291 m			
0	ISSUED FOR TENDER		25/03/18	MEE
No.	REVISIONS		YY/MM/DD	BY

500 - 311 Portage Avenue, Winnipeg M8 Canada R3B 2B9  
Tel. 204.489.5900 Fax. 204.453.9012 www.stantec.com

DESIGNED BY	MEE	CHECKED BY	JGK
DRAWN BY	DML	APPROVED BY	RPB
HOR SCALE 1:250		RELEASED FOR CONSTRUCTION	
VERT SCALE 1:10		DATE	
March 14, 2025		DATE	

PROFESSIONAL'S SEAL

PROVINCE OF MANITOBA

M.E. EDGAR  
Member 45339

REGISTERED PROFESSIONAL ENGINEER

CONSULTANT FILE NAME

08660c-200.dwg

**THE CITY OF WINNIPEG**  
PUBLIC WORKS DEPARTMENT  
ENGINEERING DIVISION

**2025 REGIONAL STREET RENEWALS**  
**SOUTHBOUND PEMBINA HIGHWAY**  
**RECONSTRUCTION AND RESURFACING**  
**LA SALLE RIVER TO PERREAULT AVE**  
**SOUTHBOUND PEMBINA HIGHWAY**  
STA 0+930 TO STA 1+060

CITY DRAWING NUMBER	P-3589-13
SHEET	13 OF 24
13	

**ENGINEERS  
GEOSCIENTISTS  
MANITOBA**  
Certificate of Authorization  
Stantec Consulting Ltd.  
No. 1301

TENDER No. 45-2025