

**2 TIMBER FENCE ELEVATION**  
Scale: 1:30

**GENERAL NOTES**

1. ALL WORK TO CONFORM TO CURRENT CITY OF WINNIPEG STANDARD CONSTRUCTION SPECIFICATIONS AND DETAILS UNLESS OTHERWISE NOTED.
2. DIMENSIONS ARE IN MILLIMETERS UNLESS OTHERWISE NOTED.
3. DO NOT SCALE DRAWINGS.
4. ALL LUMBER ACQ TREATED BROWN NO. 2 OR BETTER PINE.
5. HARDWARE TO BE ACQ APPROVED, SUITABLE FOR OUTDOOR APPLICATION AND SIZED TO SUIT TIMBER MEMBERS.
6. ALL WOOD CUTS SHALL BE SANDED AND TREATED WITH AN APPROPRIATE, CLEAR PRESERVATIVE.

**1 TIMBER FENCE SECTION**  
Scale: 1:30

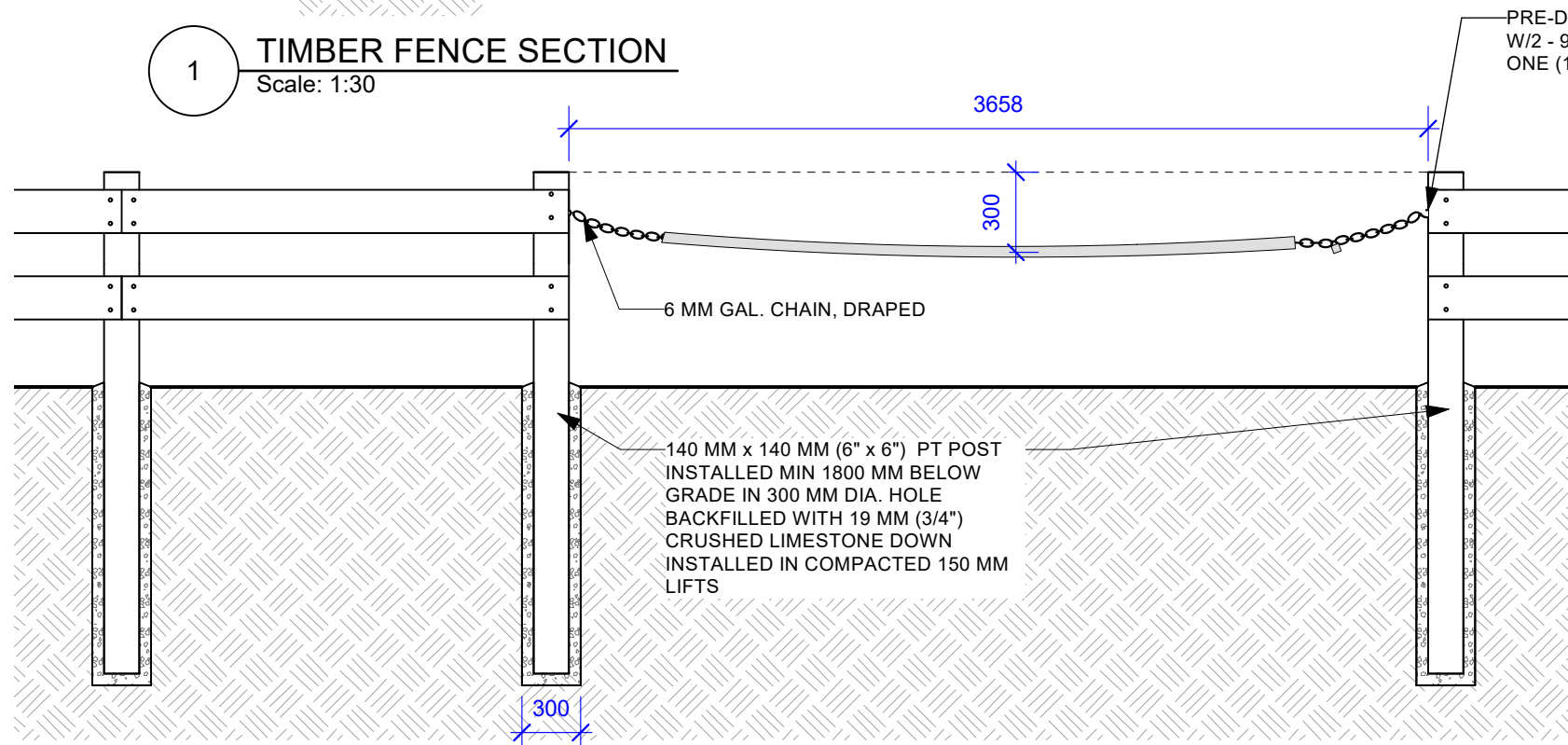

**3 TIMBER FENCE C/W ACCESS GATE ELEVATION**  
Scale: 1:30

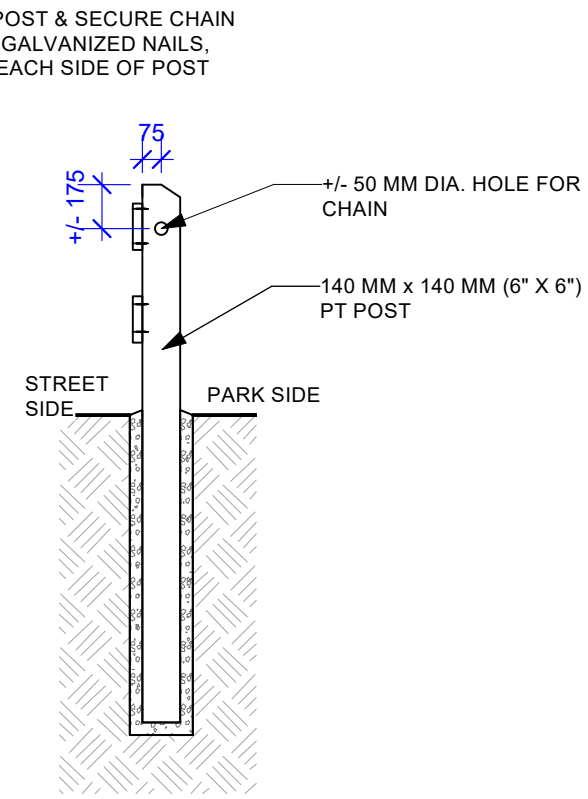

**4 TIMBER FENCE C/W ACCESS GATE SECTION**  
Scale: 1:30

CONTRACTOR TO CONFIRM ALL DIMENSIONS AND REPORT ANY DISCREPANCIES TO CONTRACT ADMINISTRATOR PRIOR TO CONSTRUCTION. LOCATION OF UNDERGROUND STRUCTURES AS SHOWN ARE BASED ON THE BEST INFORMATION AVAILABLE BUT NO GUARANTEE IS GIVEN THAT ALL EXISTING UTILITIES ARE SHOWN OR THAT THE GIVEN LOCATIONS ARE EXACT. CONFIRMATION OF EXISTENCE AND EXACT LOCATION OF ALL SERVICES MUST BE OBTAINED FROM THE INDIVIDUAL UTILITIES BEFORE PROCEEDING WITH CONSTRUCTION.



THE CITY OF WINNIPEG  
Planning, Property and Development Department  
Planning and Land Use Division  
Unit 15 - 30 Fort Street, Winnipeg, MB, (R3C 4X5)

DESIGNED BY

CHECKED BY

DRAWN BY

MA

APPROVED BY

HORIZ. SCALE

As Shown

VERT. SCALE

DATE

April 2025

MANAGER,  
PARK AND OPEN SPACES

DATE

MANAGER,  
PLANNING AND LAND USE DIVISION

DATE

DRAWING TITLE

**Brooklyn Park South Tot Lot  
Playground Redevelopment**

Details

SITE ADDRESS

242 Brooklyn St

DRAWING NO.

**B.52-B5**

BID OPPORTUNITY NO.  
**377-2025**