

CONSTRUCTION NOTES:

- ALL WORKS TO BE CONSTRUCTED IN ACCORDANCE WITH THE LATEST REVISION OF THE CITY OF WINNIPEG STANDARD CONSTRUCTION SPECIFICATIONS AND THE SPECIFICATIONS FOR THIS CONTRACT.
- THE CONTRACTOR IS RESPONSIBLE FOR CONTACTING UTILITY COMPANIES AND ARRANGING FOR LOCATES FOR ALL UNDERGROUND INFRASTRUCTURE AND SAFETY WATCHES DURING CONSTRUCTION. LOCATES SHOULD BE UNDERTAKEN PRIOR TO CONSTRUCTION.
- LOCATION OF EXISTING UTILITIES/SERVICES TO BE CONFIRMED IN THE FIELD BY THE CONTRACTOR.
- THE CONTRACTOR IS RESPONSIBLE FOR THE CONTROL OF RUNOFF FROM RAINFALL, SNOWMELT, GROUNDWATER, INFRASTRUCTURE OR EQUIPMENT DURING ALL STAGES OF THE PROJECT.
- CONTRACTOR TO TAKE PRECAUTIONARY STEPS TO AVOID DAMAGE FROM CONSTRUCTION ACTIVITIES TO TREES WITHIN THE LIMITS OF CONSTRUCTION.
- TRENCHES AND EXCAVATIONS WITHIN 1 METRE OF A PAVED AREA INCLUDING SIDEWALKS SHALL BE CLASS 3 BACKFILL.
- ANY RESTORATION OF PAVEMENT CUTS MUST ADHERE TO THE PAVEMENT RESTORATION GUIDELINES IN THE MOST RECENT EDITION OF THE CITY OF WINNIPEG'S STREET CUTS MANUAL.
- THE CONTRACTOR IS RESPONSIBLE FOR ALL INCIDENTAL EROSION CONTROL MEASURES.

METRIC

WHOLE NUMBERS INDICATE MILLIMETRES  
DECIMALIZED NUMBERS INDICATE METRES

\*CAUTION  
EXACT LOCATIONS OF EXISTING UTILITIES  
AT TIME OF DESIGN UNKNOWN.  
CONTRACTOR TO LOCATE ALL CONNECTIONS AND  
UTILITIES PRIOR TO CONSTRUCTION.  
ALIGNMENTS OF PROPOSED SEWERS ARE  
SUBJECT TO CHANGE DUE TO CONFLICTS.

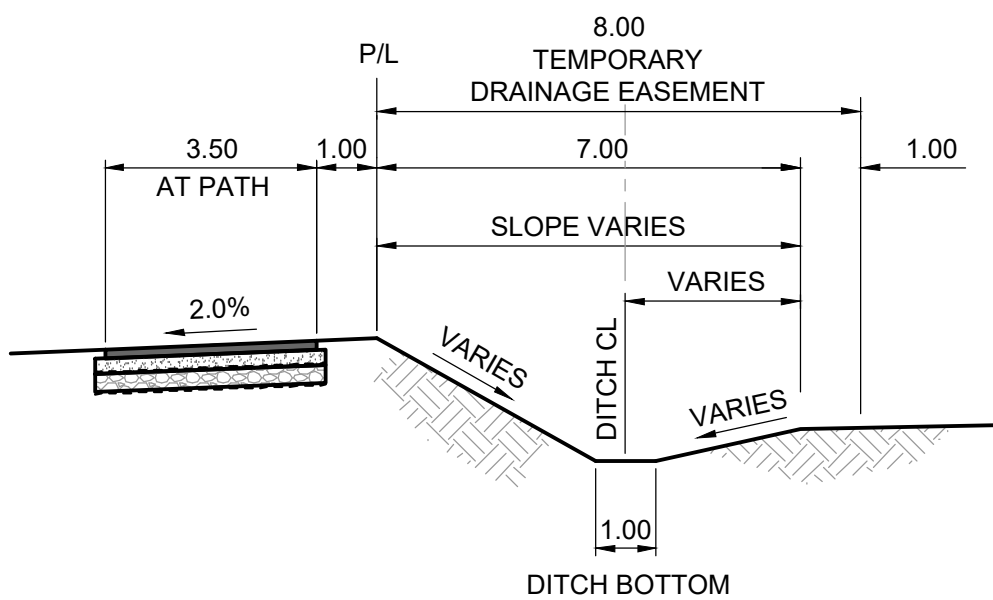

1  
-  
-  
DITCH SECTION  
N.T.S.

**ENGINEERS  
GEOSCIENTISTS  
MANITOBA**  
Certificate of Authorization  
Tetra Tech Canada Inc.  
No. 6499

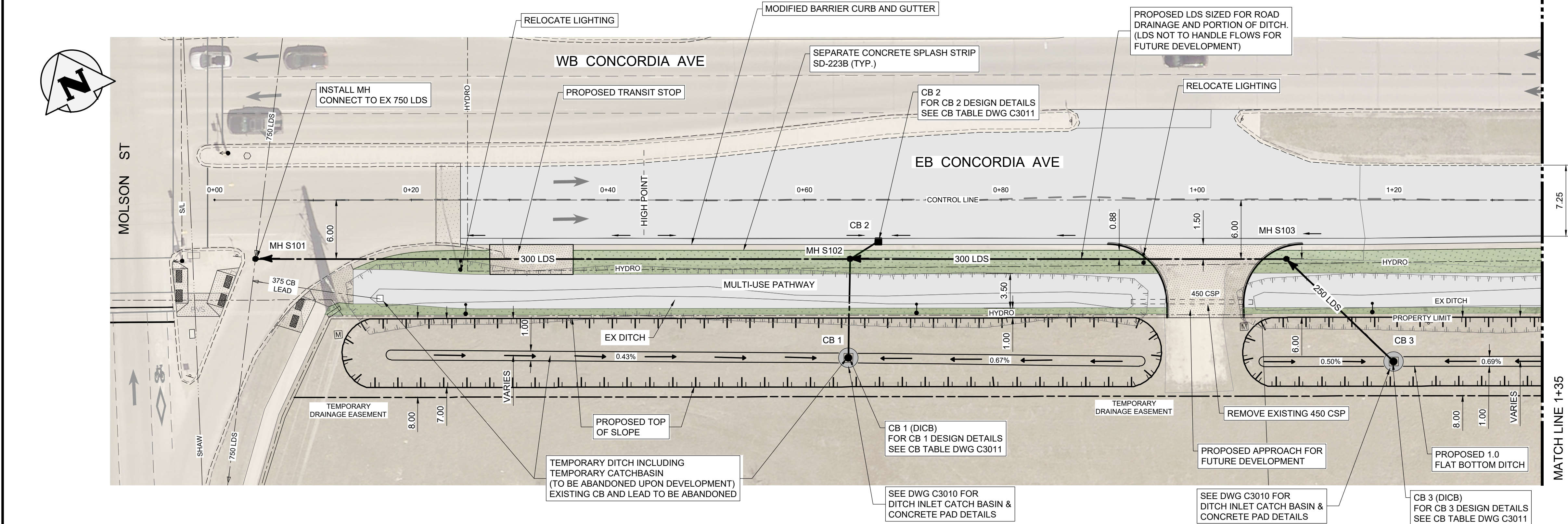
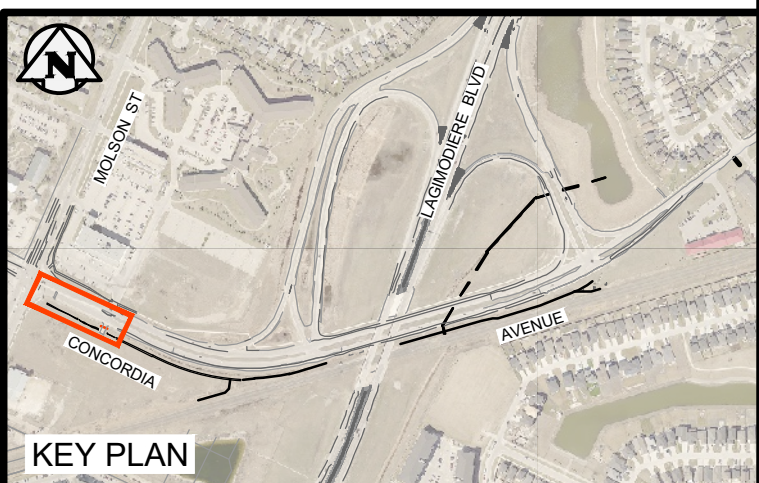

	HYDRANT		VALVE		MANHOLE		CATCH BASIN		CATCH PIT
	WATERMAIN		LAND DRAINAGE SEWER		WASTE WATER SEWER		HYDRO		BELLMTS
	GAS		GAS		GAS		GAS		GAS
EXISTING	LEGEND-PLAN	PROPOSED	EXISTING	LEGEND-PLAN	PROPOSED	EXISTING	LEGEND-PROFILE	PROPOSED	EXISTING

LOCATION APPROVED UNDERGROUND STRUCTURES	B.M. ELEV.
SUPV. U/G STRUCTURES COMMITTEE	DATE
NOTE: LOCATION OF UNDERGROUND STRUCTURES AS SHOWN ARE BASED ON THE BEST INFORMATION AVAILABLE BUT NO GUARANTEE IS GIVEN THAT ALL EXISTING UTILITIES ARE SHOWN OR THAT THE GIVEN LOCATIONS ARE EXACT. CONFIRMATION OF EXISTENCE AND EXACT LOCATION OF ALL SERVICES MUST BE OBTAINED FROM THE INDIVIDUAL UTILITIES BEFORE PROCEEDING WITH CONSTRUCTION.	

DESIGNED BY	REVIEWED BY
IJM	TRC
DRAWN BY	APPROVED BY
NL	KJM
SCALE:	DATE
HOR 1 : 250 VER 1 : 50	25.08.07
0 NO.	ISSUED FOR TENDER DATE
25.08.07	IJM
REVISIONS	DATE

DESIGNED BY	REVIEWED BY
IJM	TRC
DRAWN BY	APPROVED BY
NL	KJM
SCALE:	DATE
HOR 1 : 250 VER 1 : 50	25.08.07
0 NO.	ISSUED FOR TENDER DATE
25.08.07	IJM
REVISIONS	DATE

CONSULTANT DRAWING NO.
704-INF-MBI03007.01-DWG-C3001

THE CITY OF WINNIPEG PUBLIC WORKS DEPARTMENT ENGINEERING DIVISION	CITY DRAWING NUMBER
MAJOR REHABILITATION OF LAGIMODIERE TWIN OVERPASSES (OVER CONCORDIA AVE. & CPR KEEWATIN)	P123-25-3001
DRAINAGE WORKS LAND DRAINAGE SEWER & DITCH MOLSON ST TO 120m SE	SHEET 1 OF 14
	3001