

1 SOUTH STRUCTURAL SLAB REINFORCING - BOTTOM MAT
1 : 50
- BARRIER DWLS NOT SHOWN FOR CLARITY

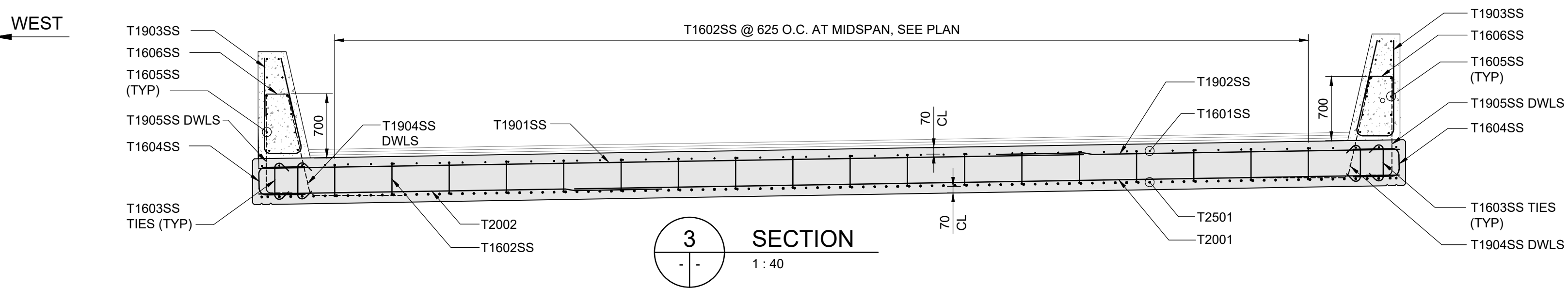

3 SECTION
1 : 40

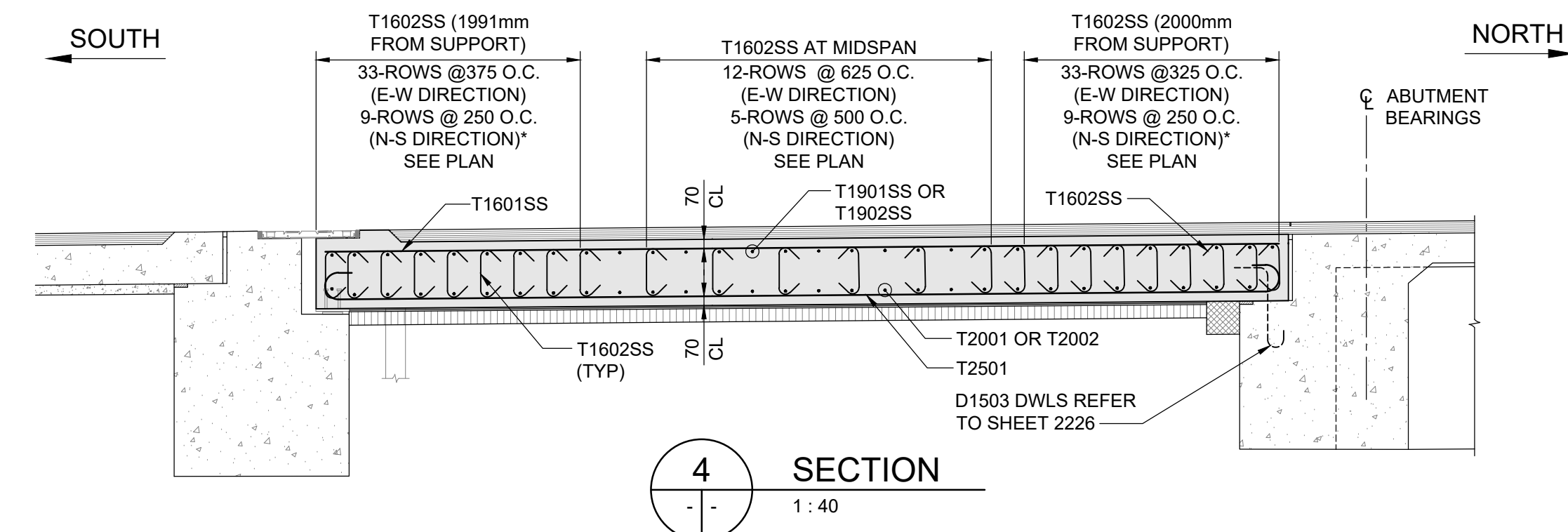

4 SECTION
1 : 40

NOTE:
* T1602SS TIES 2000mm FROM SUPPORT IN THE NORTH-SOUTH DIRECTION SHALL BE HOOKED IN EACH FULL WIDTH TRANSVERSE BARS (T1901SS OR T1902SS)

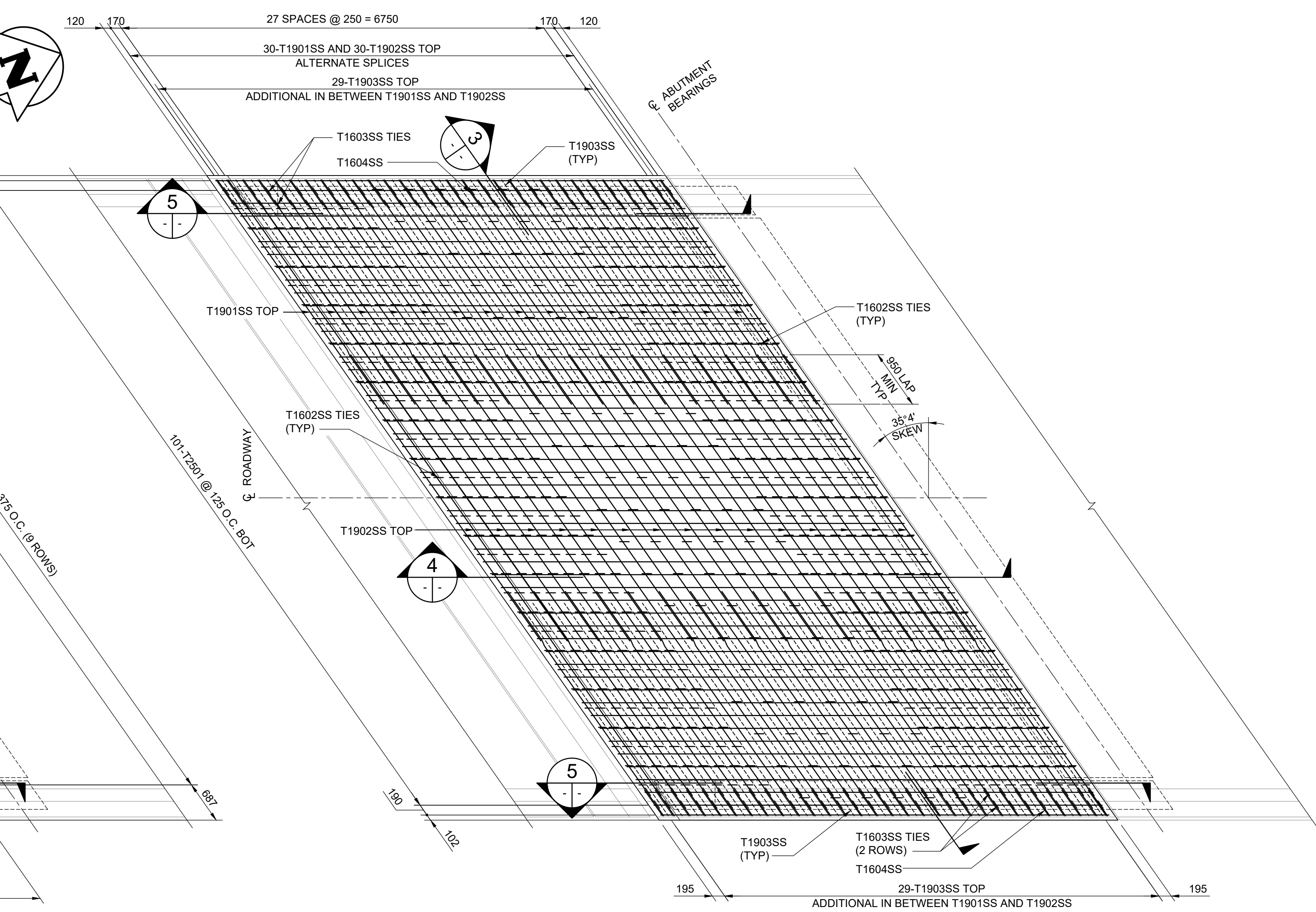

2 SOUTH STRUCTURAL SLAB REINFORCING - TOP MAT
1 : 50

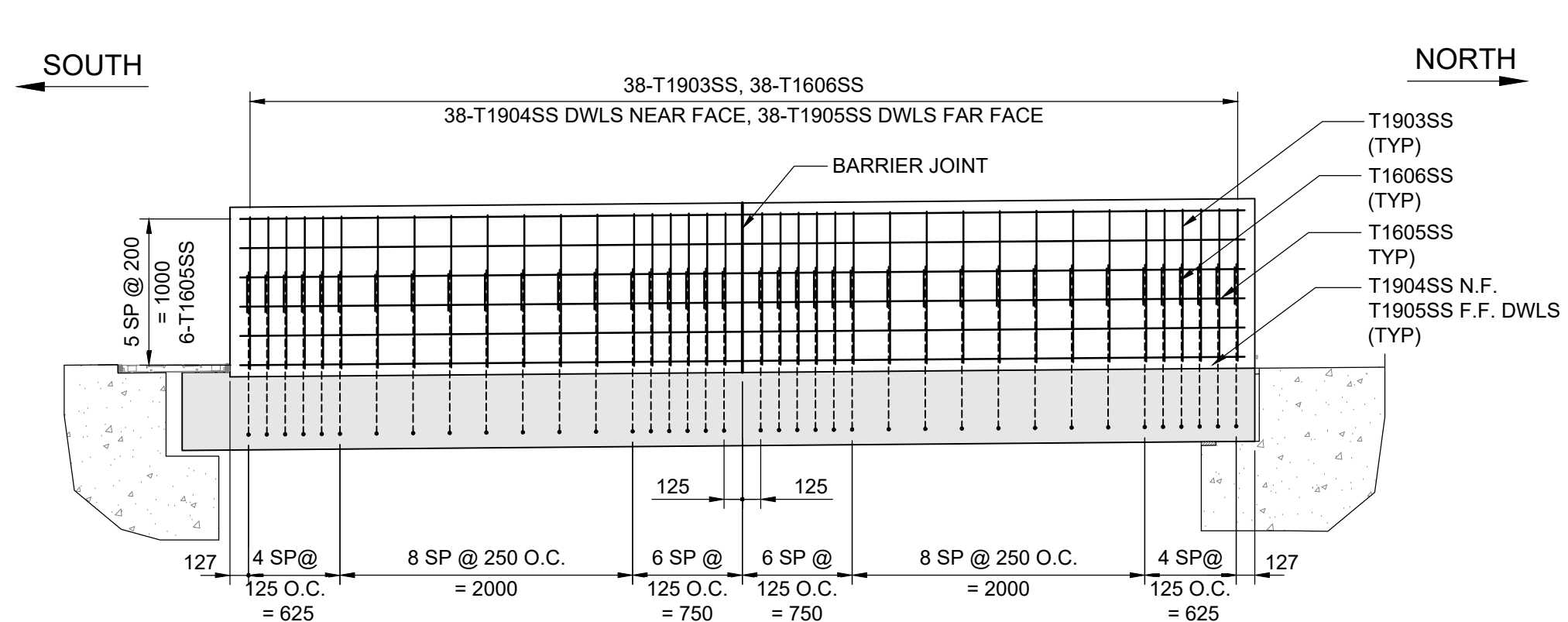

5 FRONT ELEVATION - BARRIER REINFORCING
1 : 40
- WEST TRAFFIC BARRIER AS SHOWN, EAST TRAFFIC BARRIER SIMILAR
- STRUCTURAL SLAB REINFORCING NT SHOWN

B.M. ELEV.			TETRA TECH		THE CITY OF WINNIPEG PUBLIC WORKS DEPARTMENT ENGINEERING DIVISION	
DESIGNED BY	TN	REVIEWED BY	SA	LAGIMODIERE TWIN OVERPASSES OVER CPKC KEEWATIN REHABILITATION AND RELATED WORKS		CITY DRAWING NUMBER B123-25-2232
DRAWN BY	GI	APPROVED BY	KA	NORTHBOUND STRUCTURE SOUTH APPROACH - STRUCTURAL SLAB REINFORCING DETAILS		SHEET OF 32 48
SCALE:	AS NOTED	ACCEPTED BY	DATE	CONSULTANT DRAWING NO. 704-INF-MBI03007.01-DWG-S2232		2232
0 ISSUED FOR TENDER	25.08.07	TN	CAM WARD, P.ENG. 25.08.07			
NO. REVISIONS	DATE	BY	DATE	25.08.07		