

**1 CONCRETE BARRIER - FRONT ELEVATION**  
1 : 100  
- WEST CONCRETE BARRIER REINFORCING AS SHOWN  
- EAST CONCRETE BARRIER REINFORCING SIMILAR

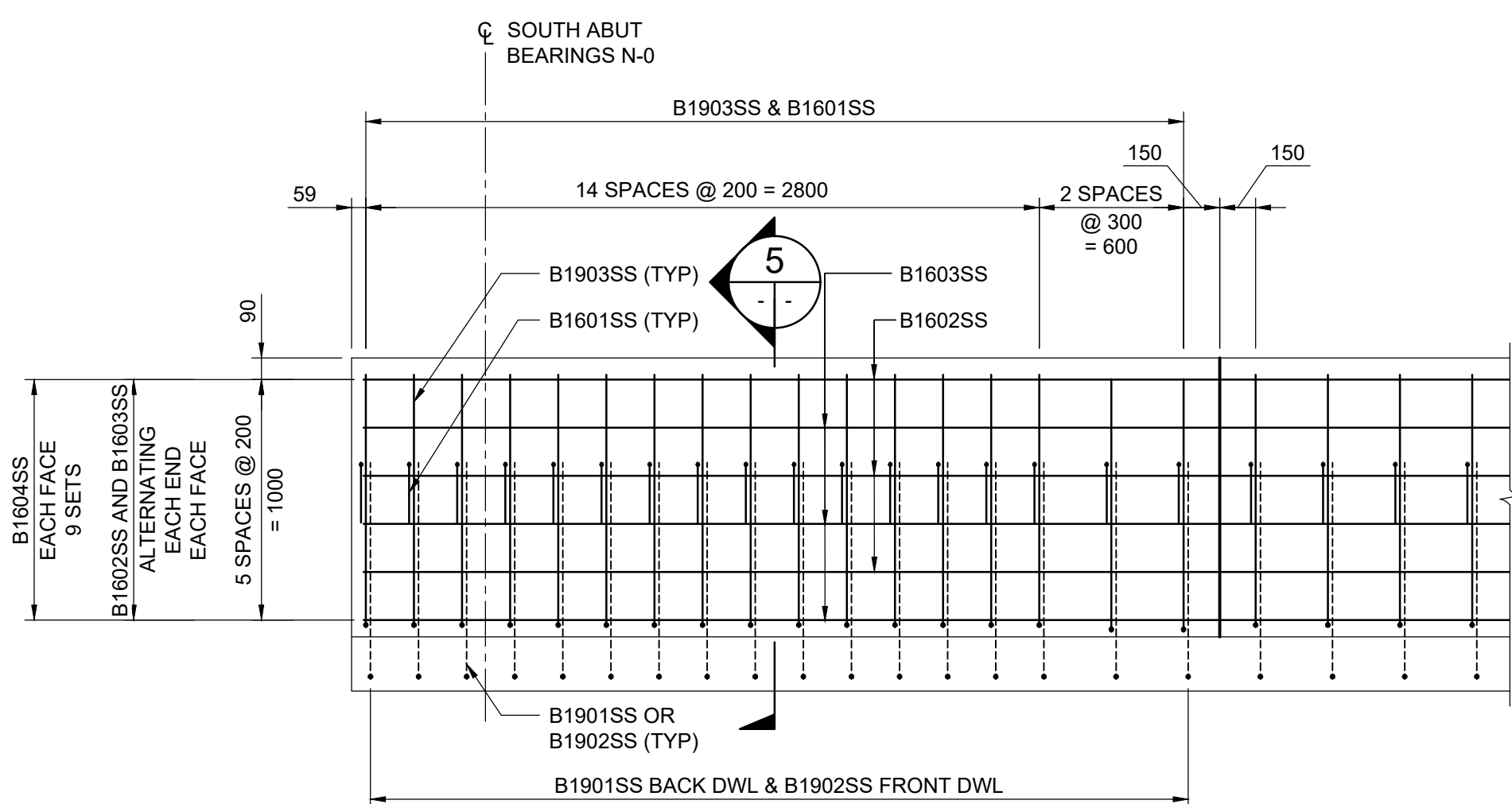

**2 BARRIER - END PANEL ELEVATION**  
1 : 25

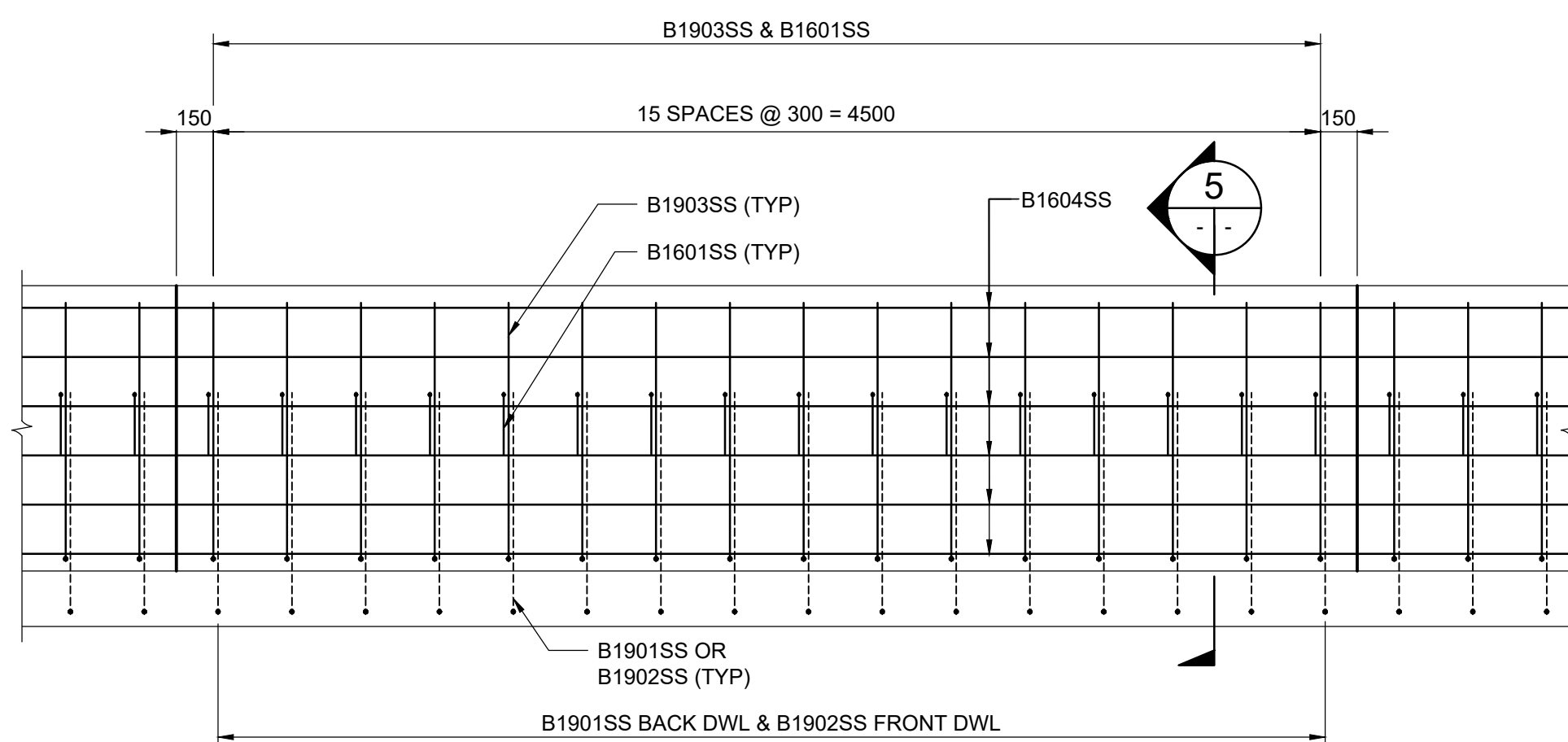

**3 BARRIER - INTERMEDIATE PANEL ELEVATION**  
1 : 25

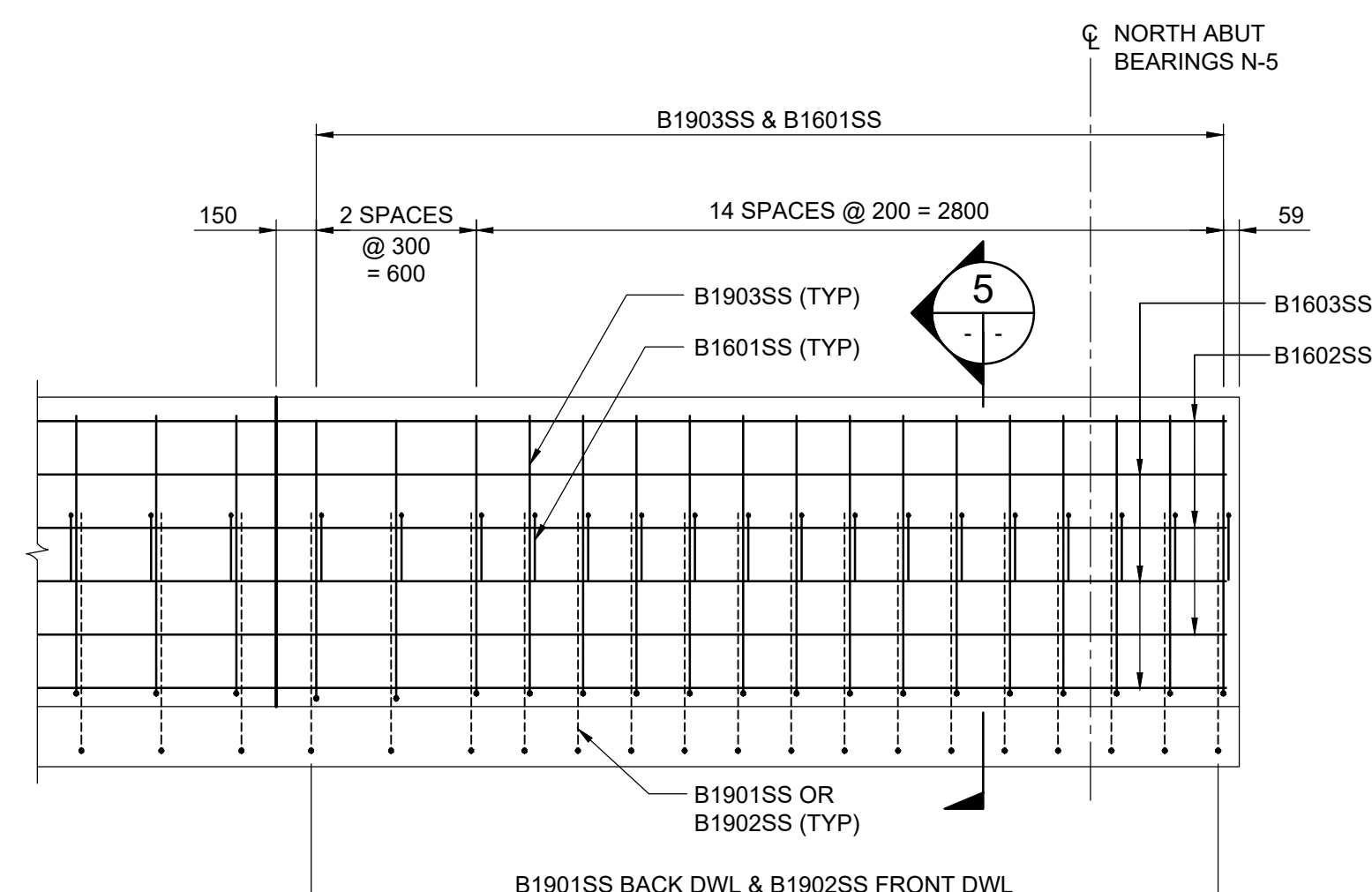

**4 BARRIER - END PANEL ELEVATION**  
1 : 25

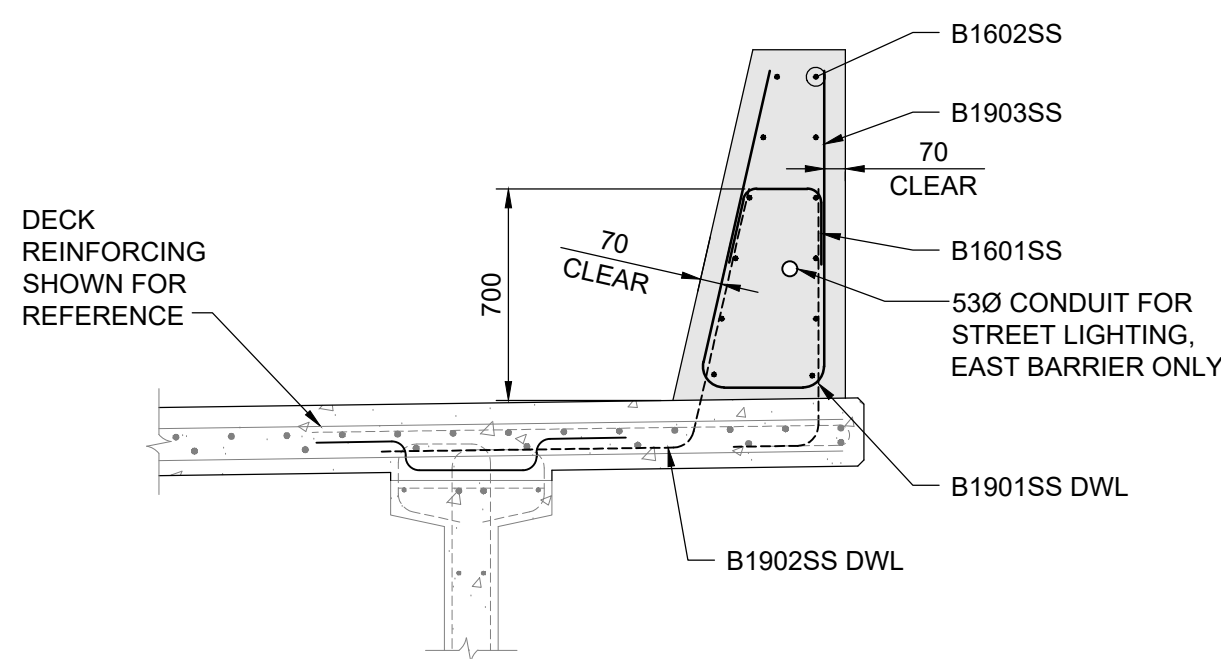

**5 SECTION**  
1 : 25



B.M. ELEV.				<b>Tt TETRA TECH</b>		CONSULTANT DRAWING NO. 704-INF-MBI03007.01-DWG-S2227	<b>THE CITY OF WINNIPEG</b> PUBLIC WORKS DEPARTMENT ENGINEERING DIVISION	
				DESIGNED BY TN	REVIEWED BY SA		LAGIMODIERE TWIN OVERPASSES OVER CPKC KEEWATIN REHABILITATION AND RELATED WORKS	
				DRAWN BY EV/GI	APPROVED BY KA		NORTHBOUND STRUCTURE DECK BARRIER REINFORCING DETAILS	
				SCALE: AS NOTED	ACCEPTED BY CAM WARD, P.ENG. DATE 25.08.07		SHEET 5 OF 5	
0	ISSUED FOR TENDER	25.08.07	TN	DATE 25.08.07			CITY DRAWING NUMBER B123-25-2227	
NO.	REVISIONS	DATE	BY	DATE			SHEET 27 OF 48	