

5

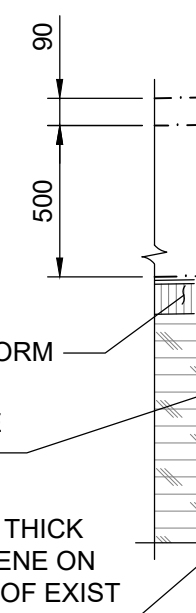

4



1. REFER SHEET 2115 FOR BEARING REPLACEMENT SEQUENCE FOR ABUTMENT AND PEDESTAL CONSTRUCTION STAGING.
2. ALL EXPOSED EDGES TO BE CHAMFERED 20mm UNLESS NOTED OTHERWISE.
3. ROUGHEN EXISTING ABUTMENT SURFACES IN CONTACT WITH WINGWALL EXTENSION, WINGWALL CAP AND ABUTMENT BEARING PEDESTAL AS PER ICRI GUIDELINE NO. 310.2R (MEDIUM SCARIFICATION) TO 6mm AMPLITUDE.



DESIGNED BY: R/

DRAWN BY EV

SCALE: AS NOTED

REVIEWED	SA
----------	----

APPROVED BY KA

ACCEPTED BY _____ DATE _____

CONSULTANT DRAWING NO.

704-INF.MBI03007.01-DWG-S2107



THE CITY OF WINNIPEG
PUBLIC WORKS DEPARTMENT
ENGINEERING DIVISION

LAGIMODIERE TWIN OVERPASSES OVER CPKC KEEWATIN REHABILITATION AND RELATED WORKS

SOUTHBOUND STRUCTURE
NORTH ABUTMENT S-5 - CONCRETE DETAILS

B123-25-2107

7 47

107