

C:\pwworking\director\projects\2024\dillon_40132\mbs87744\249227-CT-CON-WESTMOUNT.dwg

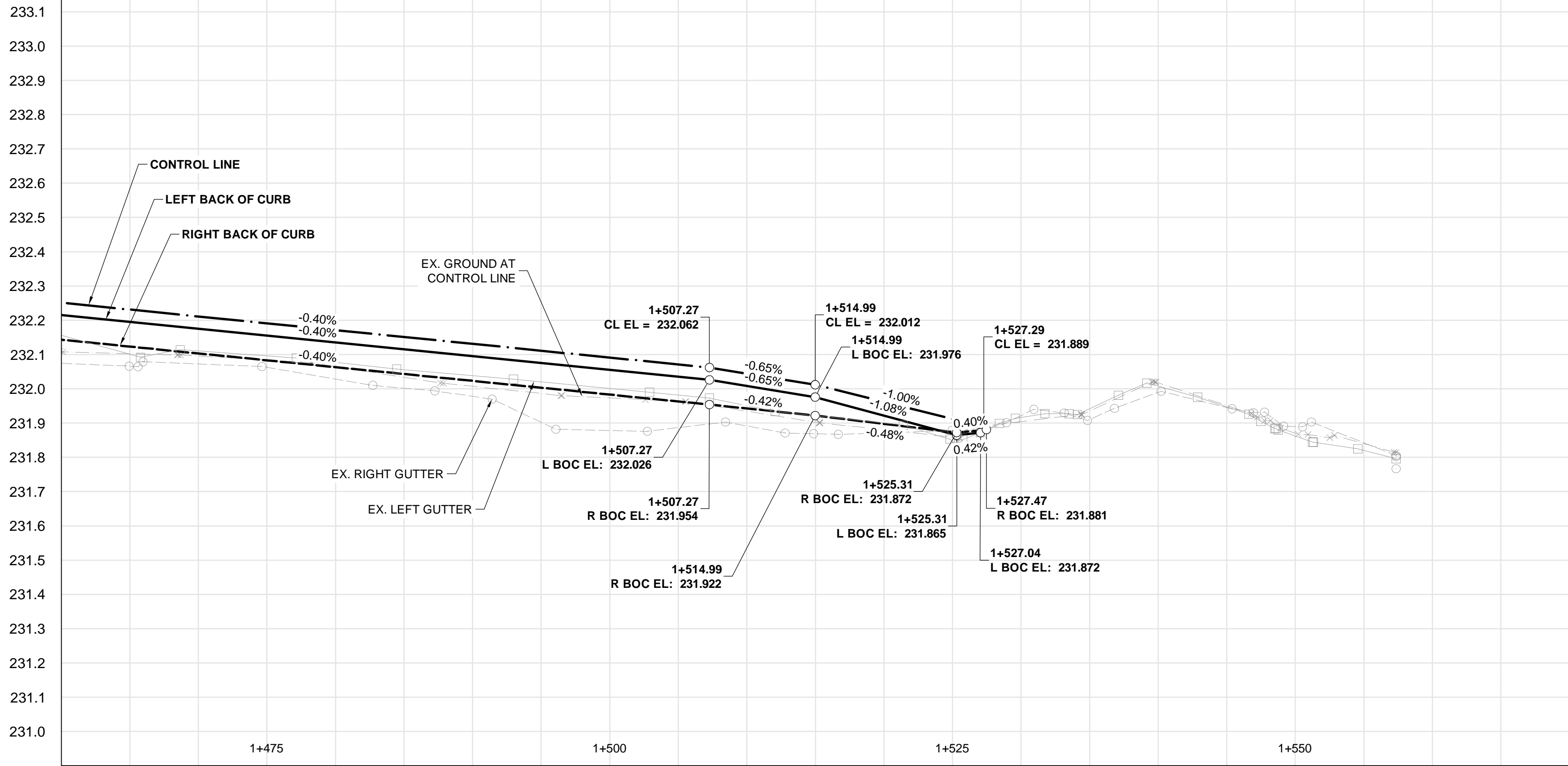

233.1
233.0
232.9
232.8
232.7
232.6
232.5
232.4
232.3
232.2
232.1
231.9
231.8
231.7
231.6
231.5
231.4
231.3
231.2
231.1
231.0

CONSTRUCTION NOTES:

- ALL WORK AND MATERIALS TO BE IN ACCORDANCE WITH LATEST REVISION OF THE CITY OF WINNIPEG STANDARD CONSTRUCTION SPECIFICATIONS.
- LEGAL PLAN AND UNDERGROUND INFORMATION FROM CITY OF WINNIPEG LBIS. CONTRACTOR TO VERIFY ALL UNDERGROUNDS IN THE FIELD.
- CONTRACTOR TO TAKE PRECAUTIONARY STEPS TO AVOID DAMAGE FROM CONSTRUCTION ACTIVITIES TO TREES WITHIN THE LIMITS OF CONSTRUCTION AS OUTLINED IN THE SPECIFICATIONS.
- LOCATION OF EXISTING SERVICES TO BE CONFIRMED IN THE FIELD BY THE CONTRACTOR.
- ALL DIMENSIONS ARE TO BACK OF CURB.
- LIMITS OF CURB AND SIDEWALK RECONSTRUCTION TO BE FINALIZED IN THE FIELD BY THE CONTRACT ADMINISTRATOR.
- ADJUST ALL WATER VALVES, MANHOLES, CATCH BASINS, CATCH PITS AND WATER SHUT OFF VALVES TO GRADE.
- ALL PRIVATE WALKWAYS TO BE ADJUSTED TO NEW SIDEWALK OR TOP OF CURB ELEVATION, AS REQUIRED.
- STREET LIGHT STANDARDS, HYDRO POLES AND ANCHORS THAT REQUIRE TEMPORARY SUPPORT, REMOVAL OR REPLACEMENT, ARE TO BE DONE AT THE EXPENSE OF THE CONTRACTOR, AS NECESSARY.
- FOR ROAD RECONSTRUCTIONS, ALL WATER MAIN SERVICES NEED TO BE INSULATED UNLESS NOTED OTHERWISE. ADDITIONALLY, ALL CATCH BASINS, MANHOLES AND LEAD PIPES LOCATED WITHIN 2.0 m OF A RESIDENTIAL SERVICE MUST BE INSULATED TO PROTECT THE SERVICE FROM POTENTIAL FUTURE FREEZING.
- CONSTRUCT MODIFIED BARRIER CURB (SD-203B) AT ALL INTERSECTION RADII AND ALLEY RADII.
- CONTRACTOR TO OVERLAY DRIVEWAYS TO ENSURE POSITIVE DRAINAGE TO NEW STREET GRADES. FINAL LIMITS TO BE DETERMINED IN THE FIELD BY CONTRACT ADMINISTRATOR.
- REFER TO TENDER FOR DETAILS REGARDING TRAFFIC MANAGEMENT.

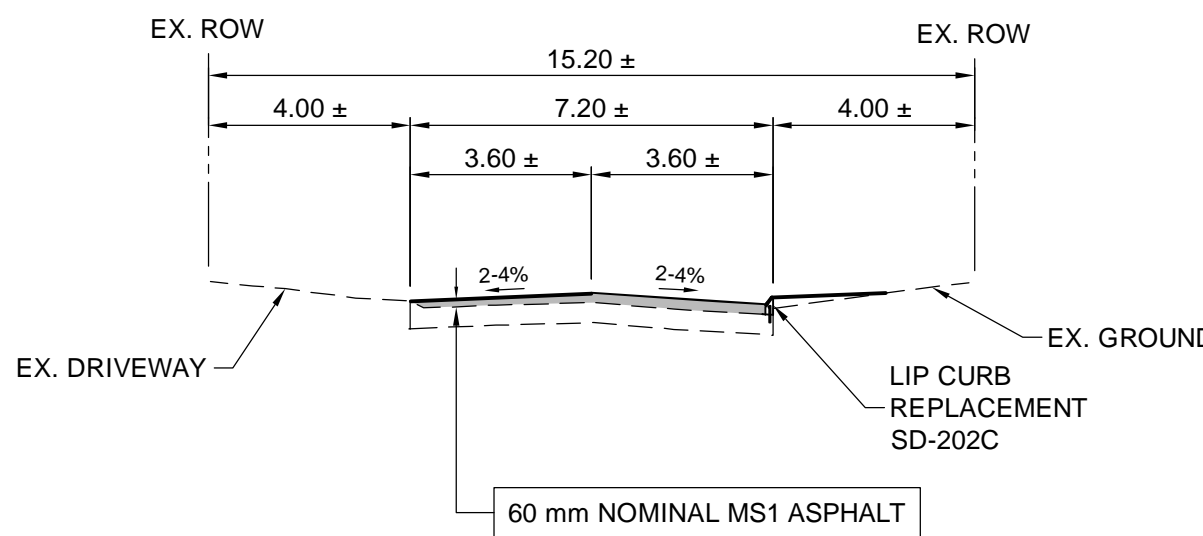
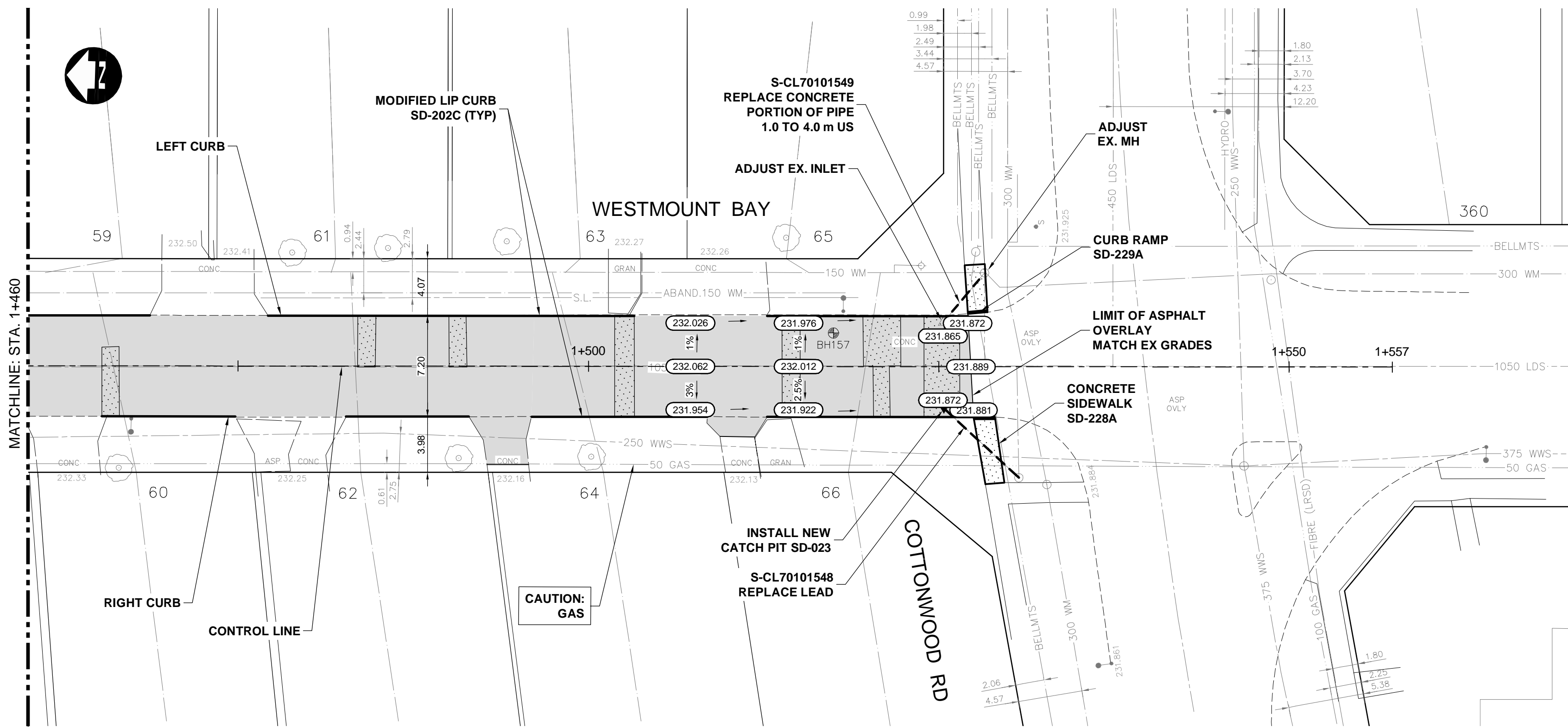

TYPICAL WESTMOUNT SECTION
SCALE: H=1:150, V=1:75

METRIC

WHOLE NUMBERS INDICATE MILLIMETRES
DECIMALIZED NUMBERS INDICATE METRES

	HYDRANT		150 WM	WATERMAIN	150 WM	CONCRETE ROAD	
	VALVE		300 LDS	LAND DRAINAGE SEWER	300 LDS	ASPHALT ROAD	
	CURB STOP		250 WWS	WASTE WATER SEWER	250 WWS	CONC ROAD W/ASP OVERLAY	
	LIGHT STANDARD		HYDRO	HYDRO	HYDRO	CONCRETE SIDEWALK	
	HYDRO POLE		BELLMTS	BELLMTS	BELLMTS	ASPHALT PATH	
	TREE		100 GAS	GAS	100 GAS	PAVEMENT REPAIR FABRIC	
	GEODETIC BENCH MARK		T.S.	TRAFFIC SIGNALS	T.S.	GRASS/SOD	
	SURVEY BAR		S.L.	STREET LIGHTS	S.L.	ELEVATION	
	MANHOLE			TRAFFIC SIGNAL POLE		PROPERTY LINE	
	CATCH BASIN			PAVING STONE		CURB RAMP	
	CATCH PIT			CURB RENEWAL		DETECTABLE TILE	
EXISTING	LEGEND-PLAN	PROPOSED	EXISTING	LEGEND-PLAN	PROPOSED	EXISTING	LEGEND-PLAN

UNDERGROUND STRUCTURES

SUPV. U/G STRUCTURES DATE

LOCATION OF UNDERGROUND STRUCTURES AS SHOWN ARE BASED ON THE BEST INFORMATION AVAILABLE, BUT NO GUARANTEE IS GIVEN THAT ALL EXISTING UTILITIES ARE SHOWN OR THAT THE GIVEN LOCATIONS ARE EXACT. CONFIRMATION OF EXISTENCE AND EXACT LOCATION OF ALL SERVICES MUST BE OBTAINED FROM THE INDIVIDUAL UTILITIES BEFORE PROCEEDING WITH CONSTRUCTION.

B.M. ELEV.

0 ISSUED FOR TENDER 25/03/25 LAS

DESIGNED BY TJH

DRAWN BY TJH

CHECKED BY LAS

APPROVED BY TJP

HOR. SCALE 1:250

VERTICAL 1:10



RELEASED FOR CONSTRUCTION

DATE

ENGINEER'S SEAL



CONSULTANT PROJECT NUMBER 24-9227



THE CITY OF WINNIPEG
PUBLIC WORKS DEPARTMENT

2025 RESIDENTIAL STREETS RENEWAL PROGRAM
CROMWELL STREET AND VARIOUS OTHER LOCATIONS

WESTMOUNT BAY (STA.
1+460 TO END)

CITY DRAWING NUMBER

SHEET 28 OF 33

CONSULTANT DRAWING NUMBER