

Mar 27, 2025 — 6:14pm
P:\2024\CA0043424.6934 - CA-25-R-04 Local Streets\02 Drawings\03 Work_Dwg CA0043424.6934_CA_25-R-04_Marshall_Plan&Profile.dwg - tab: 230 - 2025_Drawing_CA0043424.6934-23-R0

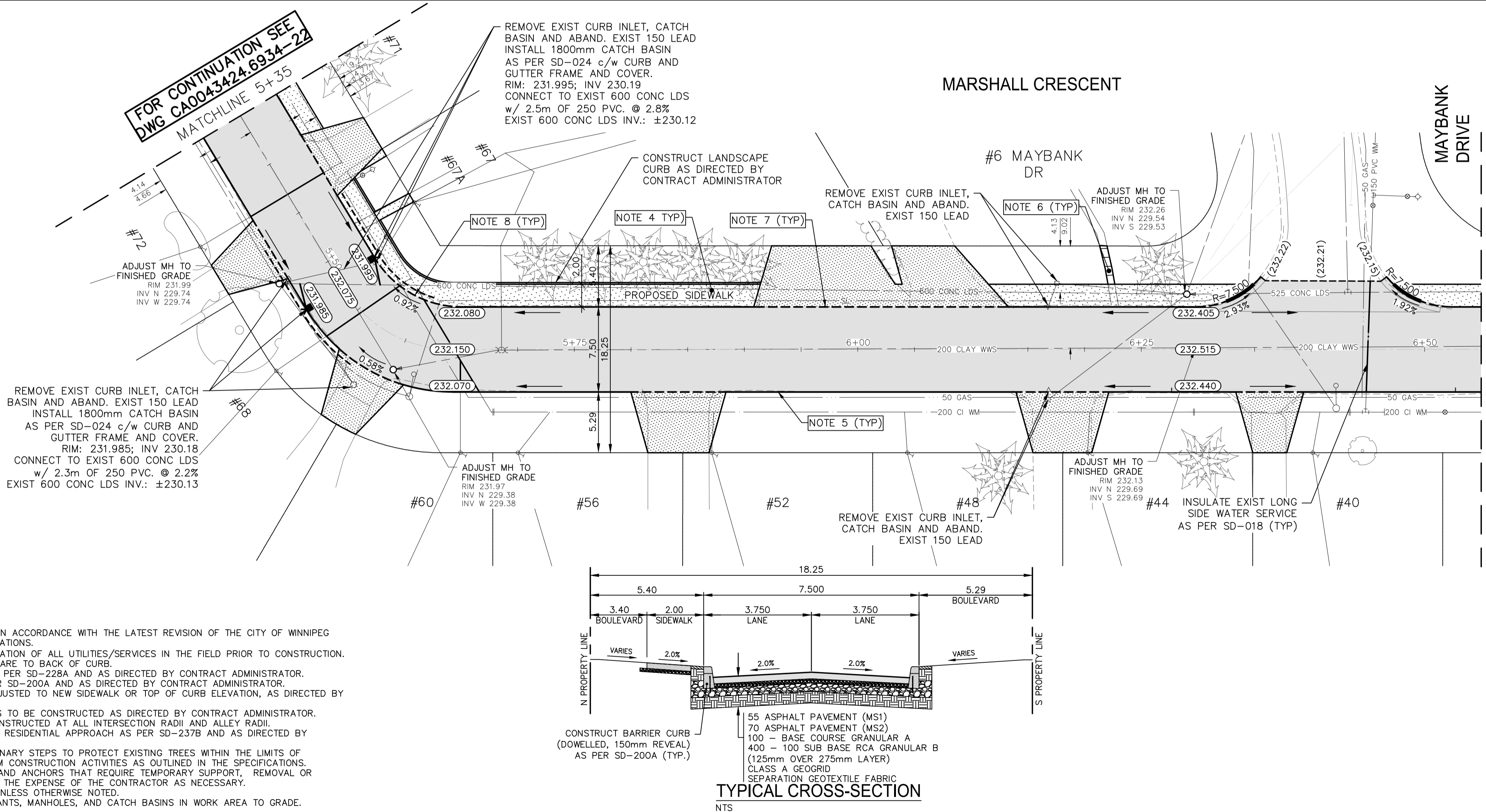
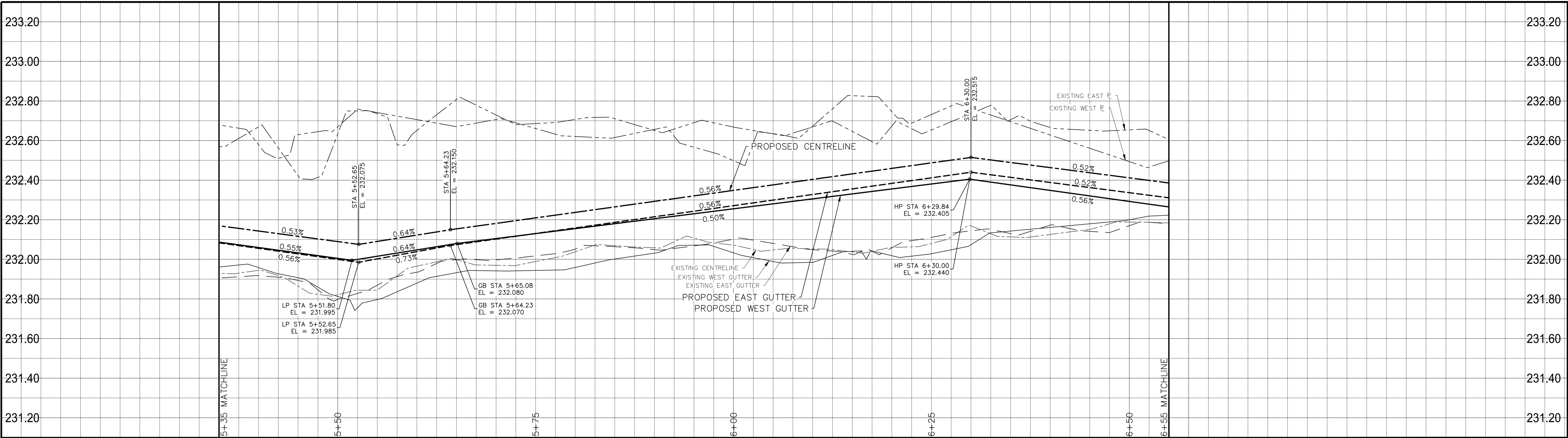

- NOTES:
- ALL WORK AND MATERIALS TO BE IN ACCORDANCE WITH THE LATEST REVISION OF THE CITY OF WINNIPEG STANDARD CONSTRUCTION SPECIFICATIONS.
 - CONTRACTOR TO CONFIRM THE LOCATION OF ALL UTILITIES/SERVICES IN THE FIELD PRIOR TO CONSTRUCTION.
 - ALL ROADWAY DIMENSIONS SHOWN ARE TO BACK OF CURB.
 - SIDEWALK TO BE CONSTRUCTED AS PER SD-228A AND AS DIRECTED BY CONTRACT ADMINISTRATOR.
 - CURB TO BE CONSTRUCTED AS PER SD-200A AND AS DIRECTED BY CONTRACT ADMINISTRATOR.
 - ALL PRIVATE WALKWAYS TO BE ADJUSTED TO NEW SIDEWALK OR TOP OF CURB ELEVATION, AS DIRECTED BY THE CONTRACT ADMINISTRATOR.
 - LIP CURB AT PRIVATE APPROACHES TO BE CONSTRUCTED AS DIRECTED BY CONTRACT ADMINISTRATOR.
 - MODIFIED BARRIER CURB TO BE CONSTRUCTED AT ALL INTERSECTION RADII AND ALLEY RADII.
 - CONSTRUCT REINFORCED CONCRETE RESIDENTIAL APPROACH AS PER SD-237B AND AS DIRECTED BY CONTRACT ADMINISTRATOR.
 - CONTRACTORS TO TAKE PRECAUTIONARY STEPS TO PROTECT EXISTING TREES WITHIN THE LIMITS OF CONSTRUCTION FROM DAMAGE FROM CONSTRUCTION ACTIVITIES AS OUTLINED IN THE SPECIFICATIONS.
 - LAMP STANDARDS, HYDRO POLES, AND ANCHORS THAT REQUIRE TEMPORARY SUPPORT, REMOVAL OR REPLACEMENT, TO BE DONE SO AT THE EXPENSE OF THE CONTRACTOR AS NECESSARY.
 - ALL BOULEVARDS TO BE SODDED UNLESS OTHERWISE NOTED.
 - ADJUST ALL WATER VALVES, HYDRANTS, MANHOLES, AND CATCH BASINS IN WORK AREA TO GRADE.

---	WATER MAIN	---	⊗	---	VALVE	---	⊗
---	LAND DRAINAGE SEWER	---	⊗	---	CURB STOP	---	⊗
---	WASTE WATER SEWER	---	---	---	HYDRO POLE & LIGHT STANDARD	---	---
---	HYDRO	---	⊗	---	LIGHT STANDARD OR TRAFFIC SIGNAL	---	---
---	GAS	---	⊗	---	HYDRO POLE / ANCHOR	---	---
---	COMMUNICATIONS	---	⊗	---	FENCE	---	---
---	SIGNALS	---	⊗	---	PROPERTY LINE	---	---
○	MANHOLE	●	⊗	---	IRON BAR	---	---
□	CATCH BASIN/CATCH PIT	■	⊗	---	TEST HOLE / PAVEMENT CORE	---	---
△	CURB INLET	▼	(231.00)	---	ELEVATIONS	---	(231.000)
---	UTILITIES ADJUSTED	△ □ ○	---	---	CURB RAMP	---	---
◇	HYDRANT	◆	---	---	DETECTABLE WARNING SURFACE TILE	---	---
EXISTING	LEGEND-PLAN	PROPOSED	EXISTING	LEGEND-PLAN	PROPOSED	EXISTING	LEGEND-PLAN

LOCATIONS APPROVED UNDERGROUND STRUCTURES		G.B.M. TOH AT SW CORNER OF MARSHALL CR AND WALLER AVE INTERSECTION		
		ELEV. 233.193		
SIGNED BY:				
SUP/V U/G STRUCTURES		DATE		
LOCATION OF UNDERGROUND STRUCTURES AS SHOWN ARE BASED ON THE BEST INFORMATION AVAILABLE BUT NO GUARANTEE IS GIVEN THAT ALL EXISTING UTILITIES ARE SHOWN OR THAT THE GIVEN LOCATIONS ARE EXACT CONFIRMATION OF EXISTENCE AND EXACT LOCATION OF ALL SERVICES MUST BE OBTAINED FROM THE INDIVIDUAL UTILITIES BEFORE PROCEEDING		H		
		G		
		E		
		D		
		C		
		B		
		A	ISSUED FOR TENDER	
		NO.	REVISIONS	202503/21
				DATE