

Mar 27, 2025 — 6:09pm
P:\2024\CA0043424.6934 - CA-25-R-04 Local Streets\02 Drawings\03_Works_Dwg_CAO043424.6934_CA_25-R-04_Marshall_Plan&Profile.dwg - tab: 230-2025_Drawing_CAO043424.6934-20-RO

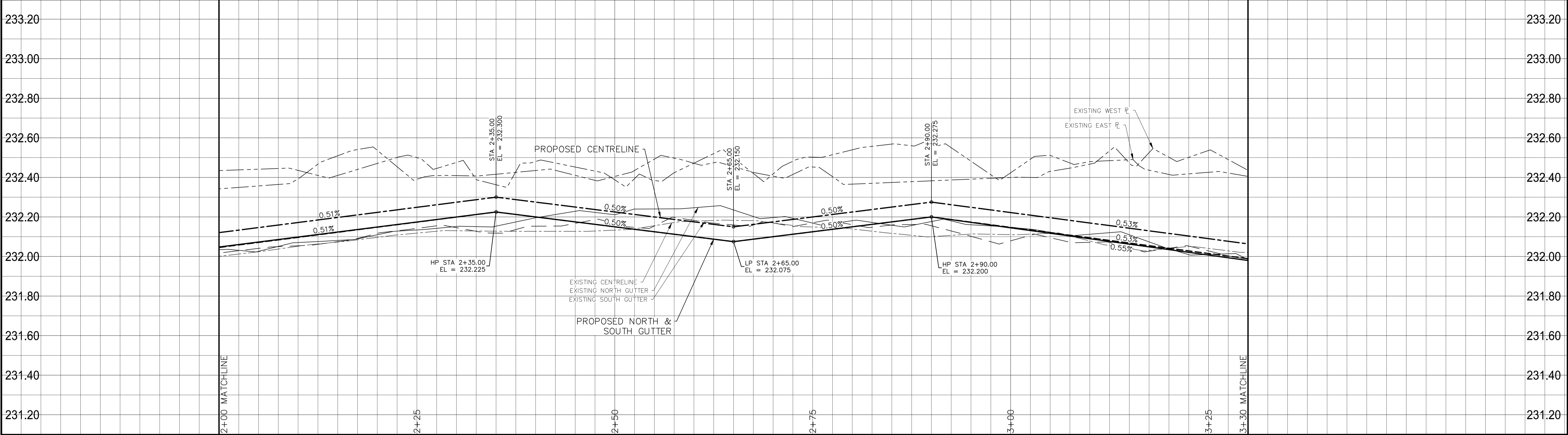

MARSHALL CRESCENT

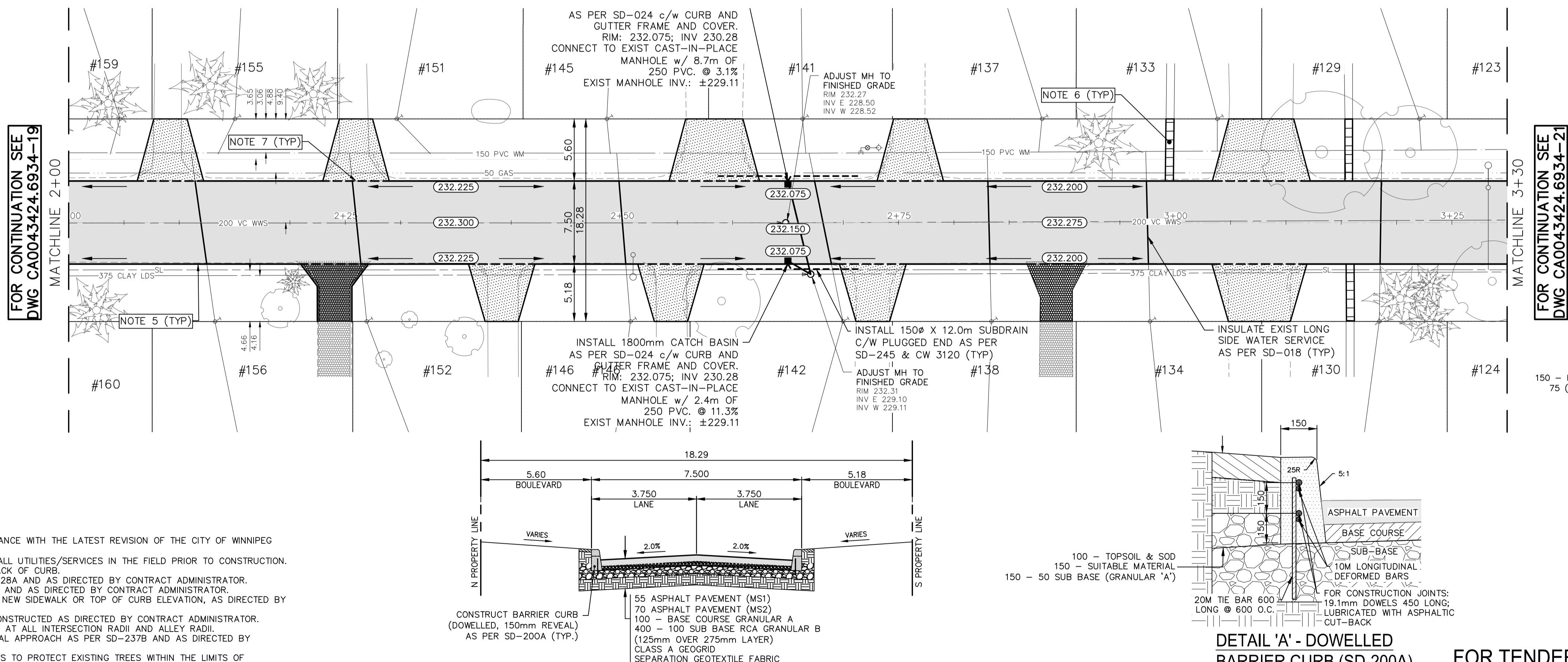

- NOTES:
- ALL WORK AND MATERIALS TO BE IN ACCORDANCE WITH THE LATEST REVISION OF THE CITY OF WINNIPEG STANDARD CONSTRUCTION SPECIFICATIONS.
 - CONTRACTOR TO CONFIRM THE LOCATION OF ALL UTILITIES/SERVICES IN THE FIELD PRIOR TO CONSTRUCTION.
 - ALL ROADWAY DIMENSIONS SHOWN ARE TO BACK OF CURB.
 - SIDEWALK TO BE CONSTRUCTED AS PER SD-228A AND AS DIRECTED BY CONTRACT ADMINISTRATOR.
 - CURB TO BE CONSTRUCTED AS PER SD-200A AND AS DIRECTED BY CONTRACT ADMINISTRATOR.
 - ALL PRIVATE WALKWAYS TO BE ADJUSTED TO NEW SIDEWALK OR TOP OF CURB ELEVATION, AS DIRECTED BY THE CONTRACT ADMINISTRATOR.
 - LIP CURB AT PRIVATE APPROACHES TO BE CONSTRUCTED AS DIRECTED BY CONTRACT ADMINISTRATOR.
 - MODIFIED BARRIER CURB TO BE CONSTRUCTED AT ALL INTERSECTION RADII AND ALLEY RADII.
 - CONSTRUCT REINFORCED CONCRETE RESIDENTIAL APPROACH AS PER SD-237B AND AS DIRECTED BY CONTRACT ADMINISTRATOR.
 - CONTRACTORS TO TAKE PRECAUTIONARY STEPS TO PROTECT EXISTING TREES WITHIN THE LIMITS OF CONSTRUCTION FROM DAMAGE FROM CONSTRUCTION ACTIVITIES AS OUTLINED IN THE SPECIFICATIONS.
 - LAMP STANDARDS, HYDRO POLES, AND ANCHORS THAT REQUIRE TEMPORARY SUPPORT, REMOVAL OR REPLACEMENT, TO BE DONE SO AT THE EXPENSE OF THE CONTRACTOR AS NECESSARY.
 - ALL BOULEVARDS TO BE SODDED UNLESS OTHERWISE NOTED.
 - ADJUST ALL WATER VALVES, HYDRANTS, MANHOLES, AND CATCH BASINS IN WORK AREA TO GRADE.

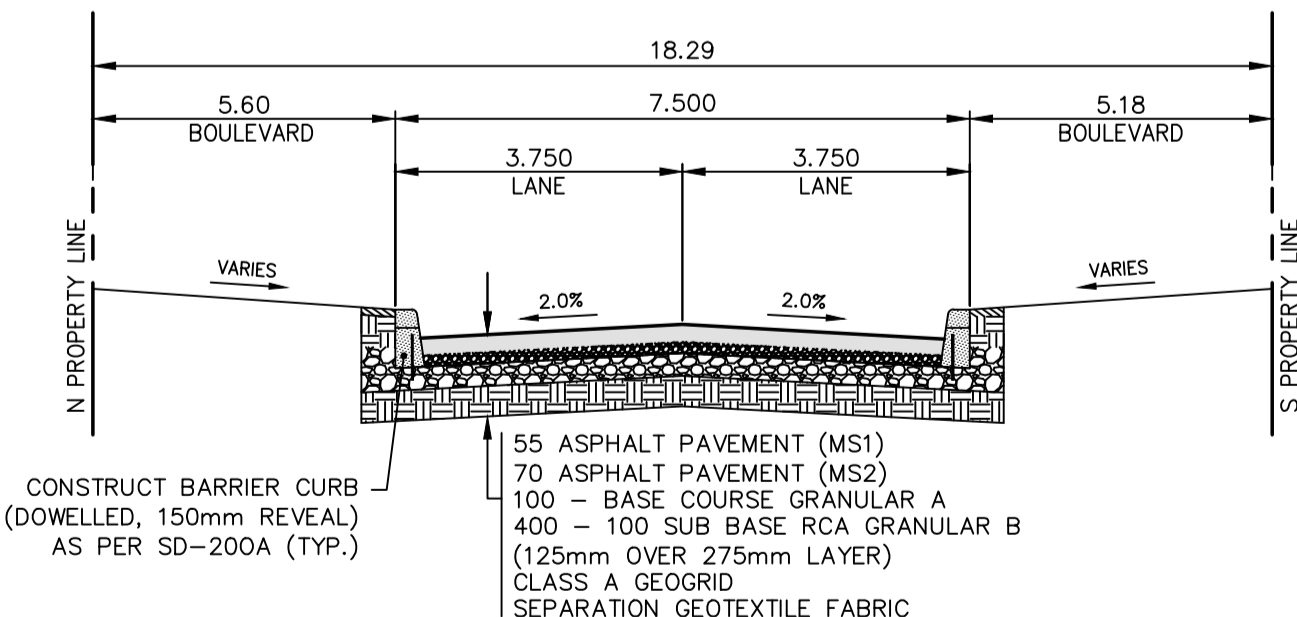

TYPICAL CROSS-SECTION

NTS

LOCATIONS APPROVED UNDERGROUND STRUCTURES

SIGNED BY: SUPV UG STRUCTURES DATE

LOCATION OF UNDERGROUND STRUCTURES AS SHOWN ARE BASED ON THE BEST INFORMATION AVAILABLE BUT NO GUARANTEE IS GIVEN THAT ALL EXISTING UTILITIES ARE SHOWN OR THAT THE GIVEN LOCATIONS ARE EXACT CONFIRMATION OF EXISTENCE AND EXACT LOCATION OF ALL SERVICES MUST BE OBTAINED FROM THE INDIVIDUAL UTILITIES BEFORE PROCEEDING

G.B.M. TOH AT SW CORNER OF MARSHALL CR AND WALLER AVE INTERSECTION
ELEV. 233.193

H
G
F
E
D
C
B
A

ISSUED FOR TENDER 2025/09/21 R.H.

NO. REVISIONS DATE BY

DESIGNED BY R.H./G.Z.
CHECKED BY R.H.
DRAWN BY K.C./W.D.
APPROVED BY S.M.

HOR. SCALE 1:250
VERTICAL 1:10

RELEASED FOR CONSTRUCTION JANUARY 2025

DETAIL 'A' - DOWELLED BARRIER CURB (SD-200A)

NTS

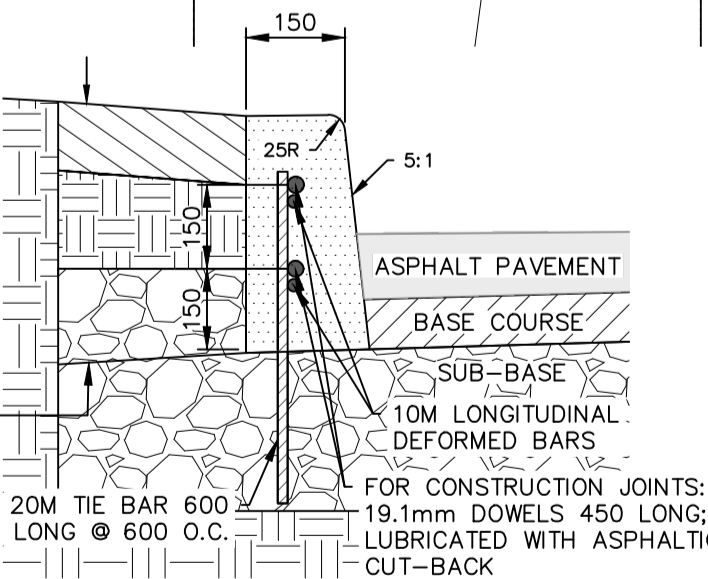

FOR TENDER PURPOSES ONLY

NOT FOR CONSTRUCTION

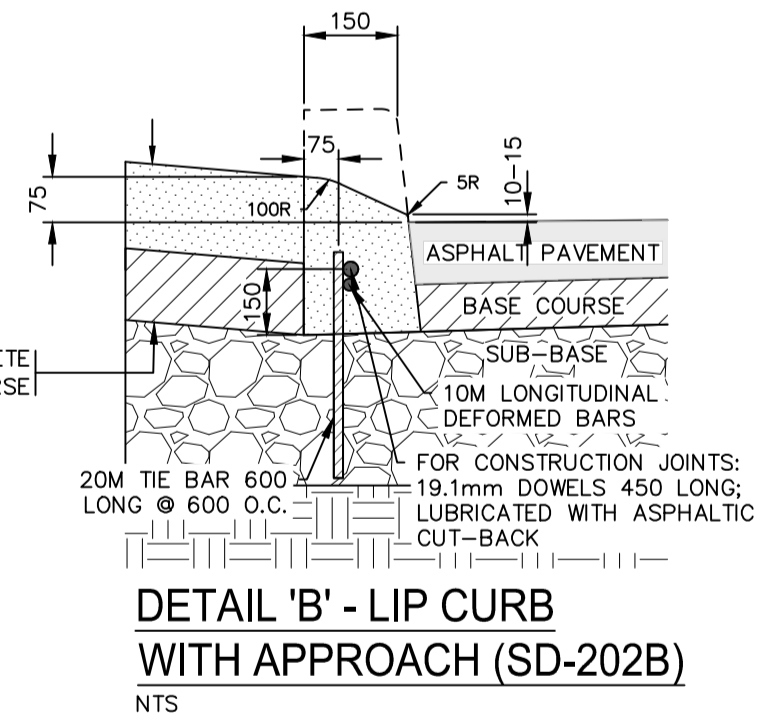

DETAIL 'B' - LIP CURB WITH APPROACH (SD-202B)

NTS

METRIC

WHOLE NUMBERS INDICATE MILLIMETRES
DECIMALIZED NUMBERS INDICATE METRES

ENGINEERS
GEOSCIENTISTS
MANITOBA
Certificate of Authorization
WSP Canada Inc.
No. 5750



THE CITY OF WINNIPEG
PUBLIC WORKS DEPARTMENT
ENGINEERING SERVICES DIVISION

2025 LOCAL STREET RENEWALS

MARSHALL CRESCENT

ASPHALT RECONSTRUCTION
STA. 2+00 TO STA. 3+30

CITY DRAWING NUMBER

SHEET 20 OF 47

TENDER NO.
230-2025