

Mar 21, 2025 - 10:40am  
P:\2024\CA0043424.6934 - CA-25-R-04 Local Streets\02 Drawings\03\_Work\_Dwg\CA0043424.6934\_CA\_25-R-04\_Howard\_Clarance\_Alley\_Plan&Profile.dwg -Tab:227-2025\_CA0043424.6934\_52-RC

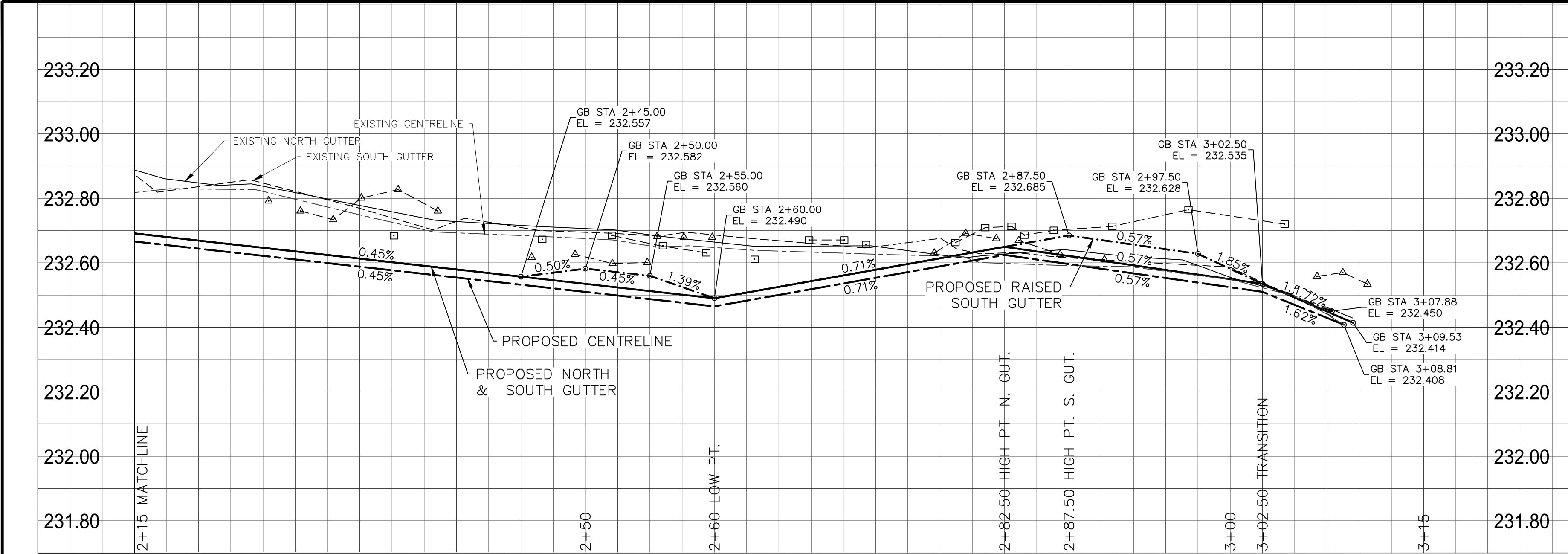

ALLEY PAVEMENT PROFILE  
SCALE: 1:250 HOR  
1:10 VER

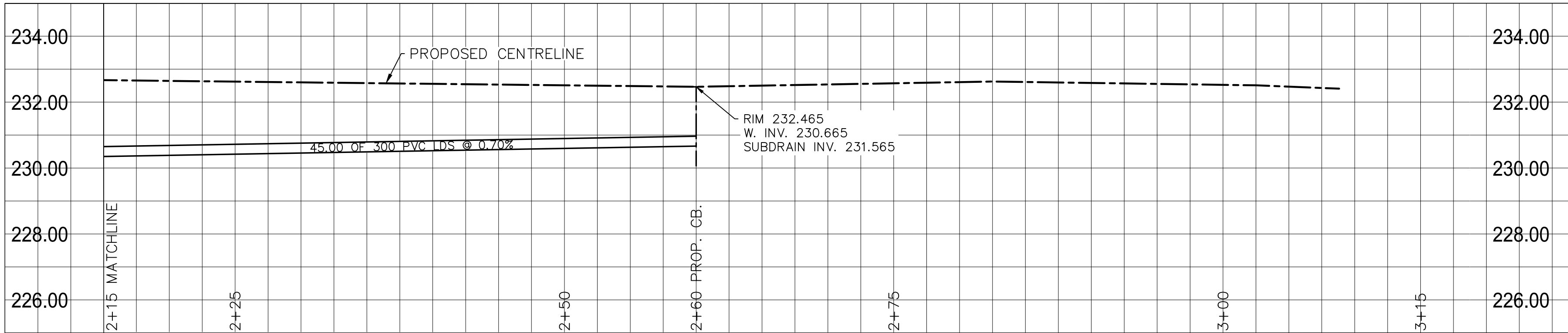

LAND DRAINAGE SEWER PROFILE  
SCALE: 1:250 HOR  
1:100 VER

← PHASE 1 | PHASE 2 →  
CONSTRUCTION | CONSTRUCTION

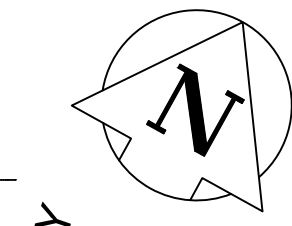
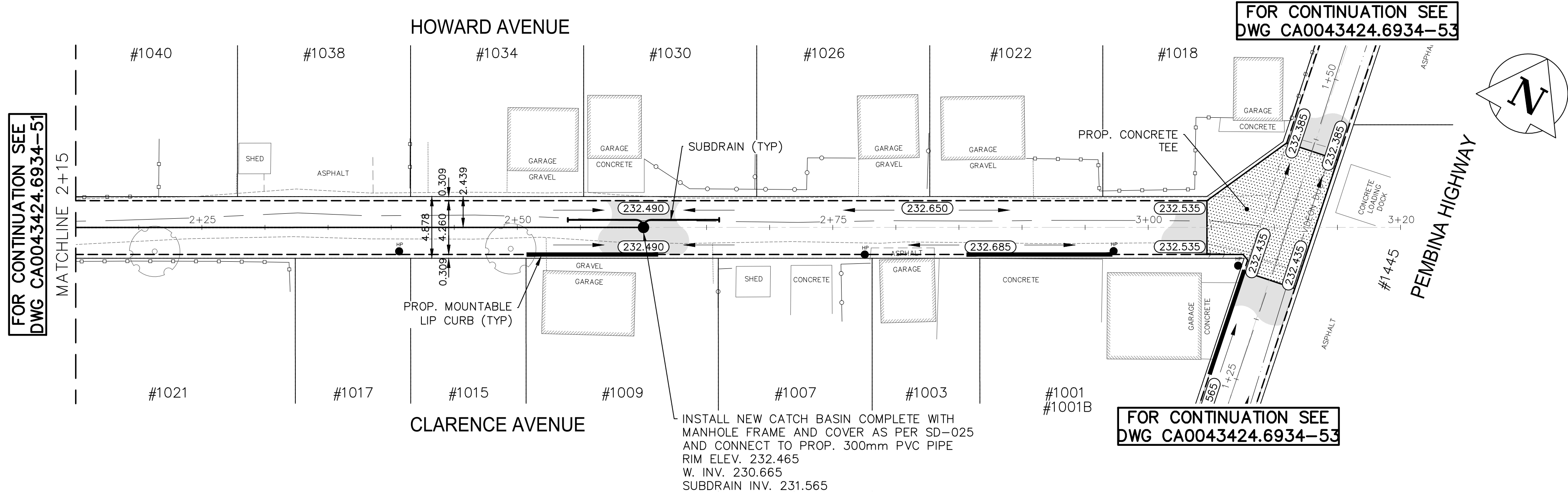

|          |             |          |          |                                  |          |          |             |          |
|----------|-------------|----------|----------|----------------------------------|----------|----------|-------------|----------|
|          |             |          |          | NORTH/WEST GARAGE APPROACH       |          |          |             |          |
|          |             |          |          | SOUTH/EAST GARAGE APPROACH       |          |          |             |          |
|          |             |          |          | VALVE                            |          |          |             |          |
|          |             |          |          | CURB STOP                        |          |          |             |          |
|          |             |          |          | HYDRO POLE & LIGHT STANDARD      |          |          |             |          |
|          |             |          |          | LIGHT STANDARD OR TRAFFIC SIGNAL |          |          |             |          |
|          |             |          |          | HYDRO POLE / ANCHOR              |          |          |             |          |
|          |             |          |          | FENCE                            |          |          |             |          |
|          |             |          |          | PROPERTY LINE                    |          |          |             |          |
|          |             |          |          | TEST HOLE / PAVEMENT CORE        |          |          |             |          |
|          |             |          |          | ELEVATIONS                       |          |          |             |          |
|          |             |          |          | CURB RAMP                        |          |          |             |          |
|          |             |          |          | DETECTABLE WARNING SURFACE TILE  |          |          |             |          |
| EXISTING | LEGEND-PLAN | PROPOSED | EXISTING | LEGEND-PLAN                      | PROPOSED | EXISTING | LEGEND-PLAN | PROPOSED |

LOCATIONS APPROVED  
UNDERGROUND STRUCTURES

SIGNED BY: \_\_\_\_\_ DATE: \_\_\_\_\_  
SUPV U/G STRUCTURES

LOCATION OF UNDERGROUND STRUCTURES AS SHOWN ARE BASED ON THE BEST INFORMATION AVAILABLE BUT NO GUARANTEE IS GIVEN THAT ALL EXISTING UTILITIES ARE SHOWN OR THAT THE GIVEN LOCATIONS ARE EXACT CONFIRMATION OF EXISTENCE AND EXACT LOCATION OF ALL SERVICES MUST BE OBTAINED FROM THE INDIVIDUAL UTILITIES BEFORE PROCEEDING

|        |                                      |
|--------|--------------------------------------|
| G.B.M. | TOH IN FRONT OF HOUSE 341 HUDSON ST. |
| ELEV.  | 232.296                              |
| H      |                                      |
| G      |                                      |
| F      |                                      |
| E      |                                      |
| D      |                                      |
| C      | ISSUED FOR TENDER                    |
| B      | ISSUED FOR COW REVIEW                |
| A      | ISSUED FOR INTERNAL REVIEW           |
| NO.    | REVISIONS                            |
| DATE   | BY                                   |

|             |              |  |      |
|-------------|--------------|--|------|
| wsp         |              | WSP Canada Inc.<br>1600 Buffalo Place<br>Winnipeg, MB R3T 6B8<br>t. 204.477.6650<br>f. 204.474.2864<br>www.wsp.com |      |
| DESIGNED BY | A.B./E.M.    | CHECKED BY   | S.M. |
| DRAWN BY    | A.B./E.M.    | APPROVED BY  | S.M. |
| HOR. SCALE  | 1:250        | RELEASED FOR CONSTRUCTION  |      |
| VERTICAL    | 1:10         |  |      |
| DATE        | JANUARY 2025 | DATE   |      |

NOTE: CHAINAGES SHOWN ARE ALONG  
℄ OF RIGHT-OF-WAY

- NOTES:
1. ALL WORK AND MATERIALS TO BE IN ACCORDANCE WITH THE LATEST REVISION OF THE CITY OF WINNIPEG STANDARD CONSTRUCTION SPECIFICATIONS.
  2. CONTRACTOR TO CONFIRM THE LOCATION OF ALL UTILITIES/SERVICES IN THE FIELD PRIOR TO CONSTRUCTION.
  3. ALL ROADWAY DIMENSIONS SHOWN ARE TO EDGE OF PAVEMENT.
  4. EXISTING ASPHALT TO BE PLANED AS SHOWN OR AS DIRECTED BY CONTRACT ADMINISTRATOR.
  5. 150mm PARTIAL CONCRETE SLAB PATCHES SHOWN ARE ONLY A REPRESENTATIVE APPROXIMATION OF THE TENDERED QUANTITIES.
  6. EXISTING SIDEWALK TO BE RENEWED AS PER SD-228A AND AS DIRECTED BY CONTRACT ADMINISTRATOR.
  7. RENEW EXISTING CURBS AS DIRECTED BY CONTRACT ADMINISTRATOR.
  8. ALL PRIVATE WALKWAYS TO BE ADJUSTED TO NEW SIDEWALK OR TOP OF CURB ELEVATION, AS DIRECTED BY THE CONTRACT ADMINISTRATOR.
  9. PAVEMENT REPAIR FABRIC TO BE INSTALLED AS SHOWN OR AS DIRECTED BY CONTRACT ADMINISTRATOR.
  10. MODIFIED BARRIER CURB TO BE CONSTRUCTED AT ALL RADI AS DIRECTED BY CONTRACT ADMINISTRATOR.
  11. CONTRACTORS TO TAKE PRECAUTIONARY STEPS TO PROTECT EXISTING TREES WITHIN THE LIMITS OF CONSTRUCTION FROM DAMAGE FROM CONSTRUCTION ACTIVITIES AS OUTLINED IN THE SPECIFICATIONS.
  12. LAMP STANDARDS, HYDRO POLES, AND ANCHORS THAT REQUIRE TEMPORARY SUPPORT, REMOVAL OR REPLACEMENT, TO BE DONE SO AT THE EXPENSE OF THE CONTRACTOR AS NECESSARY.
  13. ALL BOULEVARDS TO BE SODDED UNLESS OTHERWISE NOTED.
  14. ADJUST ALL WATER VALVES, HYDRANTS, MANHOLES, AND CATCH BASINS IN WORK AREA TO GRADE.

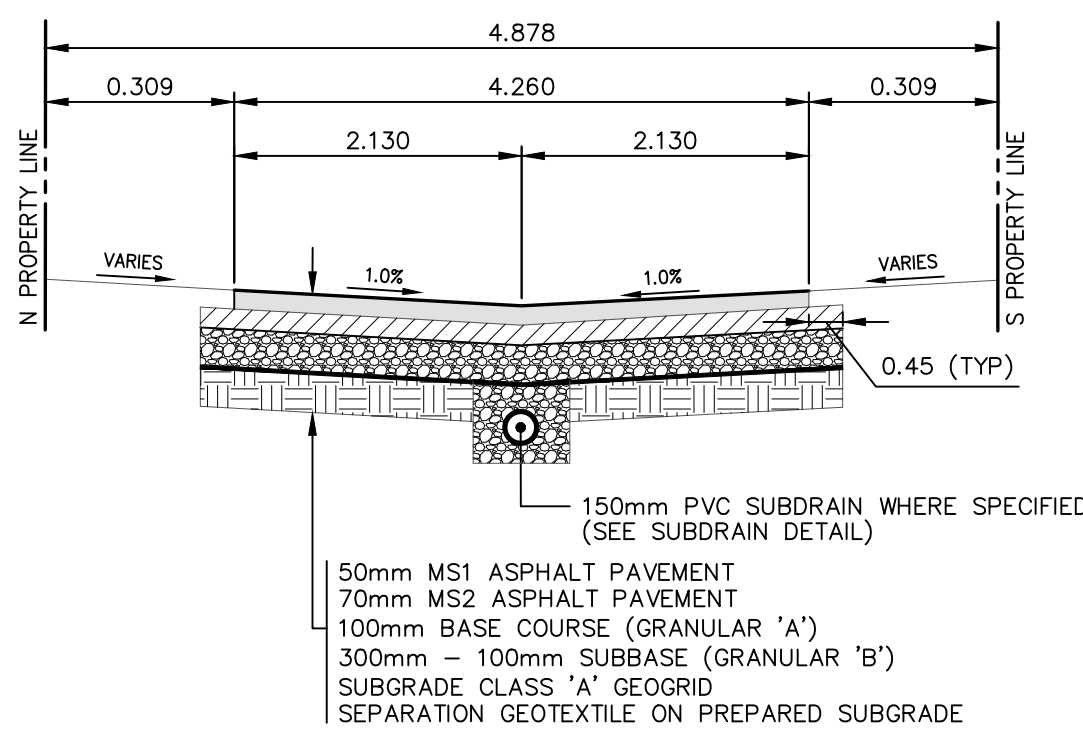

TYPICAL CROSS-SECTION  
NTS

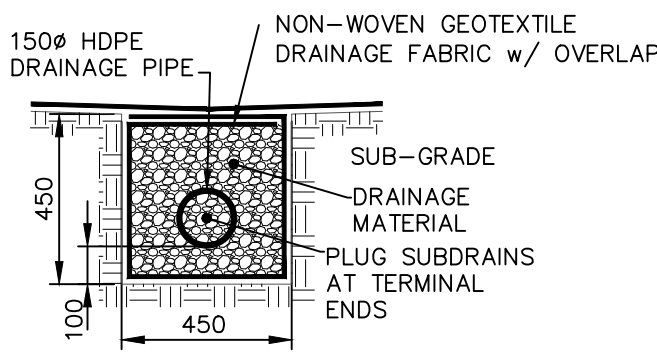

- REFERENCE SPECIFICATIONS
1. SUB-GRADE, SUB-BASE AND BASE MATERIAL SHALL BE SUPPLIED AND PLACED IN ACCORDANCE WITH CW-3110.
  2. INSTALLATION OF SUBDRAINS SHALL BE IN ACCORDANCE WITH CW-3120.
  3. DRAINAGE GEOTEXTILE FABRIC AND DRAINAGE PIPE SHALL CONFORM TO "APPROVED PRODUCTS FOR SURFACE WORKS"

TYPICAL ALLEY SUBDRAIN DETAIL  
NTS

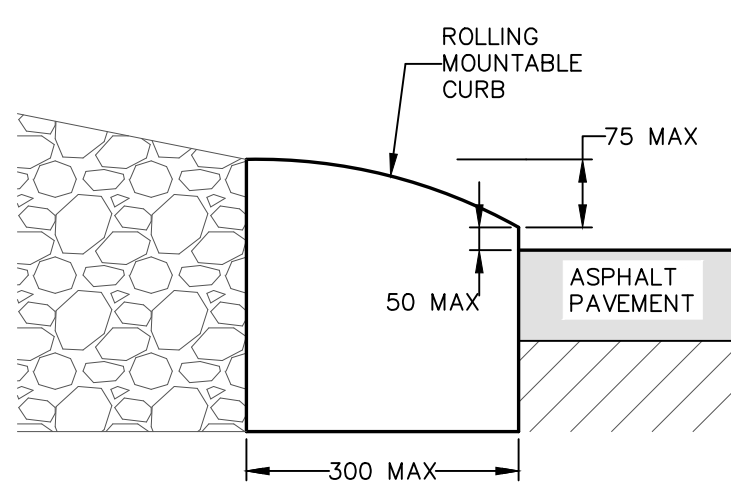

TYPICAL MOUNTABLE LIP CURB DETAIL  
NTS

METRIC

WHOLE NUMBERS INDICATE MILLIMETRES  
DECIMALIZED NUMBERS INDICATE METRES



FOR TENDER PURPOSES ONLY  
NOT FOR CONSTRUCTION



2025 LOCAL STREET ALLEY RENEWALS  
HOWARD AVE./CLARENCE AVE. EAST-WEST ALLEY

ALLEY RECONSTRUCTION  
STA. 2+15 TO STA. 3+09.53

CITY DRAWING NUMBER  
SHEET 5 OF 12  
TENDER NO.  
227-2025

CONSULTANT ACAD DWG. NO.  
CA0043424.6934-52