

Mar 21, 2025 - 10:38am
P:\2024\CA0043424.6934 - CA-25-R-04 Local Streets\02 Drawings\03 Work_Dwg\CA0043424.6934_CA_25-R-04_Clarance_Boston_Alley_Plan&Profile.dwg -tob:227-2025_CA0043424.6934_49-RC

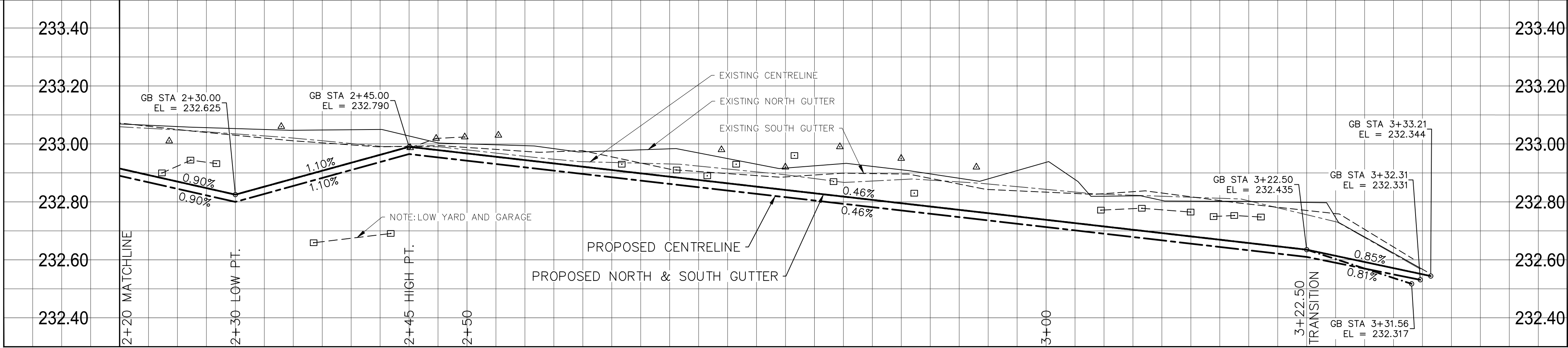

ALLEY PAVEMENT PROFILE

SCALE: 1:250 HOR
1:10 VER

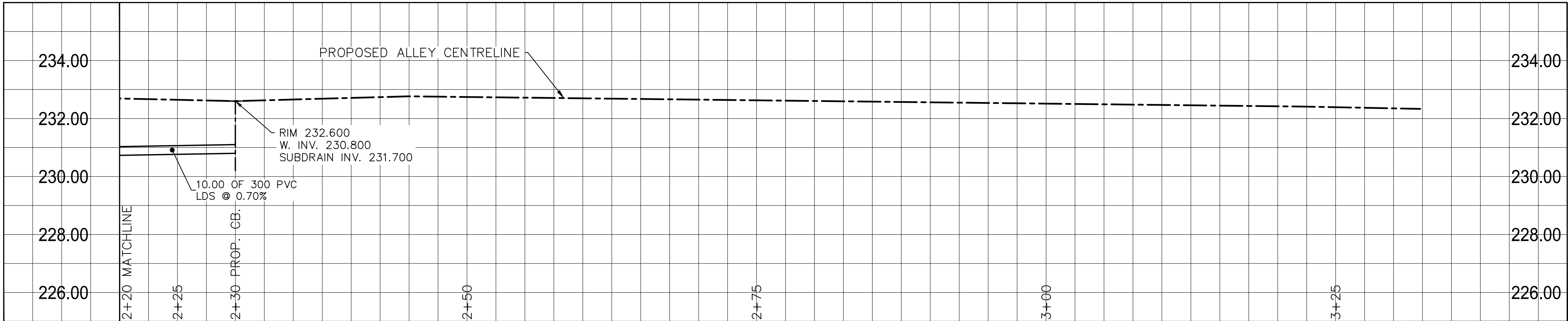

LAND DRAINAGE SEWER PROFILE

SCALE: 1:250 HOR
1:100 VER

- NOTES:
1. ALL WORK AND MATERIALS TO BE IN ACCORDANCE WITH THE LATEST REVISION OF THE CITY OF WINNIPEG STANDARD CONSTRUCTION SPECIFICATIONS.
 2. CONTRACTOR TO CONFIRM THE LOCATION OF ALL UTILITIES/SERVICES IN THE FIELD PRIOR TO CONSTRUCTION.
 3. ALL ROADWAY DIMENSIONS SHOWN ARE TO EDGE OF PAVEMENT.
 4. EXISTING ASPHALT TO BE PLANED AS SHOWN OR AS DIRECTED BY CONTRACT ADMINISTRATOR.
 5. 150mm PARTIAL CONCRETE SLAB PATCHES SHOWN ARE ONLY A REPRESENTATIVE APPROXIMATION OF THE TENDERED QUANTITIES.
 6. EXISTING SIDEWALK TO BE RENEWED AS PER SD-228A AND AS DIRECTED BY CONTRACT ADMINISTRATOR.
 7. RENEW EXISTING CURBS AS DIRECTED BY CONTRACT ADMINISTRATOR.
 8. ALL PRIVATE WALKWAYS TO BE ADJUSTED TO NEW SIDEWALK OR TOP OF CURB ELEVATION, AS DIRECTED BY THE CONTRACT ADMINISTRATOR.
 9. PAVEMENT REPAIR FABRIC TO BE INSTALLED AS DIRECTED BY CONTRACT ADMINISTRATOR.
 10. MODIFIED BARRIER CURB TO BE CONSTRUCTED AT ALL RADII AS DIRECTED BY CONTRACT ADMINISTRATOR.
 11. CONTRACTORS TO TAKE PRECAUTIONARY STEPS TO PROTECT EXISTING TREES WITHIN THE LIMITS OF CONSTRUCTION FROM DAMAGE FROM CONSTRUCTION ACTIVITIES AS OUTLINED IN THE SPECIFICATIONS.
 12. LAMP STANDARDS, HYDRO POLES, AND ANCHORS THAT REQUIRE TEMPORARY SUPPORT, REMOVAL OR REPLACEMENT, TO BE DONE SO AT THE EXPENSE OF THE CONTRACTOR AS NECESSARY.
 13. ALL BOULEVARDS TO BE SODDED UNLESS OTHERWISE NOTED.
 14. ADJUST ALL WATER VALVES, HYDRANTS, MANHOLES, AND CATCH BASINS IN WORK AREA TO GRADE.

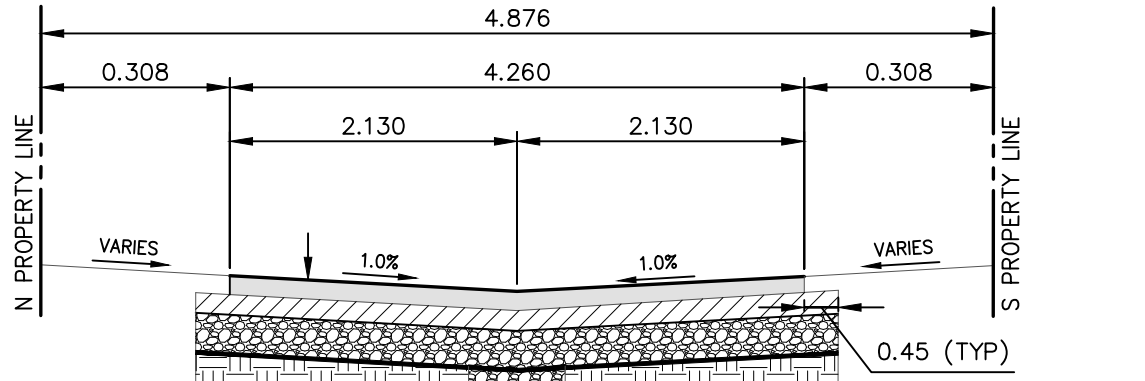

150mm PVC SUBDRAIN WHERE SPECIFIED (SEE SUBDRAIN DETAIL)

50mm MS1 ASPHALT PAVEMENT
70mm MS2 ASPHALT PAVEMENT
100mm BASE COURSE (GRANULAR 'A')
300mm - 100mm SUBBASE (GRANULAR 'B')
SUBGRADE CLASS 'A' GEOTEXTILE
SEPARATION GEOTEXTILE ON PREPARED SUBGRADE

TYPICAL CROSS-SECTION

NTS

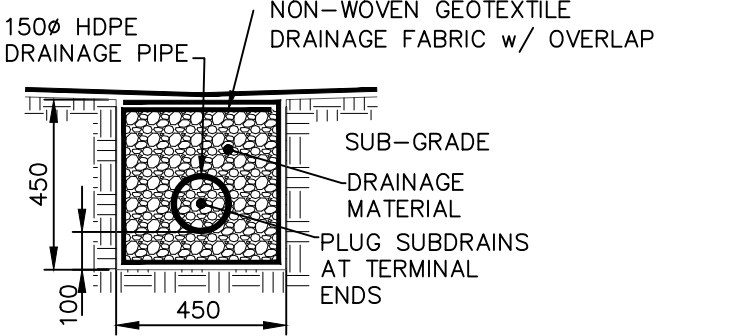

- REFERENCE SPECIFICATIONS
1. SUB-GRADE, SUB-BASE AND BASE MATERIAL SHALL BE SUPPLIED AND PLACED IN ACCORDANCE WITH CW-3110
 2. INSTALLATION OF SUBDRAINS SHALL BE IN ACCORDANCE WITH CW-3120
 3. DRAINAGE GEOTEXTILE FABRIC AND DRAINAGE PIPE SHALL CONFORM TO "APPROVED PRODUCTS FOR SURFACE WORKS"

TYPICAL ALLEY SUBDRAIN DETAIL

NTS

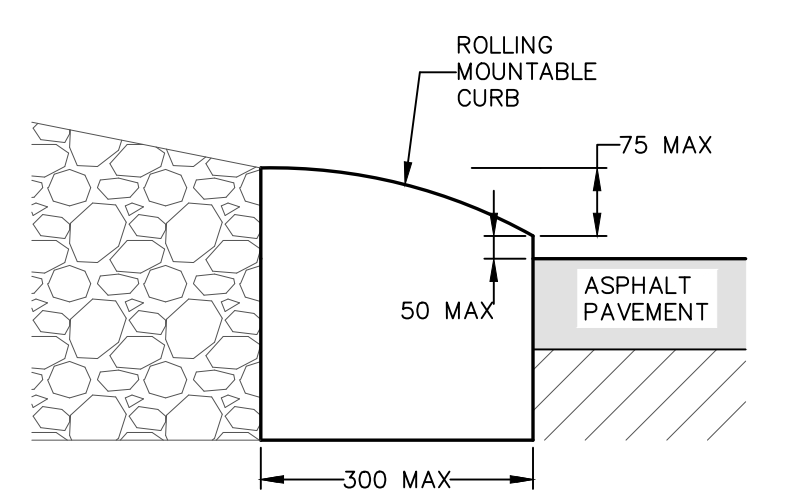

TYPICAL MOUNTABLE LIP CURB DETAIL

NTS

METRIC

WHOLE NUMBERS INDICATE MILLIMETRES
DECIMALIZED NUMBERS INDICATE METRES

**ENGINEERS
GEOSCIENTISTS
MANITOBA**
Certificate of Authorization
WSP Canada Inc.
No. 5750

FOR TENDER PURPOSES ONLY

NOT FOR CONSTRUCTION

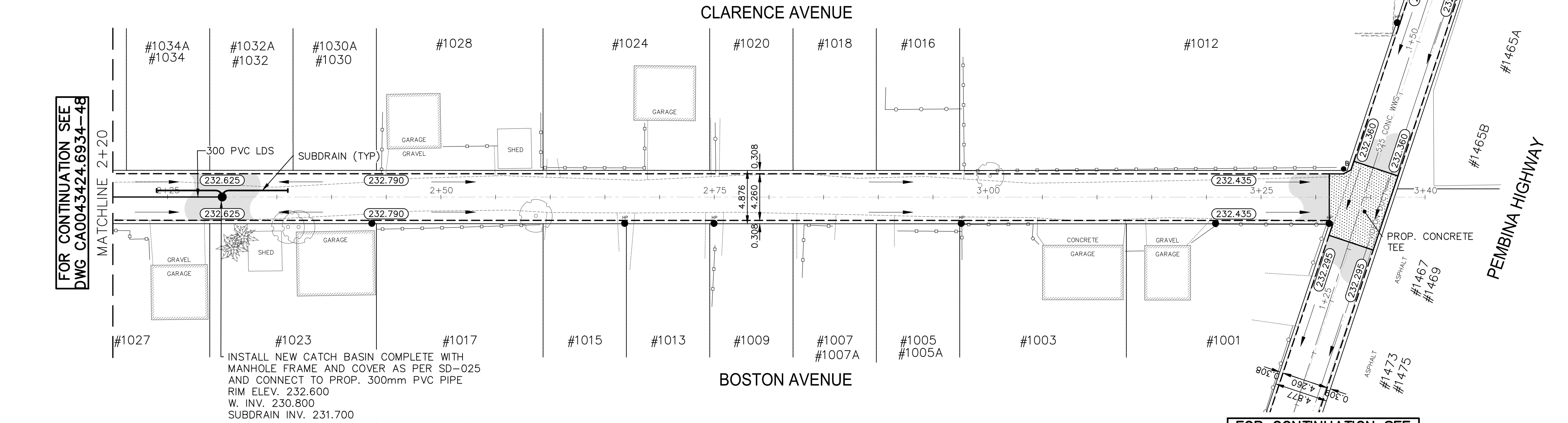

NOTE: CHAINAGES SHOWN ARE ALONG
C OF RIGHT-OF-WAY

LOCATIONS APPROVED
UNDERGROUND STRUCTURES

SIGNED BY: _____ DATE: _____
SUPV UG STRUCTURES

LOCATION OF UNDERGROUND STRUCTURES AS SHOWN ARE BASED ON THE BEST INFORMATION AVAILABLE BUT NO GUARANTEE IS GIVEN THAT ALL EXISTING UTILITIES ARE SHOWN OR THAT THE GIVEN LOCATIONS ARE EXACT CONFIRMATION OF EXISTANCE AND EXACT LOCATION OF ALL SERVICES MUST BE OBTAINED FROM THE INDIVIDUAL UTILITIES BEFORE PROCEEDING

G.B.M. ELEV.	TOH AT THE SOUTH-EAST CORNER OF BOSTON AVE. AND HUDSON ST. 233.532
H	
G	
F	
E	
C	
D	
A	
B	
C	
A	
NO.	REVISIONS

wsp		WSP Canada Inc. 1600 Buffalo Place Winnipeg, MB R3T 6B8 t. 204.477.6650 f. 204.474.2864 www.wsp.com	
DESIGNED BY	A.B./E.M.	CHECKED BY	S.M.
DRAWN BY	A.B./E.M.	APPROVED BY	S.M.
HOR. SCALE	1:250	RELEASED FOR CONSTRUCTION	
VERTICAL	1:10		
DATE	JANUARY 2025	DATE	

CONSULTANT ACAD DWG. NO.	CA0043424.6934-49
--------------------------	-------------------

THE CITY OF WINNIPEG PUBLIC WORKS DEPARTMENT ENGINEERING SERVICES DIVISION	CITY DRAWING NUMBER
2025 LOCAL STREET ALLEY RENEWALS CLARENCE AVE./BOSTON AVE. EAST-WEST ALLEY	SHEET 02 OF 12
ALLEY RECONSTRUCTION STA. 2+20 TO STA. 3+32.31	TENDER NO. 227-2025

EXISTING	LEGEND-PLAN	PROPOSED	EXISTING	LEGEND-PLAN	PROPOSED	EXISTING	LEGEND-PLAN	PROPOSED	EXISTING	LEGEND-PLAN	PROPOSED
---	WATER MAIN	---	---	NORTH/WEST GARAGE APPROACH	---	---	---	---	---	---	---
---	LAND DRAINAGE SEWER	---	---	SOUTH/EAST GARAGE APPROACH	---	---	---	---	---	---	---
---	WASTE WATER SEWER	---	---	VALVE	---	---	---	---	---	---	---
---	HYDRO	---	---	CURB STOP	---	---	---	---	---	---	---
---	GAS	---	---	HYDRO POLE & LIGHT STANDARD	---	---	---	---	---	---	---
---	COMMUNICATIONS	---	---	LIGHT STANDARD OR TRAFFIC SIGNAL	---	---	---	---	---	---	---
---	SIGNALS	---	---	HYDRO POLE / ANCHOR	---	---	---	---	---	---	---
---	MANHOLE	---	---	FENCE	---	---	---	---	---	---	---
---	CATCH BASIN/CATCH PIT	---	---	PROPERTY LINE	---	---	---	---	---	---	---
---	CURB INLET	---	---	TEST HOLE / PAVEMENT CORE	---	---	---	---	---	---	---
---	UTILITIES ADJUSTED	---	---	ELEVATIONS	---	---	---	---	---	---	---
---	HYDRANT	---	---	CURB RAMP	---	---	---	---	---	---	---
---	LEGEND-PLAN	---	---	DETECTABLE WARNING SURFACE TILE	---	---	---	---	---	---	---