

Apr 07, 2025 - 2:30pm
P:\2024\CA0043424.6934 - CA-25-R-04 Local Streets\02 Drawings\02 Work_Dwg CA0043424.6934_CA_25-R-04_Howard_Clarance_Alley_Plan&Profile.dwg -Tab:227-2025_CA0043424.6934_52-RD

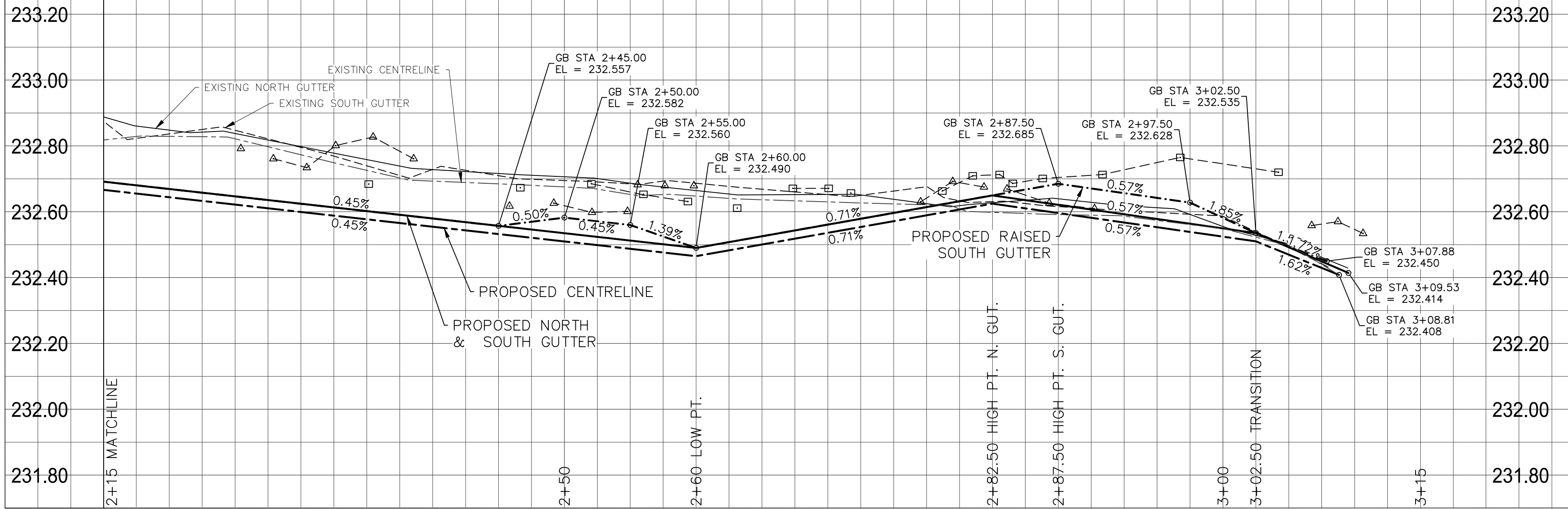

ALLEY PAVEMENT PROFILE
SCALE: 1:250 HOR
1:10 VER

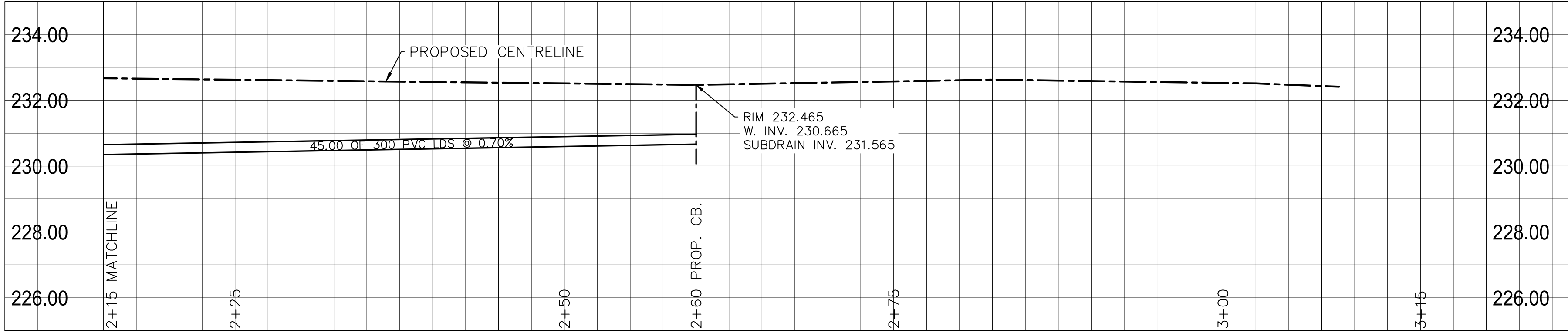

LAND DRAINAGE SEWER PROFILE
SCALE: 1:250 HOR
1:100 VER

← PHASE 1 | PHASE 2 →
CONSTRUCTION | CONSTRUCTION

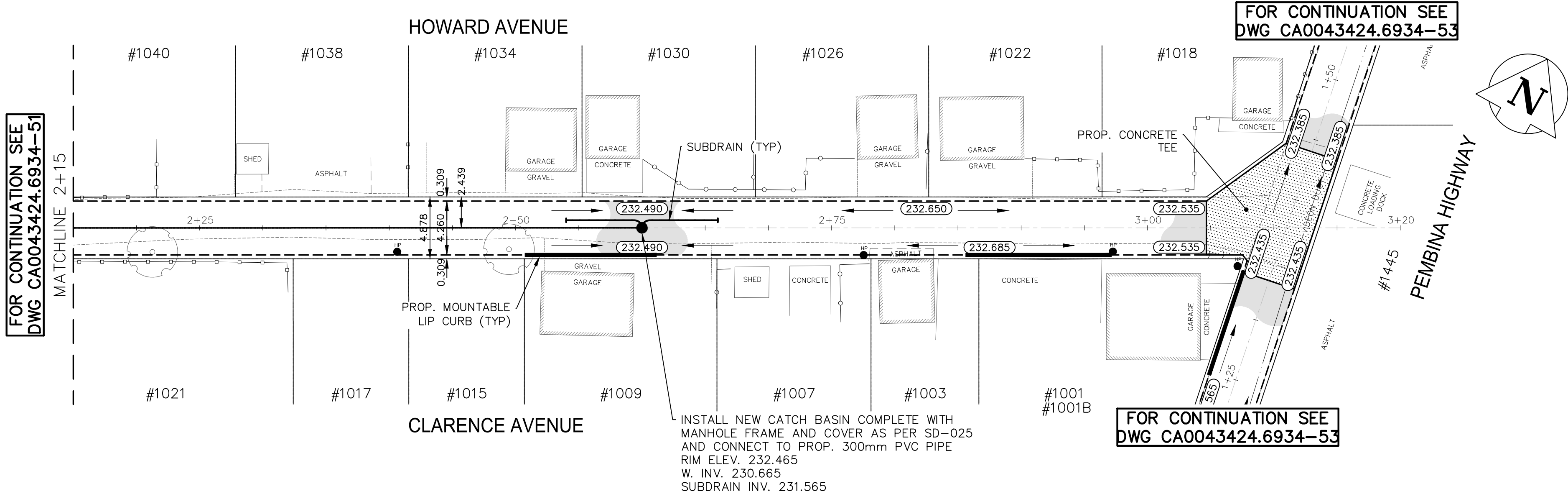

INSTALL NEW CATCH BASIN COMPLETE WITH MANHOLE FRAME AND COVER AS PER SD-025 AND CONNECT TO PROP. 300mm PVC PIPE
RIM ELEV. 232.465
W. INV. 230.665
SUBDRAIN INV. 231.565

- NOTES:
1. ALL WORK AND MATERIALS TO BE IN ACCORDANCE WITH THE LATEST REVISION OF THE CITY OF WINNIPEG STANDARD CONSTRUCTION SPECIFICATIONS.
 2. CONTRACTOR TO CONFIRM THE LOCATION OF ALL UTILITIES/SERVICES IN THE FIELD PRIOR TO CONSTRUCTION.
 3. ALL ROADWAY DIMENSIONS SHOWN ARE TO EDGE OF PAVEMENT.
 4. EXISTING ASPHALT TO BE PLANED AS SHOWN OR AS DIRECTED BY CONTRACT ADMINISTRATOR.
 5. 150mm PARTIAL CONCRETE SLAB PATCHES SHOWN ARE ONLY A REPRESENTATIVE APPROXIMATION OF THE TENDERED QUANTITIES.
 6. EXISTING SIDEWALK TO BE RENEWED AS PER SD-228A AND AS DIRECTED BY CONTRACT ADMINISTRATOR.
 7. RENEW EXISTING CURBS AS DIRECTED BY CONTRACT ADMINISTRATOR.
 8. ALL PRIVATE WALKWAYS TO BE ADJUSTED TO NEW SIDEWALK OR TOP OF CURB ELEVATION, AS DIRECTED BY THE CONTRACT ADMINISTRATOR.
 9. PAVEMENT REPAIR FABRIC TO BE INSTALLED AS SHOWN OR AS DIRECTED BY CONTRACT ADMINISTRATOR.
 10. MODIFIED BARRIER CURB TO BE CONSTRUCTED AT ALL RADI AS DIRECTED BY CONTRACT ADMINISTRATOR.
 11. CONTRACTORS TO TAKE PRECAUTIONARY STEPS TO PROTECT EXISTING TREES WITHIN THE LIMITS OF CONSTRUCTION FROM DAMAGE FROM CONSTRUCTION ACTIVITIES AS OUTLINED IN THE SPECIFICATIONS.
 12. LAMP STANDARDS, HYDRO POLES, AND ANCHORS THAT REQUIRE TEMPORARY SUPPORT, REMOVAL OR REPLACEMENT, TO BE DONE SO AT THE EXPENSE OF THE CONTRACTOR AS NECESSARY.
 13. ALL BOULEVARDS TO BE SODDED UNLESS OTHERWISE NOTED.
 14. ADJUST ALL WATER VALVES, HYDRANTS, MANHOLES, AND CATCH BASINS IN WORK AREA TO GRADE.

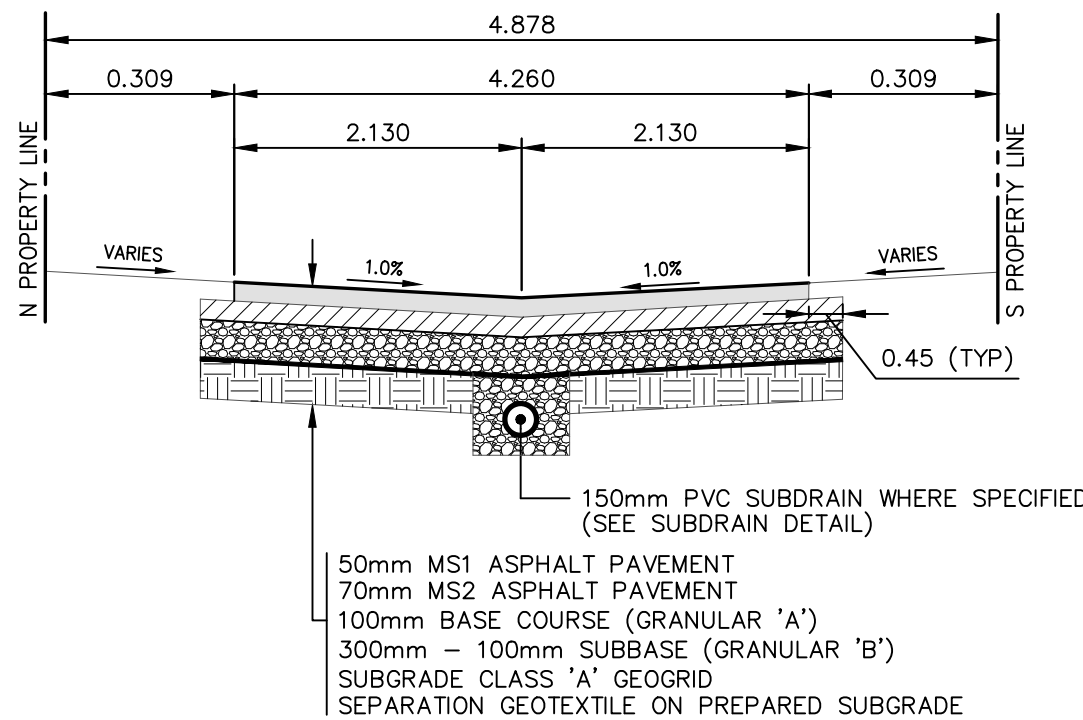

TYPICAL CROSS-SECTION
NTS

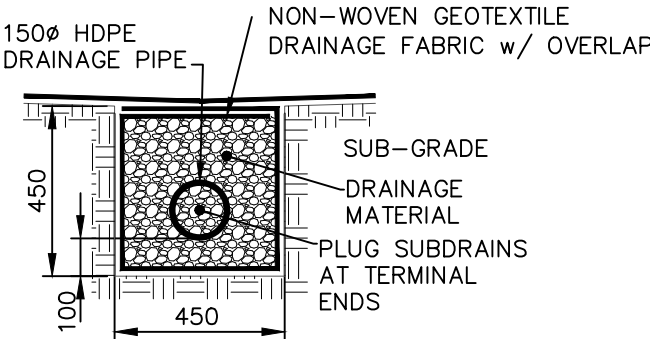

- REFERENCE SPECIFICATIONS
1. SUB-GRADE, SUB-BASE AND BASE MATERIAL SHALL BE SUPPLIED AND PLACED IN ACCORDANCE WITH CW-3110.
 2. INSTALLATION OF SUBDRAINS SHALL BE IN ACCORDANCE WITH CW-3120.
 3. DRAINAGE GEOTEXTILE FABRIC AND DRAINAGE PIPE SHALL CONFORM TO "APPROVED PRODUCTS FOR SURFACE WORKS"

TYPICAL ALLEY SUBDRAIN DETAIL
NTS

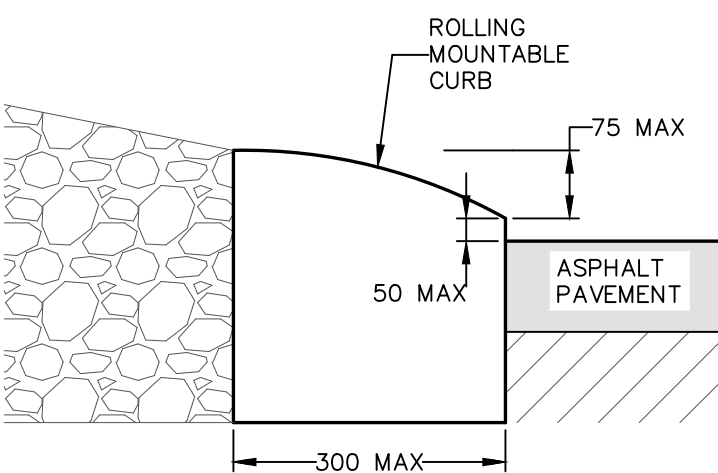

TYPICAL MOUNTABLE LIP CURB DETAIL
NTS

METRIC

WHOLE NUMBERS INDICATE MILLIMETRES
DECIMALIZED NUMBERS INDICATE METRES

**ENGINEERS
GEOSCIENTISTS
MANITOBA**
Certificate of Authorization
WSP Canada Inc.
No. 5750

NOTE: CHAINAGES SHOWN ARE ALONG
℄ OF RIGHT-OF-WAY

FOR TENDER PURPOSES ONLY
NOT FOR CONSTRUCTION

---	WATER MAIN	---	△ --- △	NORTH/WEST GARAGE APPROACH					
---	LAND DRAINAGE SEWER	---	□ --- □	SOUTH/EAST GARAGE APPROACH					
---	WASTE WATER SEWER	---	⊗	VALVE	⊗			EDGE OF SIDEWALK	---
---	HYDRO	---	⚡	CURB STOP	⚡			EDGE OF ASPHALT	---
---	GAS	---	→	HYDRO POLE & LIGHT STANDARD	→			EDGE OF CONCRETE	---
---	COMMUNICATIONS	---	HP	LIGHT STANDARD OR TRAFFIC SIGNAL	→			MODIFIED BARRIER CURB	---
---	SIGNALS	---	HP	HYDRO POLE / ANCHOR	→			BARRIER CURB	---
---	MANHOLE	●	---	FENCE	---			BARRIER CURB AND GUTTER	---
---	CATCH BASIN/CATCH PIT	■	---	PROPERTY LINE	---			PAVING STONE	---
---	CURB INLET	▼	---	TEST HOLE / PAVEMENT CORE	---			CONCRETE SIDEWALK	---
---	UTILITIES ADJUSTED	△ ○	---	ELEVATIONS	(231.000)			CONCRETE SLAB	---
---	HYDRANT	◆	---	CURB RAMP	---			ASPHALT	---
---	LEGEND-PLAN	PROPOSED	---	DETECTABLE WARNING SURFACE TILE	---			MILLED SURFACE	---
---	EXISTING	EXISTING	---	LEGEND-PLAN	PROPOSED	---		PAVEMENT REPAIR FABRIC	---
---			---			---			---

LOCATIONS APPROVED UNDERGROUND STRUCTURES

SIGNED BY:
SUPV U/G STRUCTURES

DATE

LOCATION OF UNDERGROUND STRUCTURES AS SHOWN ARE BASED ON THE BEST INFORMATION AVAILABLE BUT NO GUARANTEE IS GIVEN THAT ALL EXISTING UTILITIES ARE SHOWN OR THAT THE GIVEN LOCATIONS ARE EXACT CONFIRMATION OF EXISTANCE AND EXACT LOCATION OF ALL SERVICES MUST BE OBTAINED FROM THE INDIVIDUAL UTILITIES BEFORE PROCEEDING

G.B.M. TOH IN FRONT OF HOUSE 341 HUDSON ST.
ELEV. 232.296

H					
G					
F					
E					
D	ISSUED FOR ADDENDUM_4	2025/04/07	A.B.		
C	ISSUED FOR TENDER	2025/03/20	A.B.		
B	ISSUED FOR COW REVIEW	2025/03/19	A.B.		
A	ISSUED FOR INTERNAL REVIEW	2025/03/12	A.B.		
NO.	REVISIONS	DATE	BY	DATE	BY

wsp

DESIGNED BY
A.B./E.M.
CHECKED BY
S.M.
DRAWN BY
A.B./E.M.
APPROVED BY
S.M.
HOR. SCALE
VERTICAL
1:250
1:10
RELEASED FOR
CONSTRUCTION
DATE
JANUARY 2025
DATE

WSP Canada Inc.
1600 Buffalo Place
Winnipeg, MB R3T 6B8
t. 204.477.6650
f. 204.474.2864
www.wsp.com

ENGINEER'S SEAL

CONSULTANT ACAD DWG. NO.
CA0043424.6934-52

Winnipeg

THE CITY OF WINNIPEG
PUBLIC WORKS DEPARTMENT
ENGINEERING SERVICES DIVISION

2025 LOCAL STREET ALLEY RENEWALS
HOWARD AVE./CLARENCE AVE. EAST-WEST ALLEY

ALLEY RECONSTRUCTION
STA. 2+15 TO STA. 3+09.53

CITY DRAWING NUMBER
SHEET 5 OF 15

TENDER NO.
227-2025