

# **APPENDIX 'D'**

## **BARRIER CURB INLET DETAILS**

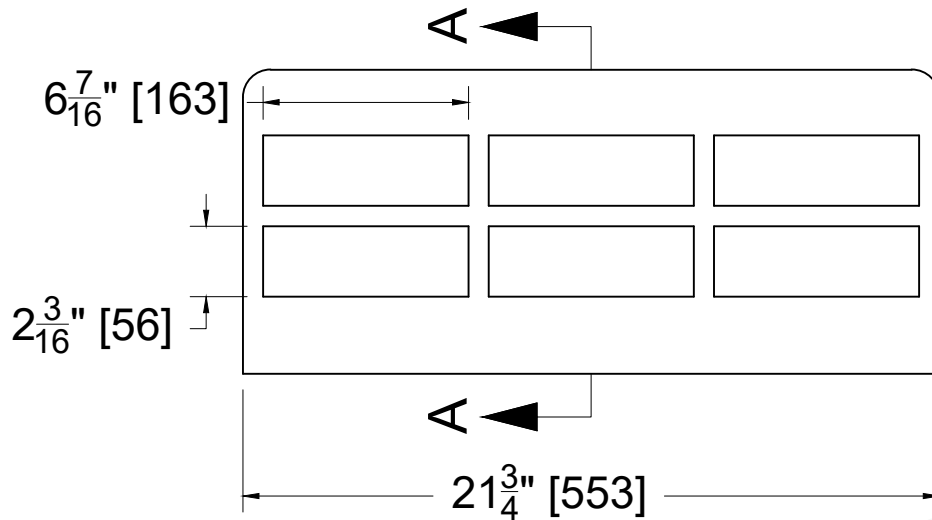

TF-103    ASTM A48 CL35B    D&L FOUNDRY    Ⓟ  
 MM/DD/YYYY    AASHTO M306

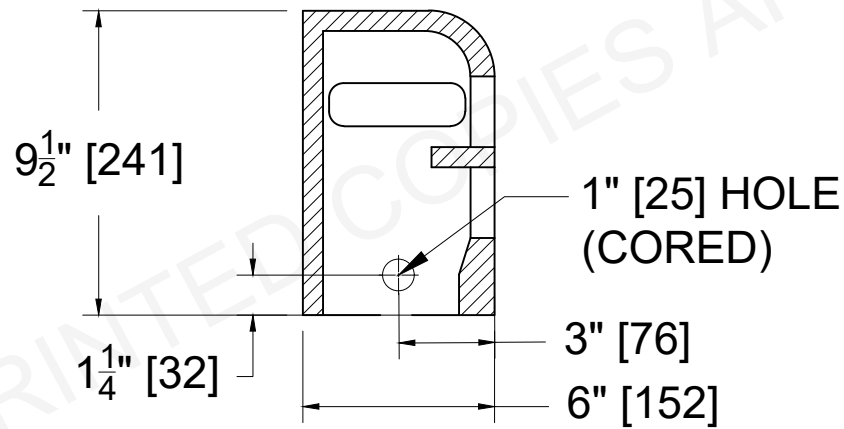

**SECTION A-A**



**D&L Foundry, Inc.**  
**"The Iron Men"**  
 MADE IN THE USA

THE INFORMATION CONTAINED IN THIS DRAWING  
 IS THE SOLE PROPERTY OF D&L FOUNDRY. ANY  
 REPRODUCTION IN PART OR AS A WHOLE  
 WITHOUT THE WRITTEN PERMISSION OF D&L  
 FOUNDRY IS PROHIBITED

**PART NUMBER**

**TF-103SI**

**DATE**

9/15/20

11/2/21

11/5/21

**DESCRIPTION**

DRAWING OF EXISTING PART

ECR 2276 - CHANGE SLOT IN SIDE TO A HOLE  
 TO MATCH THE PATTERN

ECR 2281 - ADD CENTER MARK AND  
 DIMENSIONS OF SIDE HOLE LOCATION

**DRAWN**

DF

DF

DF

**APPROVED**

D.C.

D.C.

D.C.

GRAY IRON  
 CONFORMS TO  
 ASTM A48 CL35B

AASHTO M306

**REFERENCE INFORMATION**

**TOOLING NUMBERS**

**PATTERN LOCATION**

TOOLS

COPE: -6237 COPE: -6237

DRAG: -6238 DRAG: -6238

DESIGNATES MACHINED SURFACE

**TOLERANCES**

ALL TOLERANCES ARE  $\pm \frac{1}{16}$ " PER  
 FOOT, OR 1.6 MM PER 300 MM  
 MEASUREMENTS LESS THAN ONE FOOT  
 ARE  $\pm \frac{1}{16}$ ", OR 1.6 MM  
 UNLESS OTHERWISE SPECIFIED

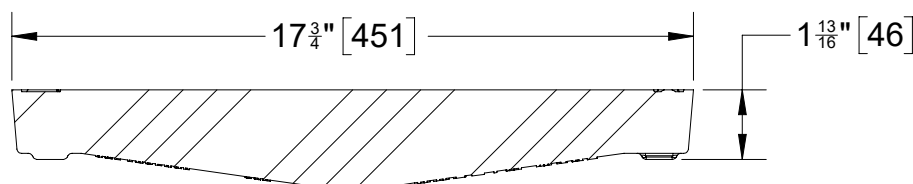
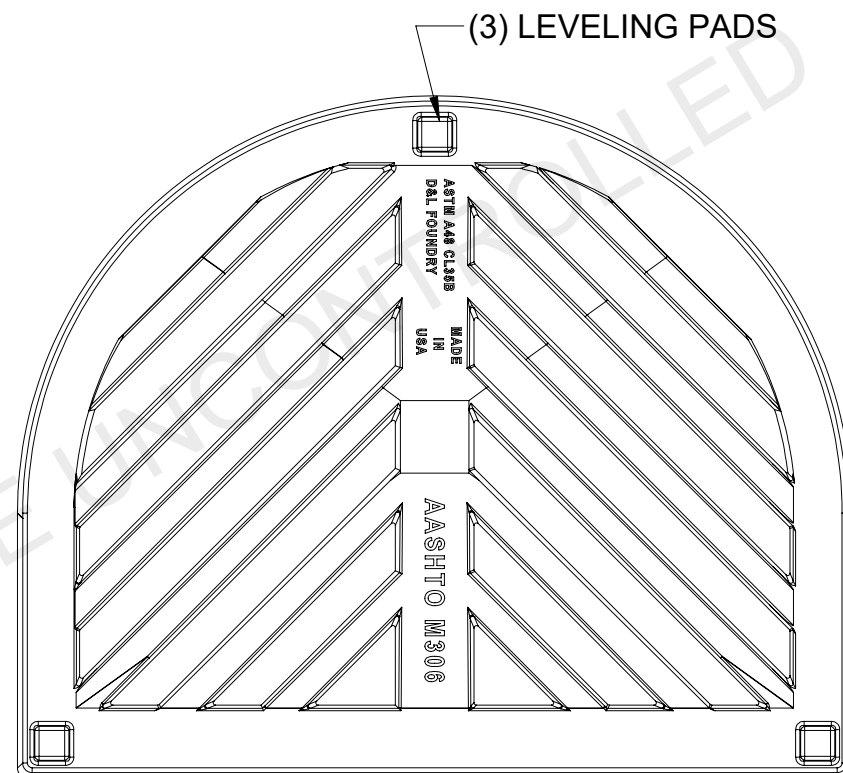
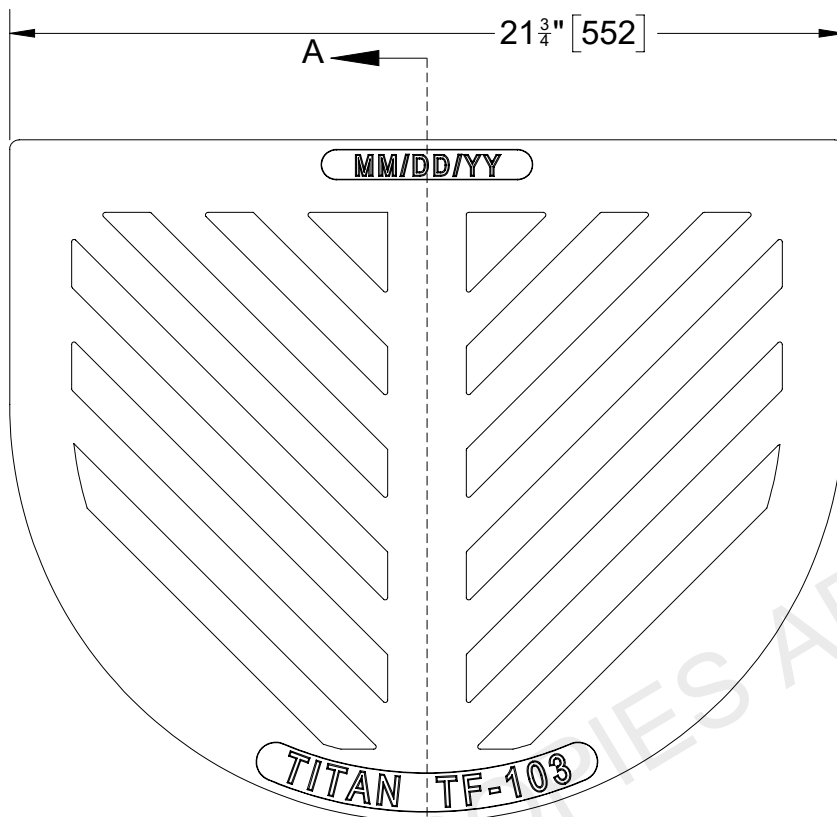

SECTION A-A



NOTES: 5X1 GRATE BARS

D&L Foundry, Inc. "The Iron Men" MADE IN THE USA	PART NUMBER	DATE	DESCRIPTION	DRAWN	APPROVED	REFERENCE INFORMATION	TOLERANCE
		7/18/24	NEW GRATE DESIGN FOR TF-103 SERIES	D.C.			
<small>THE INFORMATION CONTAINED IN THIS DRAWING IS THE SOLE PROPERTY OF D&amp;L FOUNDRY, ANY REPRODUCTION IN PART OR AS WHOLE WITHOUT THE WRITTEN PERMISSION OF D&amp;L FOUNDRY IS PROHIBITED</small>	TF-103G MODIFIED					GRAY IRON CONFORMS TO ASTM A48 CL35B AASHTO M306  AASHTO M306  TOOLING NUMBERS TOOLS COPE: -NEW DRAG: -NEW PATTERN LOCATION COPE: -NEW DRAG: -NEW > DESIGNATES MACHINED SURFACE	<small>ALL TOLERNCES ARE <math>\pm\frac{1}{32}"</math> PER FOOT, OR 1.6 MM PER 300MM MEASUREMENTS LESS THAN ONE FOOT [300MM] ARE <math>\pm\frac{1}{32}"</math>, OR 1.6MM UNLESS OTHERWISE SPECIFIED</small>

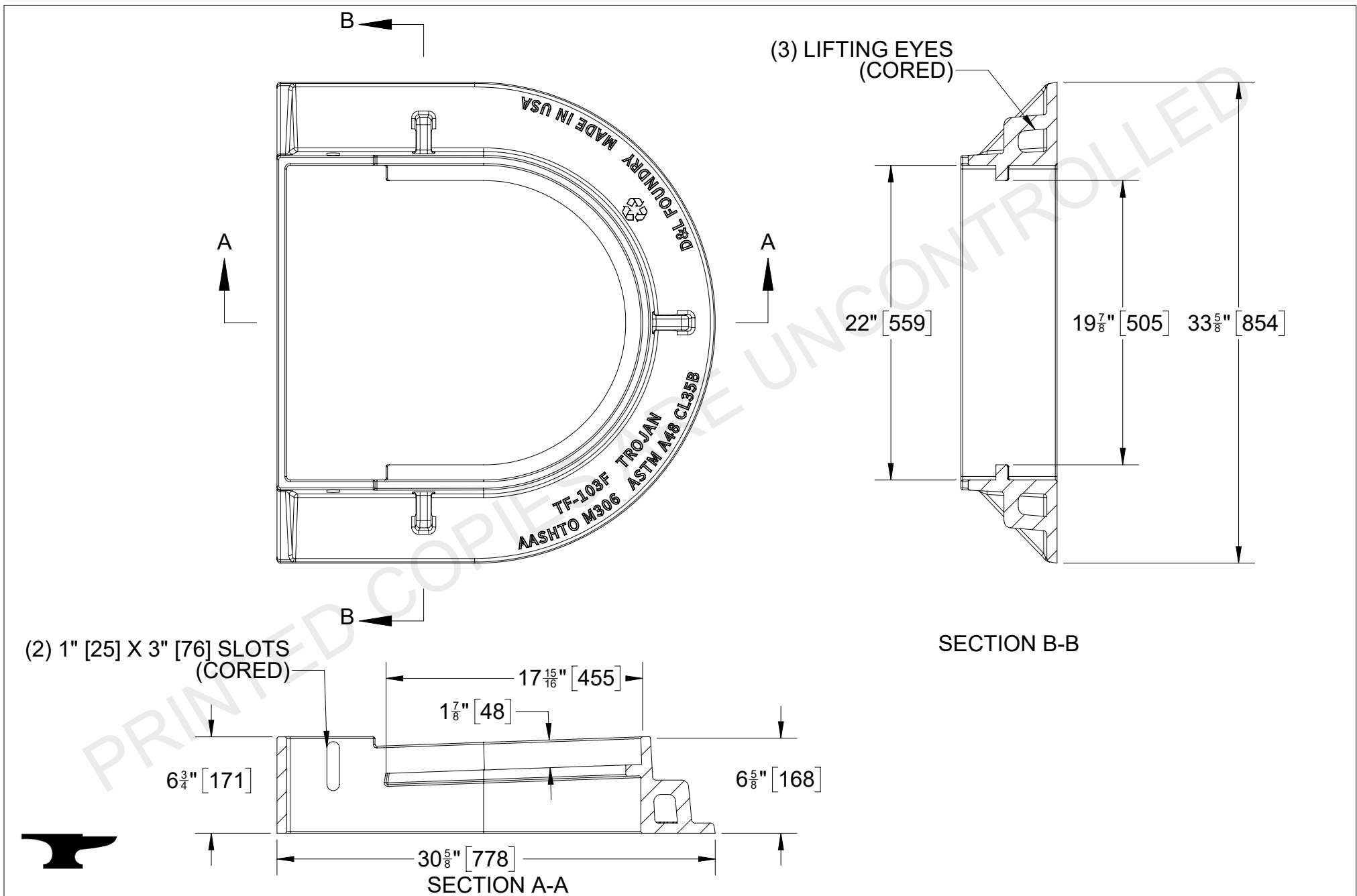

D&L Foundry, Inc. "The Iron Men" MADE IN THE USA	PART NUMBER	DATE	DESCRIPTION	DRAWN	APPROVED	REFERENCE INFORMATION	TOLERANCE
		7/18/24	NEW PATTERN FOR TF-103 SERIES	D.C.			
<small>THE INFORMATION CONTAINED IN THIS DRAWING IS THE SOLE PROPERTY OF D&amp;L FOUNDRY, ANY REPRODUCTION IN PART OR AS WHOLE WITHOUT THE WRITTEN PERMISSION OF D&amp;L FOUNDRY IS PROHIBITED</small>	TF-103F MODIFIED					GRAY IRON CONFORMS TO ASTM A48 CL35B AASHTO M306	<small>ALL TOLERNCES ARE <math>\pm \frac{1}{16}</math> PER FOOT, OR 1.6 MM PER 300MM MEASUREMENTS LESS THAN ONE FOOT [300MM] ARE <math>\pm \frac{1}{32}</math>, OR 1.6MM UNLESS OTHERWISE SPECIFIED</small>
						TOOLING NUMBERS TOOLS PATTERN COPE: -NEW COPE: -NEW DRAG: -NEW DRAG: -NEW	
						AASHTO M306 > DESIGNATES MACHINED SURFACE	