

Mar 24, 2025 — 12:20pm
P:\2023\CA0013525\0407 - Bishop Grandin Pavement Renewal\Drawings\03_Work_Dwg_CAO0013525\0407_Abinojii Mikanah_TMP-SIGNAGE_2025.dwg —tab:166-2025_Drawing_P-3592-23

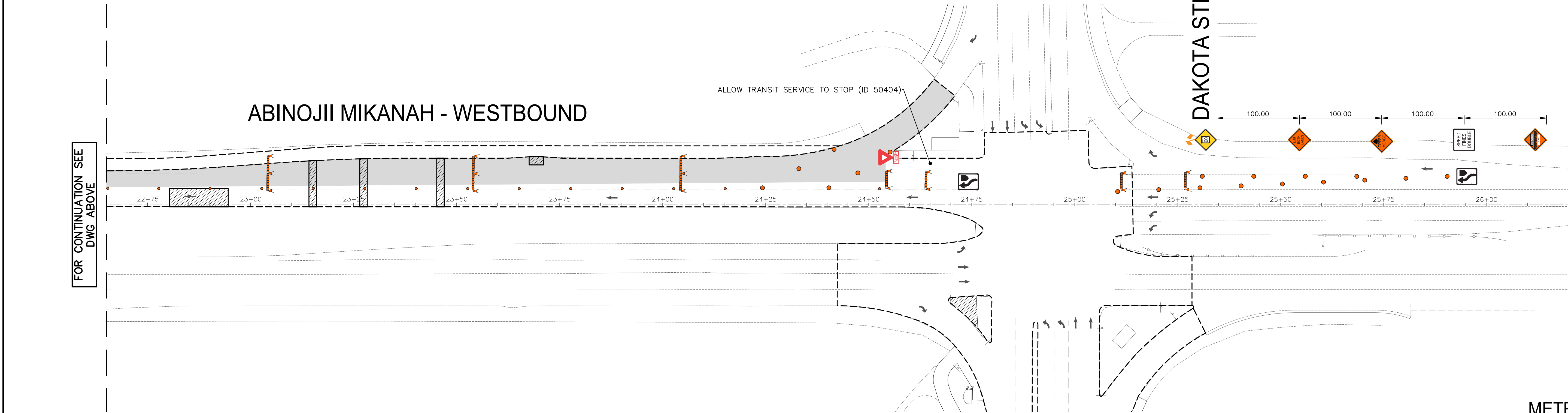
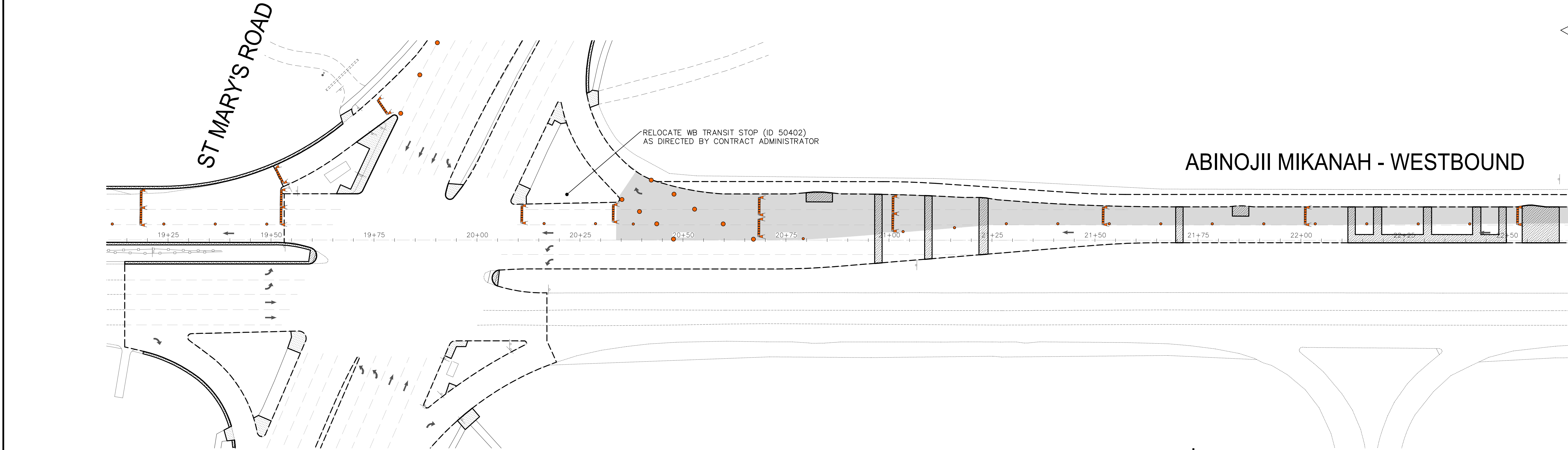

NOTES:

- ALL TRAFFIC SIGNAGE AND TEMPORARY TRAFFIC CONTROL TO CONFORM WITH THE LATEST REVISION OF THE CITY OF WINNIPEG MANUAL OF TEMPORARY TRAFFIC CONTROL ON CITY STREETS.
- CONTRACTOR SHALL MAINTAIN SAFE PEDESTRIAN ACCESS AND CROSSINGS. WHERE SIDEWALKS ARE LOCATED ON BOTH SIDES OF THE STREET, CONTRACTOR MUST MAINTAIN PEDESTRIAN ACCESS ON ONE SIDE AT ALL TIME.
- CONSTRUCTION IS TO BE DONE LANE AT A TIME WITH TRAFFIC TO BE MAINTAINED IN THE EASTBOUND DIRECTION. TRAFFIC IN THE WESTBOUND DIRECTION IS TO BE CLOSED FOR THE DURATION OF THE PROJECT. WHEN CONSTRUCTION IS COMPLETED IN FIRST LANE, TRAFFIC WILL BE MOVED TO THE COMPLETED LANE AND TRAFFIC CONTROL WILL BE MIRRORED.
- PEDESTRIAN ACCESS TO BE MAINTAINED IN ACCORDANCE WITH E6 TRAFFIC MANAGEMENT.

METRIC

WHOLE NUMBERS INDICATE MILLIMETRES
DECIMALIZED NUMBERS INDICATE METRES

FOR INFORMATION ONLY

**ENGINEERS
GEOSCIENTISTS
MANITOBA**

Certificate of Authorization
WSP Canada Inc.
No. 5750

---	WATER MAIN	---	⊗	VALVE	⊗	---	EDGE OF SIDEWALK	---
---	LAND DRAINAGE SEWER	---	♂	CURB STOP	♂	---	EDGE OF ASPHALT	---
---	WASTE WATER SEWER	---	---●---	HYDRO POLE & LIGHT STANDARD	---●---	---	EDGE OF CONCRETE	---
---	HYDRO	---	---HP---	LIGHT STANDARD OR TRAFFIC SIGNAL	---/---	---	MODIFIED BARRIER CURB	---
---	GAS	---	---HP---	HYDRO POLE / ANCHOR	---/---	---	BARRIER CURB	---
---	COMMUNICATIONS	---	---	FENCE	---	---	BARRIER CURB AND GUTTER	---
---	SIGNALS	---	---	PROPERTY LINE	---	---	CONCRETE SIDEWALK	---
○	MANHOLE	●	⊕	IRON BAR	---	---	CONCRETE SLAB	---
□	CATCH BASIN/CATCH PIT	■	⊕	TEST HOLE / PAVEMENT CORE	⊕	---		
△	CURB INLET	▼	(231.00)	ELEVATIONS	(231.000)	---		
◇	UTILITIES ADJUSTED	△ □ ○		CURB RAMP	---	---		
◇	HYDRANT	◆	---	DETECTABLE WARNING SURFACE TILE	---	---		
EXISTING	LEGEND-PLAN	PROPOSED	EXISTING	LEGEND-PLAN	PROPOSED	EXISTING	LEGEND-PLAN	PROPOSED

**LOCATIONS APPROVED
UNDERGROUND STRUCTURES**

SIGNED BY: _____ DATE: _____

SUPV U/G STRUCTURES _____

LOCATION OF UNDERGROUND STRUCTURES AS SHOWN ARE BASED ON THE BEST INFORMATION AVAILABLE BUT NO GUARANTEE IS GIVEN THAT ALL EXISTING UTILITIES ARE SHOWN OR THAT THE GIVEN LOCATIONS ARE EXACT CONFIRMATION OF EXISTANCE AND EXACT LOCATION OF ALL SERVICES MUST BE OBTAINED FROM THE INDIVIDUAL UTILITIES BEFORE PROCEEDING

G.B.M. ELEV.	BOLT ON LAMP STANDARD SW CORNER RIVER ROAD AND ABINOJII MIKANAH 231.926		
7			
6			
5			
4			
3			
2			
1			
0	ISSUED FOR TENDER	2025/03/24	KG
NO.	REVISIONS	DATE	BY

wsp

DESIGNED BY: **KG** CHECKED BY: **SS**

DRAWN BY: **KG** APPROVED BY: **SS**

HOR. SCALE: **1:500**

VERTICAL: **N/A**

RELEASED FOR CONSTRUCTION: **---**

DATE: **---**

WSP Canada Inc.
1600 Buffalo Place
Winnipeg, MB R3T 6B8
t. 204.477.6650
f. 204.474.2864
www.wsp.com

ENGINEER'S SEAL

CONSULTANT ACAD DWG. NO.
CA0013525.0407-123

THE CITY OF WINNIPEG
PUBLIC WORKS DEPARTMENT
ENGINEERING SERVICES DIVISION

**ABINOJII MIKANAH WESTBOUND -
RUBBLIZATION AND MILL & FILL**
TRAFFIC MANAGEMENT PLAN
PHASE III - STAGE I

CITY DRAWING NUMBER: **P-3592-23**
SHEET: **23** OF **25**
TENDER NO.: **166-2025**