

## NOTES:

1. ALL WORK AND MATERIALS TO CONFORM WITH THE LATEST EDITION OF THE CITY OF WINNIPEG STANDARD CONSTRUCTION SPECIFICATIONS.
2. THE INFORMATION SHOWN FOR EXISTING UTILITIES IS THE BEST INFORMATION AVAILABLE BUT NO GUARANTEE IS GIVEN THAT ALL EXISTING UTILITIES ARE SHOWN OR THAT GIVEN UTILITIES ARE EXACT. THE CONTRACTOR IS RESPONSIBLE FOR LOCATING AND PROTECTING ALL UTILITIES DURING CONSTRUCTION. ALL EXISTING UTILITIES MUST BE LOCATED AND VERIFIED PRIOR TO COMMENCEMENT OF WORK. LOST TIME DUE TO FAILURE OF THE CONTRACTOR TO CONFIRM UTILITY LOCATIONS AND NOTIFY THE ENGINEER OF POSSIBLE CONFLICTS PRIOR TO CONSTRUCTION WILL BE AT THE CONTRACTORS' EXPENSE. THE CONTRACTOR SHALL BE RESPONSIBLE FOR THE REPAIR OF EXISTING UTILITIES DISTURBED DURING CONSTRUCTION.
3. ALL AREAS DISTURBED BY THE CONTRACTOR DURING CONSTRUCTION OF THE WORKS SHOWN HEREON SHALL BE RESTORED TO ORIGINAL CONDITION OR BETTER. ALL GRASS AND VEGETATION COVERED AREAS SHALL BE RESTORED TO EXISTING CONDITIONS OR BETTER.
4. EROSION AND SEDIMENT CONTROLS TO BE IN PLACE AND INSTALLED PRIOR TO THE COMMENCEMENT OF CONSTRUCTION AND SHALL REMAIN IN PLACE UNTIL ALL DISTURBED AREAS HAVE BEEN STABILIZED.

## GRADING:

1. ALL GRANULAR BASE COURSE MATERIALS TO BE COMPACTED TO 100% STANDARD PROCTOR DENSITY. ALL GRANULAR SUB-BASE MATERIALS TO BE COMPACTED TO 98% PROCTOR DENSITY.
2. BACKGRADE USING EXCAVATED MATERIAL. EMBANKMENTS TO BE SLOPED AT MAX 3:1, UNLESS OTHERWISE SPECIFIED. ALL EXCAVATED MATERIAL UNDER THE PAVED AREAS TO BE DISPOSED OF OFF SITE UNLESS OTHERWISE NOTED OR DIRECTED BY THE CONSULTANT.

## SITE LANDSCAPE:

1. FOR SITE LANDSCAPE REFER TO THE LANDSCAPE DRAWINGS.

## SITE ELECTRICAL:

1. FOR SITE ELECTRICAL REFER TO THE ELECTRICAL DRAWINGS.

## SITE STORM WATER:

1. THERE ARE NO CHANGES/MINIMAL CHANGES TO THE IMPERVIOUS AREAS FOR THIS RE-DEVELOPMENT. THEREFORE, POST-DEVELOPMENT FLOW FROM THE SITE WILL BE EQUAL TO THE PRE-DEVELOPMENT FLOW. THERE ARE NO CHANGES TO THE SITE STORM WATER PROPOSED FOR THIS DEVELOPMENT.

## SITE WATERMAIN:

1. WATERMAIN SHALL BE POLYVINYL CHLORIDE (PVC) CLASS 150 PIPE (DR 18) MANUFACTURED TO AWWA C-800 WITH GASKET BELL END.
2. ALL WATERMAIN SHALL BE INSTALLED TO A MINIMUM DEPTH OF 2.7 METERS TO CROWN OF PIPE.
3. WATER SERVICES TO THE BUILDINGS TO BE PLUGGED 1.0m OFF THE FACE OF THE BUILDING.
4. WATERMAINS MUST HAVE A MINIMUM VERTICAL CLEARANCE OF 0.3m OVER, AND 0.5m UNDER SEWER AND ALL OTHER UTILITIES WHEN CROSSING.
5. SERVICE CONNECTIONS TO BUILDINGS TO HAVE ALL JOINTS RESTRAINED FROM THE PLUG BACK.
6. ALL WATERMAINS SHALL BE BACTERIOLOGICALLY TESTED. ALL CHLORINATED WATER TO BE DISCHARGED AND PRETREATED TO ACCEPTABLE LEVELS PRIOR TO DISCHARGE. ALL DISCHARGED WATER MUST BE CONTROLLED AND TREATED SO AS NOT TO ADVERSELY AFFECT THE ENVIRONMENT. IT IS THE RESPONSIBILITY OF THE CONTRACTOR TO ENSURE THAT ALL MUNICIPAL AND/OR PROVINCIAL REQUIREMENTS ARE FOLLOWED.
7. ACTUAL SERVICE LOCATIONS TO BUILDING TO BE COORDINATED WITH GENERAL CONTRACTOR.

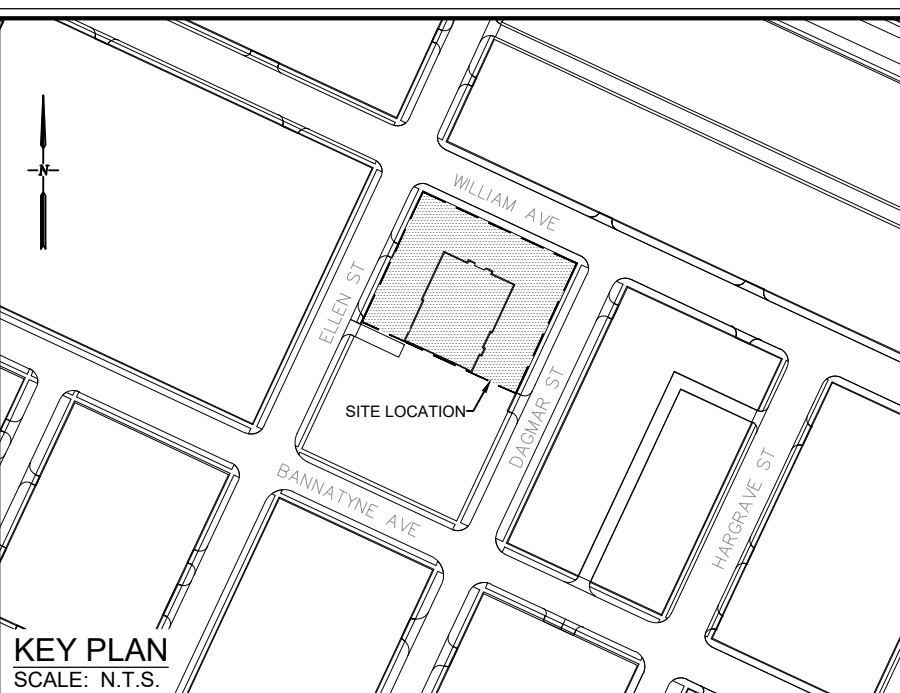
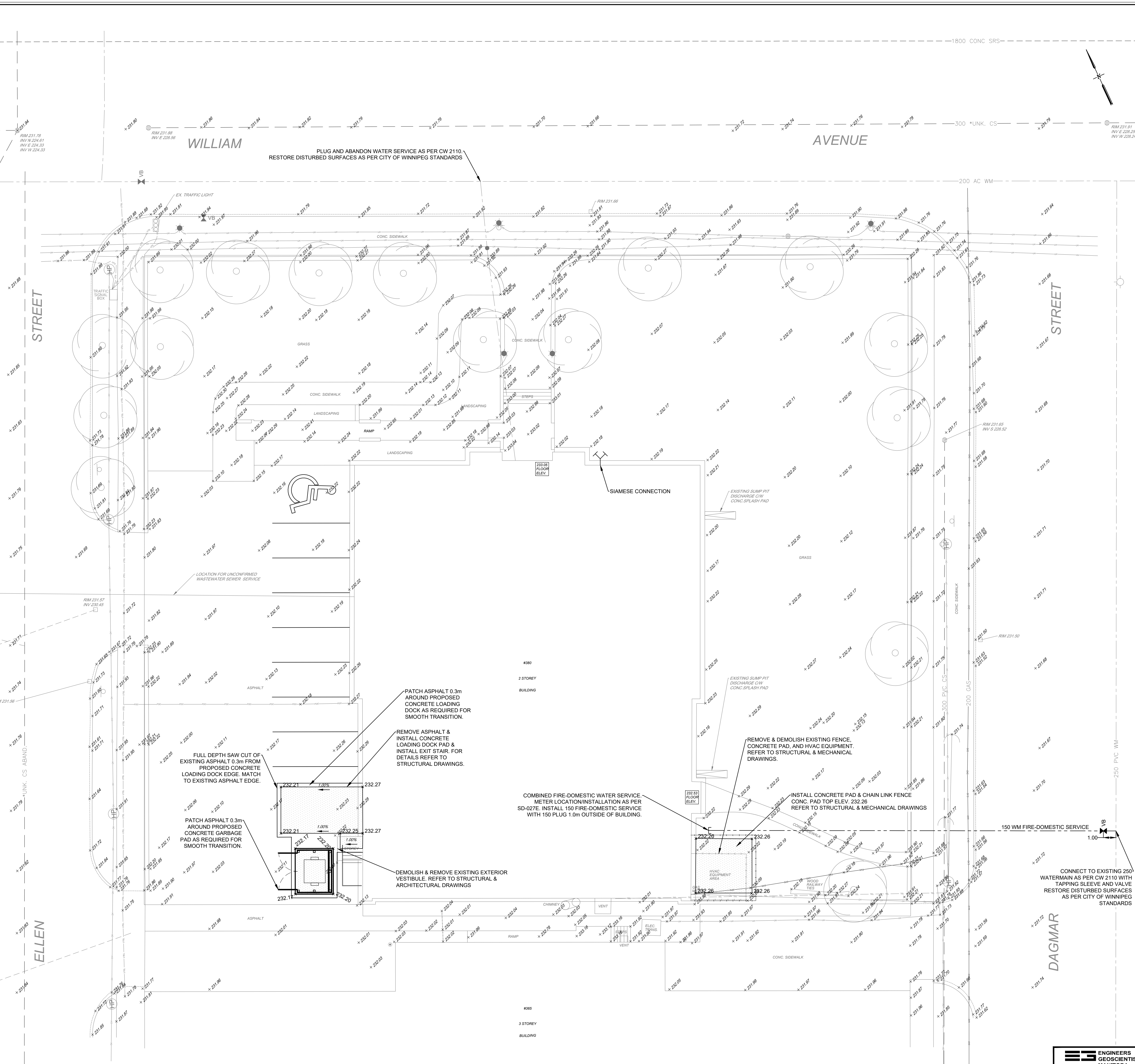

EXISTING	DESCRIPTION	PROPOSED
	SANITARY SEWER	
	STORM SEWER	
	WATERMAIN	
	UNDERGROUND HYDRO	
	OVERHEAD HYDRO	
	GAS	
	FIBER OPTIC	
	UNDERGROUND TELEPHONE	
	UNDERGROUND TRAFFIC	
	FENCE	
	VALVE & BOX	
	SANITARY MAINTENANCE HOLE	
	STORM MAINTENANCE HOLE	
	CATCH BASIN	
	HYDRANT	
	BENCHMARK	
	TREE	
	LIGHT STANDARD	
	HYDRO POLE	
	GUY WIRE	
	SIGN	
	ELEVATION POINT	
	BOLLARD	
	CURB STOP	
	TEE	
	PLUG	
	CONCRETE	
	ASPHALT	

## BENCHMARK INFO

ELEVATIONS ARE RELATIVE TO THE CITY OF WINNIPEG BENCHMARK 35-44 ON THE WEST SIDE OF ELLEN STREET.

## Notes

1. This drawing is the exclusive property of R. J. Burnside & Associates Limited. The reproduction of any part without prior written consent of this office is strictly prohibited.
2. The contractor shall verify all dimensions, levels, and datums on site and report any discrepancies or omissions to this office prior to construction.
3. This drawing is to be read and understood in conjunction with all other plans and documents applicable to this project.

## CONSTRUCTION

No.	Issue / Revision	Date	Auth.
1	ISSUED FOR CONSTRUCTION	2025/02/04	RE



**BURNSIDE**

R.J. Burnside & Associates Limited  
307 Commerce Drive  
Winnipeg, Manitoba, R3P 1B3  
telephone 1-800-265-9662  
web www.rjburnside.com

Client  
**MCM ARCHITECTS INC.**  
141 ST ANNE'S ROAD  
WINNIPEG, MB  
R2M 2Z3

Drawing Title  
**CITY OF WINNIPEG - ARCHIVES  
REDEVELOPMENT  
ABOVE & UNDERGROUND GENERAL PLAN**

**ENGINEERS  
GEO-SCIENTISTS  
MANITOBA**  
Certificate of Authorization  
R.J. Burnside & Associates Limited  
No. 4280

Drawn	Checked	Designed	Checked	Date	Drawing No.
MJS/JP	RE	MJS	RE	2024/03/01	
Project No. 300057912		Contract No.		Revision No. 1	

Scale

1:150

**C101**