

- NOTES**
- ADJUST MH AND CB RIMS TO NEW GRADES.
  - LAMP STANDARDS, HYDRO POLES, AND ANCHORS THAT REQUIRE TEMPORARY SUPPORT, REMOVAL OR REPLACEMENT, TO BE DONE SO AT THE EXPENSE OF THE CONTRACTOR AS NECESSARY.
  - CONTRACTOR TO TAKE PRECAUTIONARY STEPS TO PROTECT EXISTING TREES WITHIN THE LIMITS OF CONSTRUCTION FROM DAMAGE FROM CONSTRUCTION ACTIVITIES AS OUTLINED IN THE SPECIFICATIONS.
  - CONTRACTOR TO CONFIRM THE LOCATION OF ALL UTILITIES/SERVICES IN THE FIELD PRIOR TO CONSTRUCTION.
  - ADD 200.000 m TO ABBREVIATED ELEVATIONS TO OBTAIN GEODETIC ELEVATIONS.

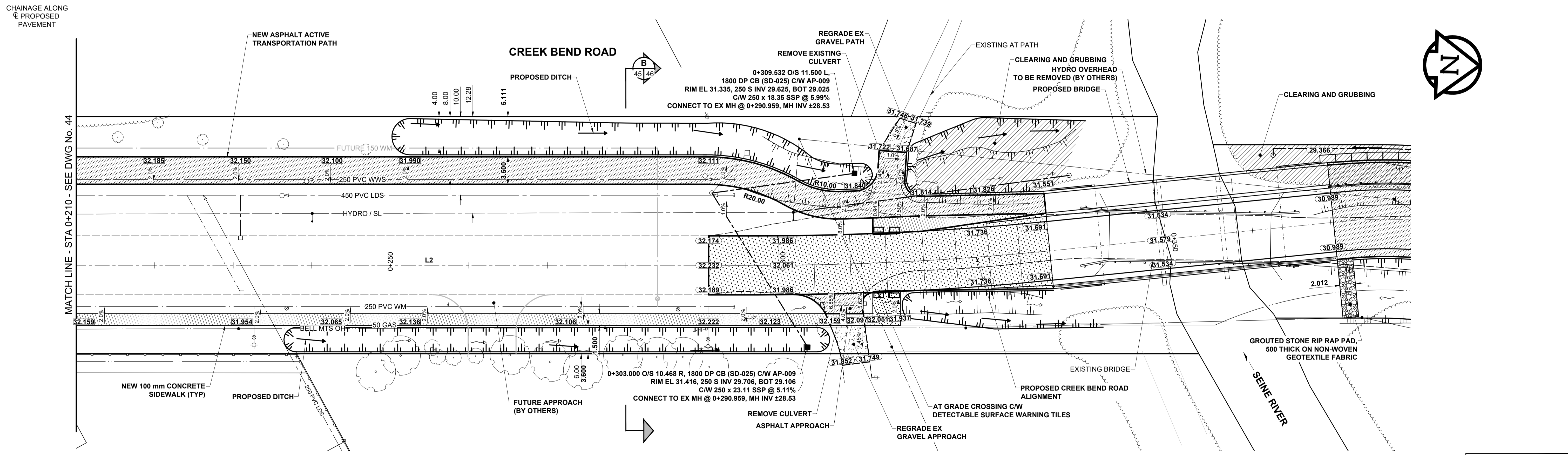

**METRIC**  
WHOLE NUMBERS INDICATE MILLIMETRES  
DECIMALIZED NUMBERS INDICATE METRES

**PLAN**  
SCALE: 1:250

0 5 10 15m

EXISTING	LEGEND - PLAN	NEW	EXISTING	LEGEND - PLAN	NEW	EXISTING	LEGEND - PLAN	NEW	
	GAS		MANHOLE		CONCRETE PAVEMENT		LOCATION APPROVED		BM 78-009
	MTS HANDWELL/PEDESTAL		CATCH BASIN/CATCH PIT		CONC SIDEWALK/MEDIAN		UNDERGROUND STRUCTURES		N.W. Cor. Paddington Rd. & Dakota St., 19 mm dia. x 6.1 m
	HYDRO HANDWELL/CABINET		CURB INLET WITH BOX		ASPHALT PAVEMENT		SUPR. U/G STRUCTURES		I.B. in Valve Box, 5.5 m S. of N.L. Paddington Rd. & on W.L. of Dakota St. in traffic island.
	CATV/FIBRE OPTIC		TREE		PAVING STONE		DATE		PROFESSIONAL'S SEAL
	TRAFFIC SIGNALS/PIT		TEST HOLE		GRAVEL		NOTE:		REGISTERED PROFESSIONAL ENGINEER
	LAND DRAINAGE SEWER		PROPERTY LINE		RAMP CURB		LOCATION OF UNDERGROUND STRUCTURES AS SHOWN ARE BASED ON THE BEST INFORMATION AVAILABLE BUT NO GUARANTEE IS GIVEN THAT ALL EXISTING UTILITIES ARE SHOWN OR THAT THE GIVEN LOCATIONS ARE EXACT. CONFIRMATION OF EXISTENCE AND EXACT LOCATION OF ALL SERVICES MUST BE OBTAINED FROM THE INDIVIDUAL UTILITIES BEFORE PROCEEDING WITH CONSTRUCTION.		CONSULTANT FILE NAME
	SANITARY/COMBINED SEWER		SURVEY BAR		PLANING/REMOVAL		COMMITTEE		MORRISON HERSHFIELD
	CB LEAD/SSP/DCP		FENCE				DESIGNED BY		CHECKED BY
	WATERMAIN		BOC/EDGE OF PAVEMENT				DRAWN BY		APPROVED BY
	SUBDRAIN		ELEVATION (33.333)				HOR SCALE		VERT SCALE
	DITCH		TRAFFIC SIGN				REVISIONS		DATE
	LEGEND - PLAN		LEGEND - PLAN				DATE		DATE

**THE CITY OF WINNIPEG**  
PUBLIC WORKS DEPARTMENT  
ENGINEERING DIVISION

**CREEK BEND ROAD BRIDGE REPLACEMENT AND RELATED WORKS**

CITY DRAWING NUMBER: P-3567-03  
SHEET OF: 45 OF 51  
DRAWING NUMBER: 45

**CREEK BEND ROAD SIDEWALK AND MULTI-USE PATH STA 0+210 TO SEINE RIVER**

DESIGNED BY: ACK  
CHECKED BY: JGK  
DRAWN BY: KMB  
APPROVED BY: RPB  
HOR SCALE: 1:250  
VERT SCALE: 1:10  
DATE: JUNE 27, 2023

PROFESSIONAL'S SEAL  
PROVINCE OF MANITOBA  
J.G. KENNEDY  
Member  
22326  
CONSULTANT FILE NAME  
2203665-Creek Bend-PP-03.dwg

ENGINEERS GEOSCIENTISTS MANITOBA  
Certificate of Authorization  
MORRISON HERSHFIELD  
No. 1736  
TENDER No. 335-2023