

**4 LANE TYPICAL CROSS SECTION**  
NTS

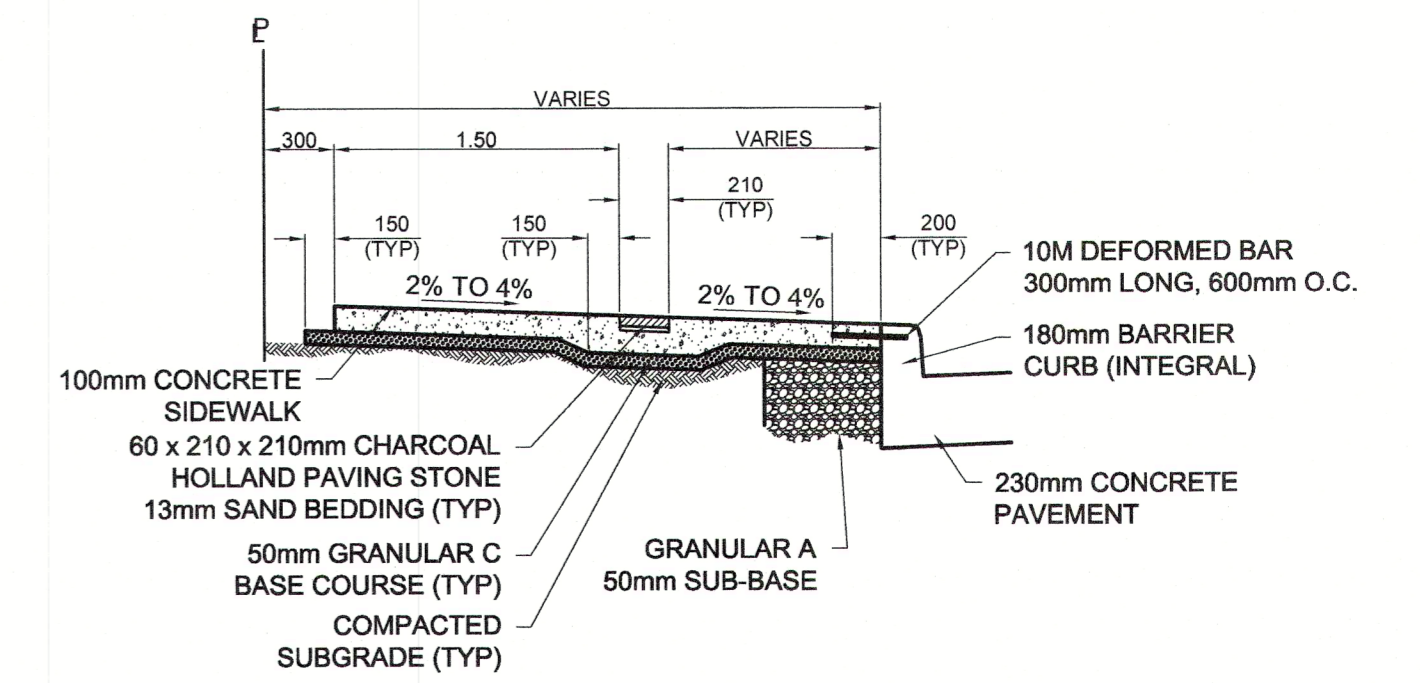

**100mm CONCRETE SIDEWALK WITH PAVING BAND**  
NTS

**REFERENCE NOTES:**

- PAVEMENT DIMENSIONS ARE TO BACK OF CURB
- BASELINE IS CENTRE LINE ROADWAY
- PROPERTY LINES OBTAINED FROM CITY OF WINNIPEG L.B.I.S., AND NO SCALE FACTOR WAS APPLIED
- REFER TO AECOM FIELD BOOK NO. 5111

**CONSTRUCTION NOTES:**

- REMOVE EXISTING PAVEMENT AND CONSTRUCT NEW 230mm PLAIN DOWELED CONCRETE PAVEMENT
- REMOVE EXISTING ASPHALT PAVEMENT AND CONSTRUCT NEW 75mm TYPE 1A ASPHALT PAVEMENT
- CONSTRUCT NEW 200mm REINFORCED CONCRETE PAVEMENT
- CONSTRUCT NEW BARRIER CURB (180mm HT. INTEGRAL)
- INSULATE EXISTING WATER MAIN/WATER SERVICE WITHIN PAVEMENT EXCAVATION AS PER SD-018
- CONSTRUCT NEW MODIFIED BARRIER CURB (180mm HT. INTEGRAL)
- CONSTRUCT NEW CURB RAMP (10-12mm HT. INTEGRAL)
- REMOVE EXISTING SIDEWALK AND CONSTRUCT NEW 100mm CONCRETE SIDEWALK c/w BLOCKOUT AND PAVING STONES
- REMOVE EXISTING CATCHBASIN/CATCHPIT AND ABANDON LEAD
- INSTALL NEW CURB AND GUTTER INLET c/w 1800mm CATCHBASIN (SD-024) AND CONNECT NEW 250mm LEAD TO EXISTING 1800 CONCRETE COMBINED SEWER
- INSTALL 150mm SUBDRAIN 6.0m ON EACH SIDE OF CATCHBASIN
- REMOVE EXISTING FRAME AND COVER AND INSTALL NEW FRAME AND SOLID COVER (AP-006/AP-007)
- ADJUST EXISTING MANHOLE/CATCHBASIN TO GRADE
- INSTALL NEW CAST IRON RISER RING
- ADJUST EXISTING WATER VALVE BOX TO GRADE

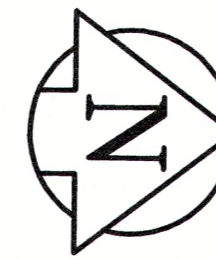
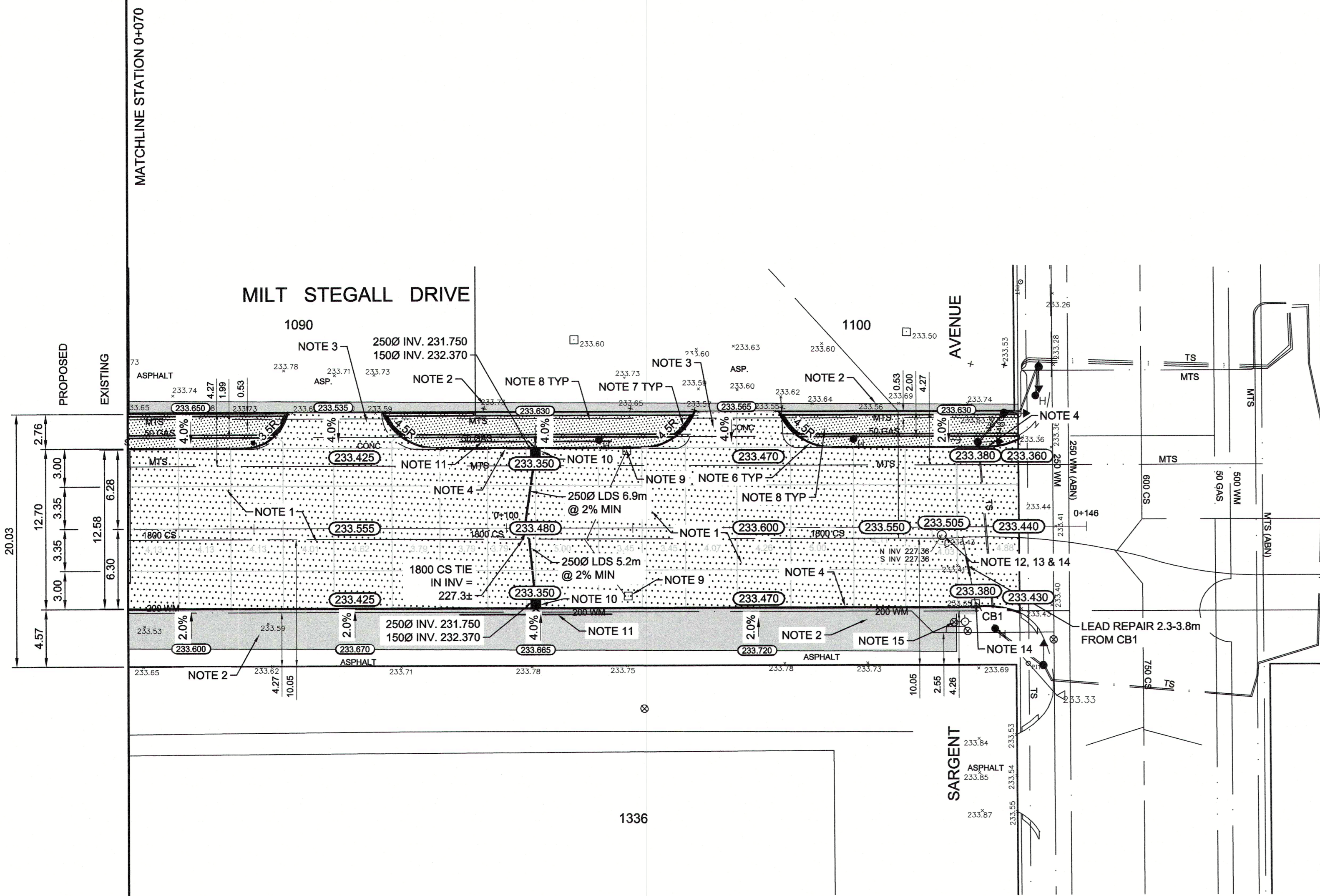

**ENGINEERS  
GEOLOGISTS  
MANITOBA**  
Certificate of Authorization  
AECOM Canada Ltd.  
No. 4671 Date: 11/15/22

**METRIC**  
WHOLE NUMBERS INDICATE MILLIMETRES  
DECIMALIZED NUMBERS INDICATE METRES

EXISTING	LEGEND - PLAN	PROPOSED	EXISTING	LEGEND - PLAN	PROPOSED	EXISTING	LEGEND - PROFILE	PROPOSED
150mm W.M.	WATERMAIN	150mm W.M.	---	HYDRO	---	---	Q PROFILE	---
300mm L.D.S.	LAND DRAINAGE SEWER	300mm L.D.S.	---	CONCRETE	---	---	EAST GUTTER	---
250mm W.W.S.	WASTEWATER SEWER	250mm W.W.S.	---	ASPHALT	---	---	WEST GUTTER	---
○	MANHOLE	●	---	PROPERTY LINE	---	---	S PROPERTY LINE	---
□	CATCH BASIN	■	---	SURVEY BAR	---	---	N PROPERTY LINE	---
▽	CATCH PIT	▼	---	ELEVATION	(235.750)	---		
+	JUNCTIONS	+	---	TREE	---	---		
---	CULVERT	---	---	SIDEWALK RAMP	---	---		
---	GAS	---	---	CONCRETE SIDEWALK	---	---		
---		---	---	FENCE	---	---		

**LOCATION APPROVED UNDERGROUND STRUCTURES**  
SUPV. U/G STRUCTURES COMMITTEE DATE  
**NOTE:**  
LOCATION OF UNDERGROUND STRUCTURES AS SHOWN ARE BASED ON THE BEST INFORMATION AVAILABLE, BUT NO GUARANTEE IS GIVEN THAT THE GIVEN LOCATIONS ARE EXACT CONFIRMATION OF EXISTENCE AND EXACT LOCATION OF ALL SERVICES MUST BE OBTAINED FROM THE INDIVIDUAL UTILITIES BEFORE PROCEEDING WITH CONSTRUCTION.

NO.	REVISIONS	DATE	BY
0	ISSUED FOR TENDER	03/15/22	BC
A	ISSUED FOR REVIEW	02/11/22	BC

**AECOM**  
DESIGNED BY: BC CHECKED BY: RC  
DRAWN BY: JT APPROVED BY: RC  
HOR. SCALE: 1:250  
VERTICAL: 1:10  
ISSUED FOR TENDER: 03/15/22  
ISSUED FOR REVIEW: 02/11/22

ENGINEER'S SEAL  
PROVINCE OF MANITOBA  
R.T. CUNNINGHAM  
Member  
24711  
REGISTERED PROFESSIONAL ENGINEER

**THE CITY OF WINNIPEG**  
PUBLIC WORKS DEPARTMENT  
ENGINEERING DIVISION  
2022 INDUSTRIAL STREET RENEWAL PROGRAM  
MILT STEGALL DRIVE - STATION 0+070 TO SARGENT AVENUE  
CONCRETE RECONSTRUCTION  
PLAN/PROFILE  
CITY DRAWING NUMBER: SHEET 10 OF 20