

100 ASPHALT (TYPE 1A)  
75 BASE COURSE MATERIAL  
300 CRUSHED SUB BASE MATERIAL  
(MAX. SIZE 50mm)  
NON WOVEN GEOTEXTILE

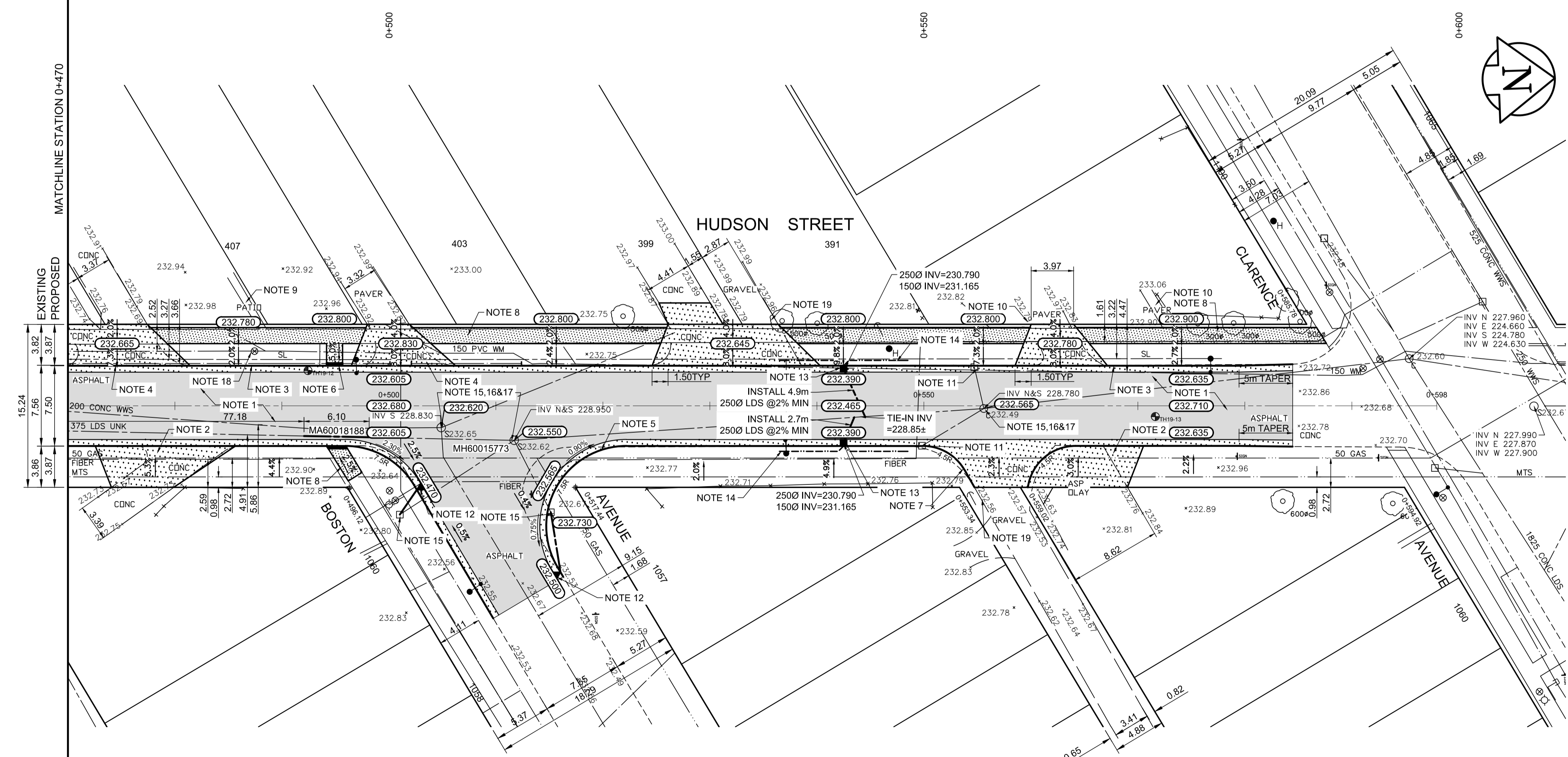

- REFERENCE NOTES**
- PAVEMENT DIMENSIONS ARE TO BACK OF CURB
  - BASELINE IS CENTRE LINE RIGHT-OF-WAY
  - PROPERTY LINES OBTAINED FROM CITY OF WINNIPEG L.B.I.S., AND NO SCALE FACTOR WAS APPLIED
  - REFER TO AECOM FIELD BOOK NO. 5034

- CONSTRUCTION NOTES**
- REMOVE EXISTING CONCRETE AND ASPHALTIC PAVEMENT AND CONSTRUCT NEW ASPHALTIC PAVEMENT TYPE 1A (100mm)
  - REMOVE EXISTING CONCRETE PAVEMENT AND CONSTRUCT NEW 150mm REINFORCED CONCRETE PAVEMENT
  - CONSTRUCT NEW BARRIER CURB AND GUTTER (600mm WIDTH, 180mm HT.)
  - CONSTRUCT NEW LIP CURB AND GUTTER (40mm HT. INTEGRAL)
  - CONSTRUCT NEW MODIFIED BARRIER CURB AND GUTTER (600mm WIDTH, 180mm HT.)
  - CONSTRUCT NEW CURB RAMP CURB AND GUTTER (10mm HT. INTEGRAL)
  - CONSTRUCT NEW MODIFIED BARRIER CURB (180mm HT. INTEGRAL)
  - RENEW EXISTING 100mm CONCRETE SIDEWALK
  - REMOVE AND REINSTALL EXISTING PATIO BLOCKS TO GRADE
  - REMOVE AND REINSTALL EXISTING PAVING STONES
  - REMOVE EXISTING CATCHBASIN AND ABANDON LEAD
  - INSTALL NEW CURB AND GUTTER INLET c/w CATCHPIT (SD-023) AND CONNECT TO EXISTING CATCHBASIN
  - INSTALL NEW CURB AND GUTTER INLET c/w CATCHBASIN 1800mm (SD-024) AND CONNECT TO EXISTING MANHOLE
  - INSTALL 150mm SUBDRAIN
  - ADJUST EXISTING MANHOLE/CATCHBASIN TO GRADE
  - REMOVE EXISTING FRAME AND COVER AND INSTALL NEW FRAME AND SOLID COVER (AP-006 AND AP-007)
  - INSTALL NEW CAST IRON RISER RING
  - ADJUST EXISTING WATER VALVE TO GRADE
  - REGRADE EXISTING GRAVEL

**AECOM**  
Certificate of Authorization  
AECOM Canada Ltd.  
No. 4671 Date: \_\_\_\_\_

**METRIC**  
WHOLE NUMBERS INDICATE MILLIMETRES  
DECIMALIZED NUMBERS INDICATE METRES

150 mm W.M.	WATERMAIN	150 mm W.M.	HYDRO	— x —	PROFILE
Hydrant	HYDRANT	Manhole	M.T.S.	— □ —	WEST GUTTER
Valve	VALVE	Survey Bar	CONCRETE	— ○ —	EAST GUTTER
300mm L.D.S.	LAND DRAINAGE SEWER	Elevation	ASPHALT	— ◇ —	N/W PROPERTY LINE
250mm W.W.S.	WASTEWATER SEWER	Tree	PROPERTY LINE	— ○ —	S/E PROPERTY LINE
Manhole	MANHOLE	Sidewalk Ramp	SURVEY BAR		
Catch Basin	CATCH BASIN	Concrete Sidewalk	ELEVATION (235.750)		
Catch Pit	CATCH PIT	Fence	TREE		
Junctions	JUNCTIONS		SIDEWALK RAMP		
Culvert	CULVERT		CONCRETE SIDEWALK		
Gas	GAS		FENCE		
EXISTING	LEGEND - PLAN	PROPOSED	EXISTING	LEGEND - PROFILE	PROPOSED

**LOCATION APPROVED UNDERGROUND STRUCTURES**

SUPV. U/G STRUCTURES COMMITTEE DATE

**NOTE:**  
LOCATION OF UNDERGROUND STRUCTURES AS SHOWN ARE BASED ON THE BEST INFORMATION AVAILABLE. BUT NO GUARANTEE IS GIVEN THAT ALL EXISTING UTILITIES ARE SHOWN OR THAT THE GIVEN LOCATIONS ARE EXACT. CONFIRMATION OF EXISTENCE AND EXACT LOCATION OF ALL SERVICES MUST BE OBTAINED FROM THE INDIVIDUAL UTILITIES BEFORE PROCEEDING WITH CONSTRUCTION.

B.M.	64-024	N.W. Cor. Clarence Ave. & Pembina Hwy.,
ELEV.	232.552	Tilt in S. Conc foundation of Pembina Plaza,
		No. 1445 Pembina Hwy., 4.0m W. & 0.1m below
		stucco of S.E. Cor. of Bldg.
NO.	REVISIONS	DATE BY
0	ISSUED FOR TENDER	05/02/2019 KWR
A	ISSUED FOR REVIEW	03/15/2019 BC

**AECOM**

DESIGNED BY	SS	CHECKED BY	BC/KWR
DRAWN BY	SS	APPROVED BY	
HOR. SCALE:	1:250	RELEASED FOR CONSTRUCTION BY:	
VERTICAL:	1:10	DATE	

ENGINEER'S SEAL  
PROVINCE OF MANITOBA  
**K.W. RAE**  
REGISTERED PROFESSIONAL ENGINEER

**THE CITY OF WINNIPEG**  
PUBLIC WORKS DEPARTMENT  
ENGINEERING DIVISION

2019 LOCAL STREET RENEWAL PROGRAM

HUDSON STREET - CHEVRIER BOULEVARD TO CLARENCE AVENUE  
PAVEMENT RECONSTRUCTION  
STATION 0+470 TO CLARENCE AVENUE

CITY DRAWING NUMBER  
SHEET 07 OF 17

CONSULTANT DRAWING NO. CT-07