

MAIN FLOOR PLAN
SCALE: 1 : 30

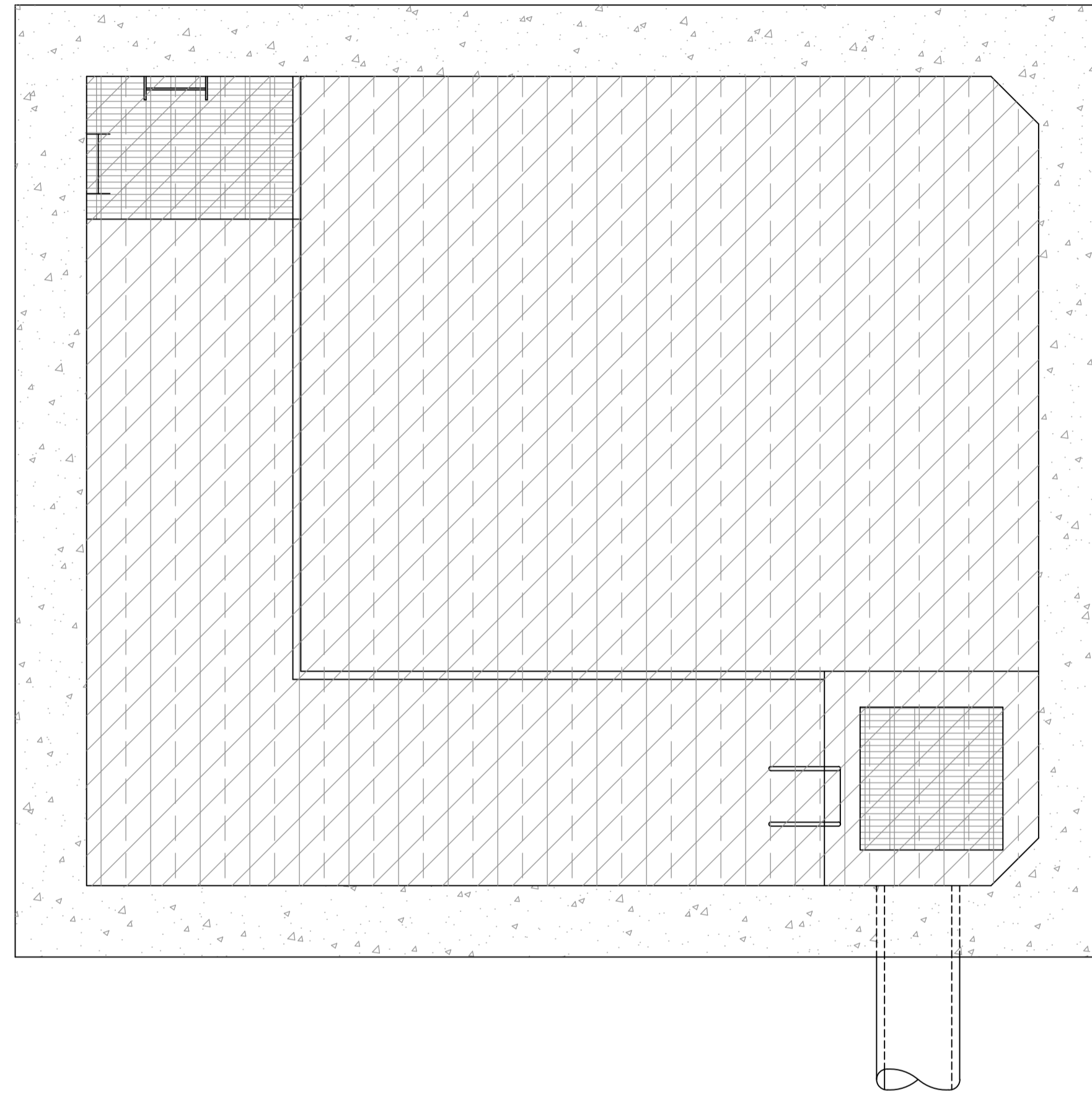

WET WELL PLAN
SCALE: 1 : 30

SPECIFIC NOTES:

- ① THE REQUIRED TEMPERATURE CODE FOR ALL HAZARDOUS LOCATIONS ON THIS DRAWING IS T2A (280°C).
- ② THE MAIN FLOOR IS PROVIDED WITH 6 ACH OF CONTINUOUS VENTILATION, WITH UP TO 75% RECIRCULATION IN COLD WEATHER TO CONSERVE HEAT.
- ③ THE WETWELL IS A CATEGORY 1 (WET) AND ZONE 2, GROUP IIA LOCATION.

LEGEND

	HAZARDOUS ZONE 1, GROUP IIA
	HAZARDOUS ZONE 2, GROUP IIA
	CATEGORY 1 (MOISTURE)
	CATEGORY 2 (CORROSIVE)
	CATEGORY 2 WET (MOISTURE & CORROSIVE)

DRAWING NUMBER	REFERENCE DRAWINGS
----------------	--------------------



NO.	REVISIONS	DATE	DESIGN	CHECK
00	ISSUED FOR TENDER, BID OPP: 475-2018	2018/05/09	BC	PP

 SNC-LAVALIN INC. 148 Nature Park Way Winnipeg, MB, Canada R3P 0X7 204-786-8080	
DESIGNED BY: B. CLEVEN	CHECKED BY: P. PANUFNIK
DRAWN BY: Y. KONIG	APPROVED BY: B. CLEVEN
SCALE: 1:30	ISSUED FOR CONSTRUCTION BY: DATE:
DATE: 2017/08/22	DATE:
CONSULTANT NO.:	

ENGINEER'S SEAL

**PRELIMINARY
NOT TO BE
USED FOR
CONSTRUCTION**

 THE CITY OF WINNIPEG WATER AND WASTE DEPARTMENT	
METRO ROUTE 20 UNDERPASS PUMPING STAION 2018 UPGRADES HAZARDOUS AND WET LOCATION PLAN	
CITY DRAWING NUMBER 1-0309U-E0006	SHEET REV. SIZE 001 00 A1