

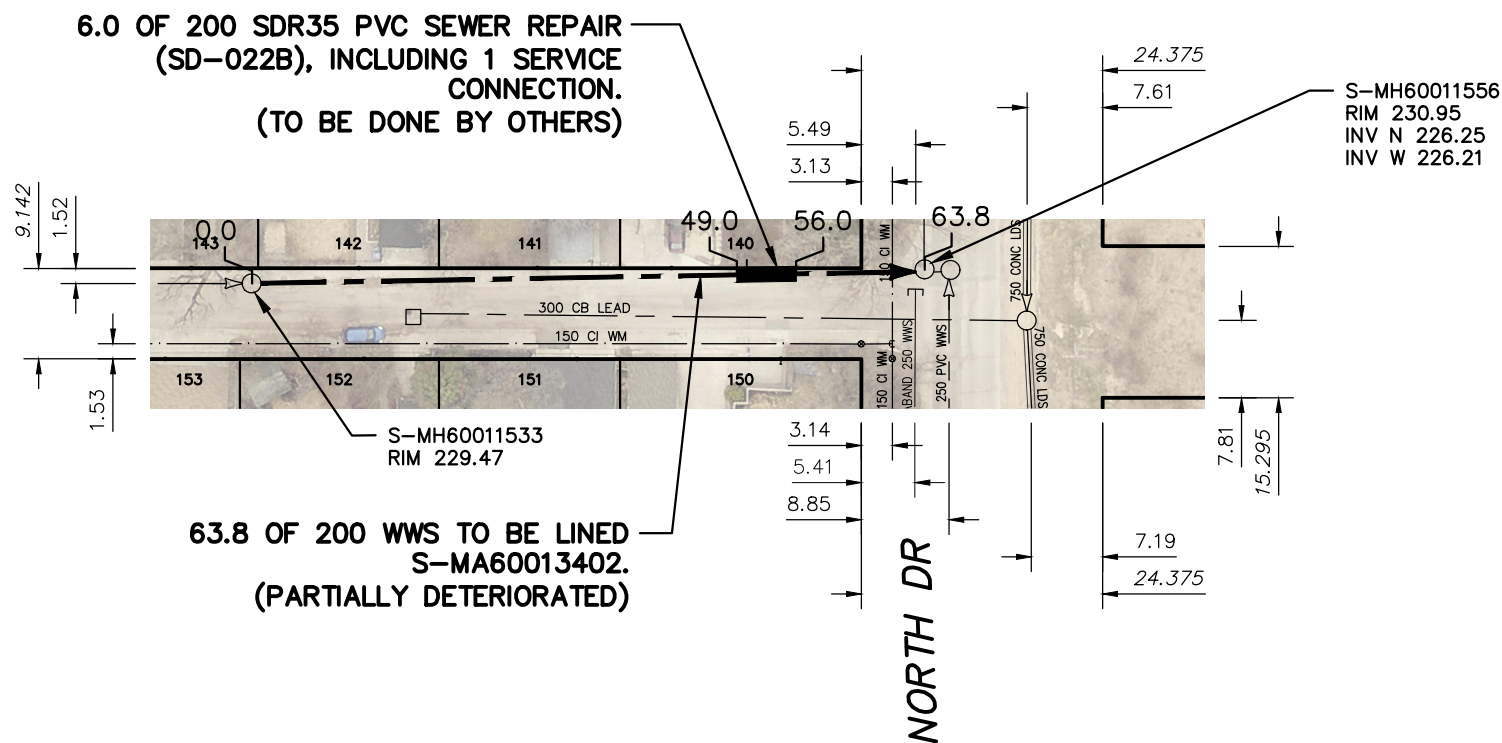

WILDWOOD C PARK (S-LEG)



SEWER JUNCTION INFORMATION FROM SEWER VIDEO INSPECTION SEWER ID S-MA60013402		
DISTANCE FROM MH ID S-MH60011533		
DISTANCE	DIAMETER	CLOCK
7.1	150	2
9.6	150	1
10.8	150	9
27.0	150	9
30.8	150	3
42.2	150	10
50.0	150	3

WARNING

IF POWER EQUIPMENT OR EXPLOSIVES
ARE TO BE USED FOR EXCAVATION ON
THIS PROJECT THE CONTRACTOR MUST:

- 1) NOTIFY THE GAS COMPANY OF THE
PROPOSED LOCATION OF EXCAVATION.
- 2) TAKE PRECAUTION TO AVOID DAMAGE
TO GAS COMPANY INSTALLATIONS.

SEE PROVINCIAL REGULATION 210/72 FOR DETAILS

FOR INDEX SEE
11697

METRIC

WHOLE NUMBERS INDICATE MILLIMETRES
DECIMALIZED NUMBERS INDICATE METRES

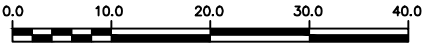

LOCATION APPROVED UNDERGROUND STRUCTURES		B.M. ELEV.		ENGINEER'S SEAL		 THE CITY OF WINNIPEG WATER AND WASTE DEPARTMENT ENGINEERING DIVISION	
SUPV. U/G STRUCTURES COMMITTEE		DATE		ORIGINAL SIGNED BY S.R.J COURNOYER 18/05/14			
NOTE: LOCATION OF UNDERGROUND STRUCTURES AS SHOWN ARE BASED ON THE BEST INFORMATION AVAILABLE BUT NO GUARANTEE IS GIVEN THAT ALL EXISTING UTILITIES ARE SHOWN OR THAT THE GIVEN LOCATIONS ARE EXACT. CONFIRMATION OF EXISTENCE AND EXACT LOCATION OF ALL SERVICES MUST BE OBTAINED FROM THE INDIVIDUAL UTILITIES BEFORE PROCEEDING WITH CONSTRUCTION.		DESIGNED BY SC		CHECKED BY SC		2017 SEWER MAIN RENEWALS BY AUGMENTATION WILDWOOD C PARK (S-LEG) 1ST MH W NORTH DRIVE TO MH AT NORTH DRIVE	
		DRAWN BY AJ		APPROVED BY KZ			
		SCALE: HORIZONTAL 1:750 VERTICAL		RELEASED FOR CONSTRUCTION K.ZUREK		CONSULTANT DRAWING NUMBER -	
NO.		REVISIONS		DATE 2018 05 16		DATE 2018 05 14	
				PLOT DATE: 2018 05 16		BID OPPORTUNITY: 112-2018 CONTRACT NUMBER: 5	
						R: \DRAWINGS\SEWER\2017 RENEWALS\CIPP-FSR-EPR\Cont. 5\CONSTRUCTION DWGS\ WILDWOOD C PK (SLEG).dwg	

SHEET 51 OF 53

CITY DRAWING NUMBER

11745