

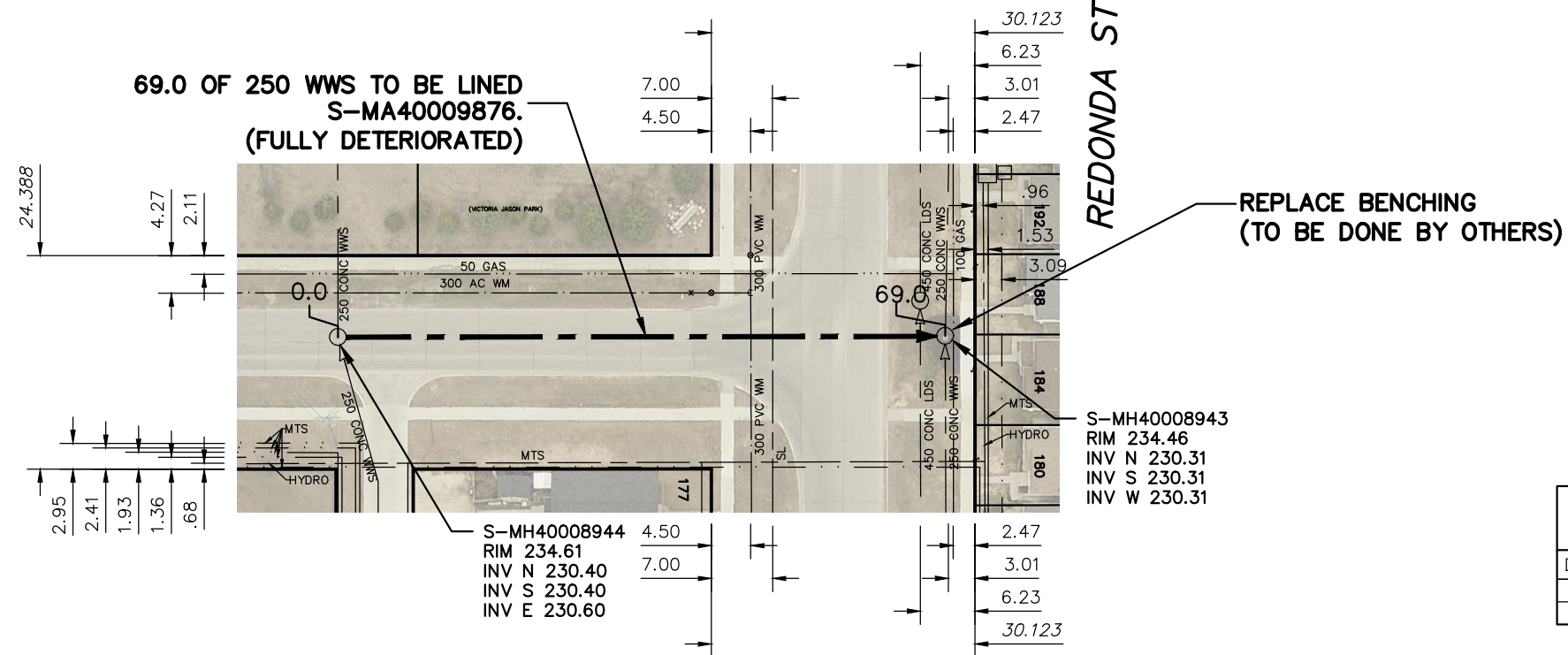

# VICTORIA AVENUE EAST



SEWER JUNCTION INFORMATION FROM SEWER VIDEO INSPECTION		
SEWER ID S-MA40009876		
DISTANCE FROM MH ID S-MH40009876		
DISTANCE	DIAMETER	CLOCK
NO SERVICE JUNCTIONS		

## WARNING

IF POWER EQUIPMENT OR EXPLOSIVES  
ARE TO BE USED FOR EXCAVATION ON  
THIS PROJECT THE CONTRACTOR MUST:

- 1) NOTIFY THE GAS COMPANY OF THE  
PROPOSED LOCATION OF EXCAVATION.
- 2) TAKE PRECAUTION TO AVOID DAMAGE  
TO GAS COMPANY INSTALLATIONS.

SEE PROVINCIAL REGULATION 210/72 FOR DETAILS

FOR INDEX SEE  
11697

## METRIC

WHOLE NUMBERS INDICATE MILLIMETRES  
DECIMALIZED NUMBERS INDICATE METRES

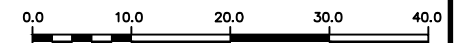

### LOCATION APPROVED UNDERGROUND STRUCTURES

SUPV. U/G STRUCTURES  
COMMITTEE

DATE

#### NOTE:

LOCATION OF UNDERGROUND STRUCTURES AS  
SHOWN ARE BASED ON THE BEST INFORMATION  
AVAILABLE BUT NO GUARANTEE IS GIVEN THAT ALL  
EXISTING UTILITIES ARE SHOWN OR THAT THE GIVEN  
LOCATIONS ARE EXACT. CONFIRMATION OF  
EXISTENCE AND EXACT LOCATION OF ALL  
SERVICES MUST BE OBTAINED FROM THE INDIVIDUAL  
UTILITIES BEFORE PROCEEDING WITH CONSTRUCTION.

B.M.  
ELEV.

NO.	REVISIONS	DATE	BY

DESIGNED BY	SC	CHECKED BY	SC
DRAWN BY	RS	APPROVED BY	KZ
SCALE: HORIZONTAL VERTICAL	1: 750	RELEASED FOR CONSTRUCTION	K.ZUREK
DATE	2018 05 16	DATE	2018 05 14

PLOT DATE: 2018 05 16

ENGINEER'S SEAL

ORIGINAL SIGNED  
BY S.R.J COURNOYER  
18/05/14

CONSULTANT DRAWING NUMBER

-

BID OPPORTUNITY: 112-2018  
CONTRACT NUMBER: 5



## THE CITY OF WINNIPEG WATER AND WASTE DEPARTMENT ENGINEERING DIVISION

2017 SEWER MAIN RENEWALS  
BY AUGMENTATION  
**VICTORIA AVENUE EAST**  
1ST MH W OF REDONDA STREET TO  
MH AT REDONDA STREET

SHEET 46 OF 53

CITY DRAWING NUMBER

11740

FILE PATH: R:\DRAWINGS\SEWER\2017 RENEWALS\CIPP-FSR-EPR\Cont. 5\CONSTRUCTION DWGS\  
FILE NAME: VICTORIA AVE E.dwg