

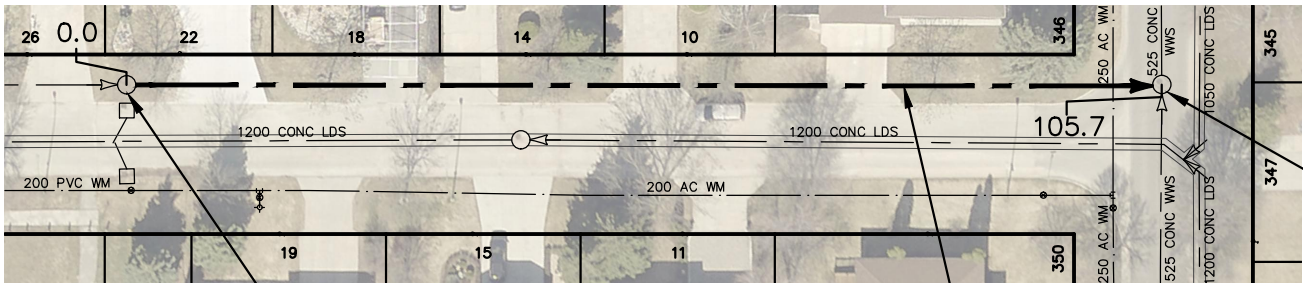

MILDRED STREET

KNOWLES AVE



S-MH40000453
RIM 229.70
INV N 224.47
INV S 224.47

S-MH40000455
RIM 230.12
INV E 224.21
INV S 224.21
INV W 224.21

105.7 OF 250 WWS TO BE LINED
S-MA40000505.
(PARTIALLY DETERIORATED)

SEWER JUNCTION INFORMATION FROM SEWER VIDEO INSPECTION		
SEWER ID S-MA40000505		
DISTANCE FROM MH ID S-MH40000453		
DISTANCE	DIAMETER	CLOCK
7.4	150	10
16.7	150	2
22.8	150	11
36.5	150	2
41.2	150	11
56.5	150	1
58.0	150	11
80.2	200	12

WARNING

IF POWER EQUIPMENT OR EXPLOSIVES
ARE TO BE USED FOR EXCAVATION ON
THIS PROJECT THE CONTRACTOR MUST:

- 1) NOTIFY THE GAS COMPANY OF THE
PROPOSED LOCATION OF EXCAVATION.
- 2) TAKE PRECAUTION TO AVOID DAMAGE
TO GAS COMPANY INSTALLATIONS.

SEE PROVINCIAL REGULATION 210/72 FOR DETAILS

FOR INDEX SEE
11696

METRIC

WHOLE NUMBERS INDICATE MILLIMETRES
DECIMALIZED NUMBERS INDICATE METRES

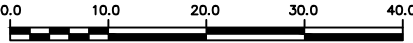

LOCATION APPROVED
UNDERGROUND STRUCTURES

SUPV. U/G STRUCTURES
COMMITTEE

DATE

NOTE:

LOCATION OF UNDERGROUND STRUCTURES AS
SHOWN ARE BASED ON THE BEST INFORMATION
AVAILABLE BUT NO GUARANTEE IS GIVEN THAT ALL
EXISTING UTILITIES ARE SHOWN OR THAT THE GIVEN
LOCATIONS ARE EXACT. CONFIRMATION OF
EXISTENCE AND EXACT LOCATION OF ALL
SERVICES MUST BE OBTAINED FROM THE INDIVIDUAL
UTILITIES BEFORE PROCEEDING WITH CONSTRUCTION.

B.M.
ELEV.

NO.	REVISIONS	DATE	BY

DESIGNED BY	SC	CHECKED BY	SC
DRAWN BY	BL	APPROVED BY	KZ
SCALE: HORIZONTAL VERTICAL	1: 750	RELEASED FOR CONSTRUCTION	K.ZUREK
DATE	2018 05 16	DATE	2018 05 14

ENGINEER'S SEAL

ORIGINAL SIGNED
BY S.R.J COURNOYER
18/05/14

CONSULTANT DRAWING NUMBER

-



THE CITY OF WINNIPEG
WATER AND WASTE DEPARTMENT
ENGINEERING DIVISION

2017 SEWER MAIN RENEWALS
BY CIPP LINING

MILDRED STREET
1ST MH S OF KNOWLES AVENUE TO
KNOWLES AVENUE

SHEET 21 OF 53

CITY DRAWING NUMBER

11716

PLOT DATE: 2018 05 16

BID OPPORTUNITY: 112-2018
CONTRACT NUMBER: 5

FILE PATH: R:\DRAWINGS\SEWER\2017 RENEWALS\CIPP-FSR-EPR\Cont. 5\CONSTRUCTION DWGS\New folder\
FILE NAME: MILDRED ST.dwg