

TAYLOR AVENUE WESTBOUND

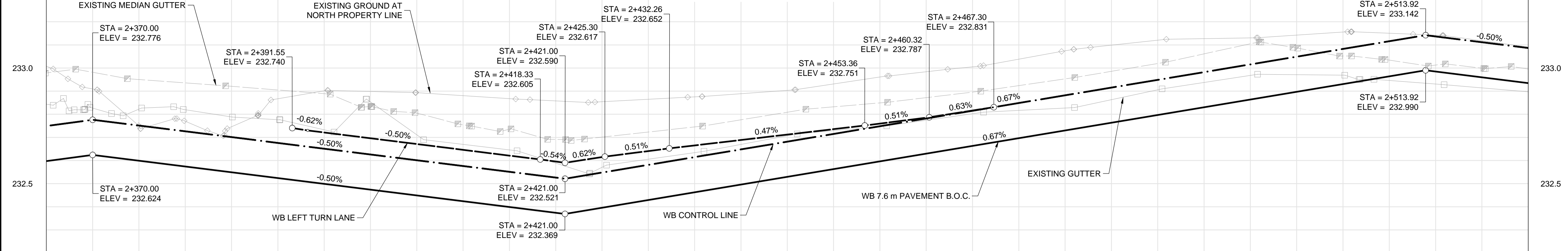

TAYLOR AVENUE EASTBOUND

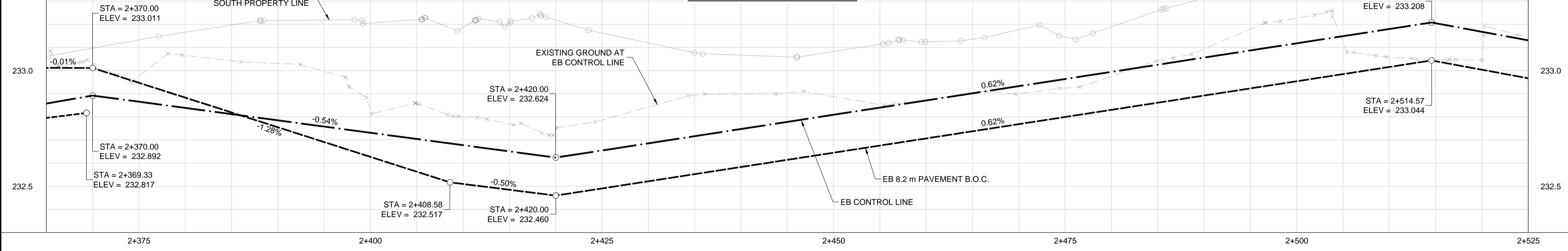

- CONSTRUCTION NOTES:**
- ISOLATE MISCELLANEOUS ITEMS IN NEW CONCRETE WORKS AS PER SD-228C.
  - LEGAL PLAN AND UNDERGROUND INFORMATION FROM CITY OF WINNIPEG L.B.S. CONTRACTOR VERIFY ALL UNDERGROUNDS IN THE FIELD.
  - CONTRACTOR TO TAKE PRECAUTIONARY STEPS TO AVOID DAMAGE FROM CONSTRUCTION ACTIVITIES TO TREES WITHIN THE LIMITS OF CONSTRUCTION.
  - LOCATION OF EXISTING SERVICES TO BE CONFIRMED IN THE FIELD BY THE CONTRACTOR.
  - INSTALL CB LEADS AT MIN. 1.0% SLOPE OR AS DIRECTED BY CONTRACT ADMINISTRATOR.
  - FOR CB LEADS, RIP RAP AND LDS INFORMATION SEE "CU" DRAWINGS.
  - CONTRACTOR SHALL CONFIRM EXISTING LEAD INVERT ELEVATIONS PRIOR TO INSTALLATION.

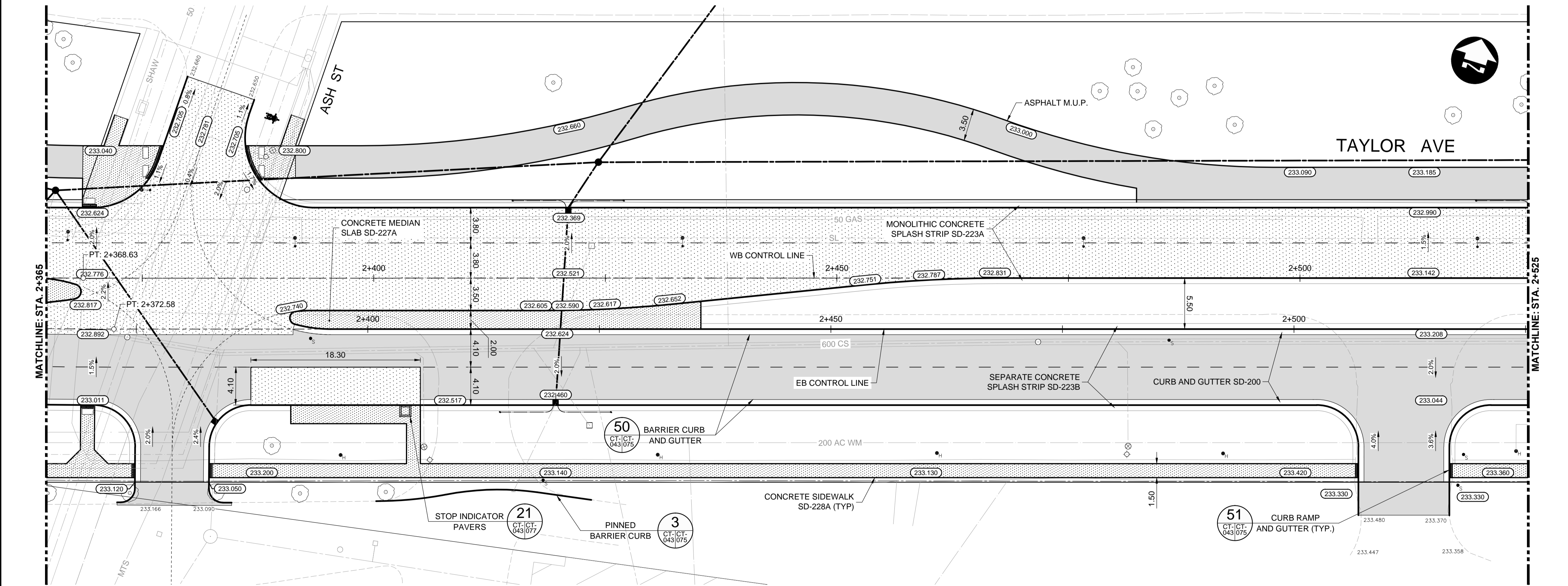

METRIC

WHOLE NUMBERS INDICATE MILLIMETRES  
DECIMAL NUMBERS INDICATE METRES

WARNING

- IF POWER EQUIPMENT OR EXPLOSIVES ARE TO BE USED FOR EXCAVATION ON THIS PROJECT THE CONTRACTOR MUST:
- NOTIFY THE GAS COMPANY OF THE PROPOSED LOCATION OF EXCAVATION.
  - TAKE PRECAUTION TO AVOID DAMAGE TO GAS COMPANY INSTALLATIONS SEE PROVINCIAL REGULATION 210/72 FOR DETAILS.
  - OBTAIN EXCAVATION PERMITS PRIOR TO CONSTRUCTION.



**Dillon Consulting Limited (MB)**  
No. 1789 Date: 17/01/09

**THE CITY OF WINNIPEG**  
PUBLIC WORKS DEPARTMENT

Waverley Street Underpass at CN Mile 3.89 Rivers Sub  
Contract 2: Underpass Structures, Railworks,  
Roadworks, Land Drainage Sewer, Pumping Station  
and Landscaping Works

TAYLOR AVENUE - STA. 2+365 TO 2+525  
(PLAN-PROFILE)

CITY DRAWING NUMBER: U-239-2016-C2-CT-043  
SHEET 043 OF 081  
CONSULTANT DRAWING NUMBER: C2-CT-043

EXISTING	LEGEND-PLAN	PROPOSED	EXISTING	LEGEND-PLAN	PROPOSED	EXISTING	LEGEND-PROFILE	PROPOSED
150 WM	WATERMAIN	150 WM	CONCRETE	CONCRETE	CONCRETE	150 WM	WATERMAIN	150 WM
300 WWS	WASTE WATER SEWER	300 WWS	ASPHALT	ASPHALT	ASPHALT	300 LDS	LAND DRAINAGE SEWER	300 LDS
250 WWS	WASTE WATER SEWER	250 WWS	PLANING	PLANING	PLANING	250 WWS	WASTE WATER SEWER	250 WWS
HYDRO	HYDRO	HYDRO	SIDEWALK	SIDEWALK	SIDEWALK	+	HYDRANT	+
MTS	M.T.S.	MTS	PAVING STONES	PAVING STONES	PAVING STONES	+	VALVE	+
100 GAS	GAS	100 GAS	PARTIAL DEPTH REPAIR	PARTIAL DEPTH REPAIR	PARTIAL DEPTH REPAIR	+	Q PROFILE	+
			PROPERTY LINE	PROPERTY LINE	PROPERTY LINE	+	NORTH/WEST GUTTER	+
			DRAINAGE ARROW	DRAINAGE ARROW	DRAINAGE ARROW	+	SOUTH/EAST GUTTER	+
			CURB RAMP (SD-229C)	CURB RAMP (SD-229C)	CURB RAMP (SD-229C)	+	NORTH/WEST DITCH	+
			DETECTABLE WARNING SURFACE TILE (SD-229AA)	DETECTABLE WARNING SURFACE TILE (SD-229AA)	DETECTABLE WARNING SURFACE TILE (SD-229AA)	+	SOUTH/EAST DITCH	+

UNDERGROUND STRUCTURES  
SUPPLY: U/G STRUCTURES DATE

LOCATION OF UNDERGROUND STRUCTURES AS SHOWN ARE BASED ON THE BEST INFORMATION AVAILABLE, BUT NO GUARANTEE IS GIVEN THAT ALL EXISTING UTILITIES ARE SHOWN OR THAT THE GIVEN LOCATIONS ARE EXACT. CONFIRMATION OF EXISTENCE AND EXACT LOCATION OF ALL SERVICES MUST BE OBTAINED FROM THE INDIVIDUAL UTILITIES BEFORE PROCEEDING WITH CONSTRUCTION.

B.M. ELEV. SEE SHEET C2-CT-007 FOR CONTROL POINT INFORMATION

DESIGNED BY: RTP CHECKED BY: DBW  
DRAWN BY: RD APPROVED BY: DBW

HOR. SCALE: 1:250  
VERTICAL: 1:10

ISSUED FOR TENDER: 17/01/09 DBW  
NO. REVISIONS: DATE BY

ENGINEER'S SEAL: D.B. WIEBE, Member 22480, Registered Professional Engineer, Province of Manitoba

CONSULTANT PROJECT NUMBER: 16-3353

G:\CAD\163353\Technical\Workspaces\Drawings and Figures\Roadworks\Contract\163353-C2-CON-CT-PLAN-PROFILE-TAYLOR.dwg