

A1 SIZE 594mm x 841mm

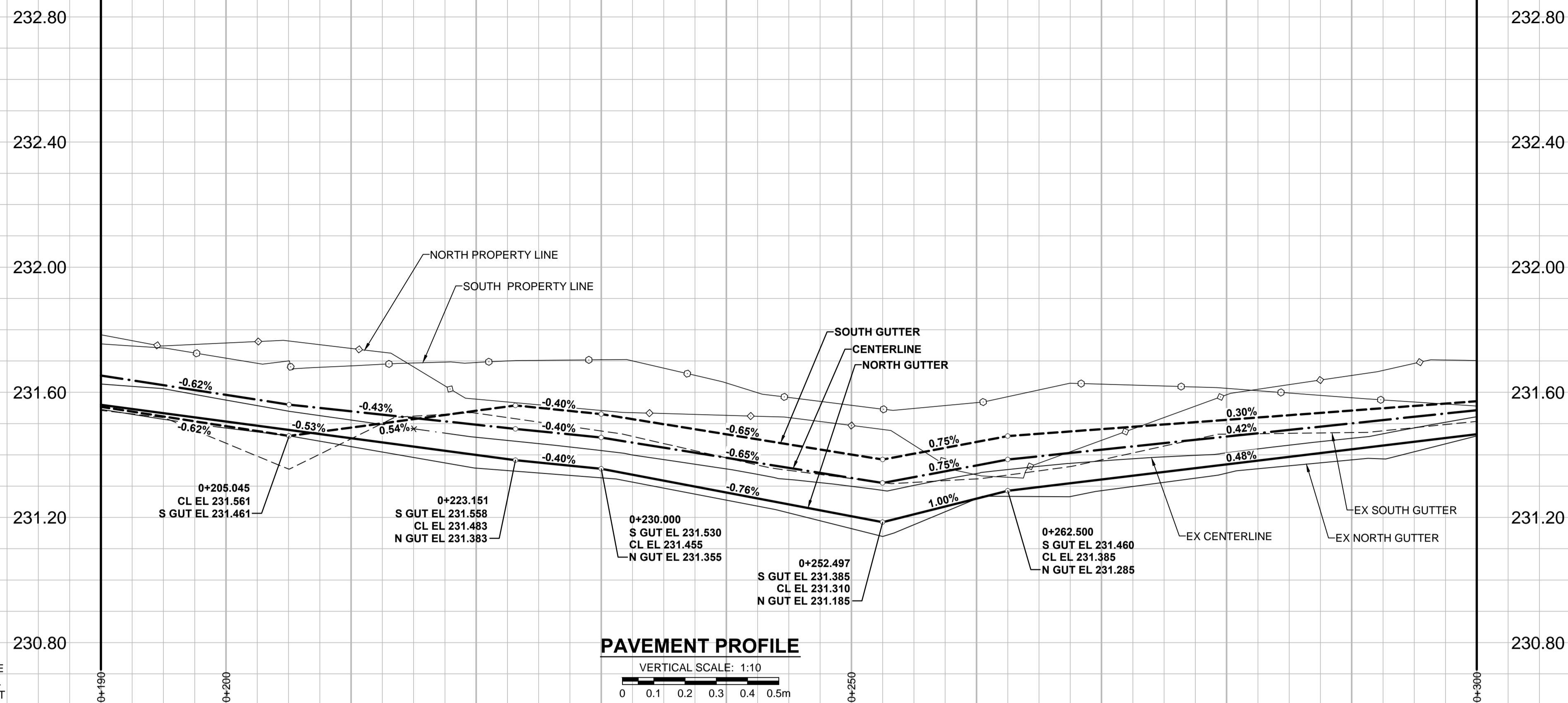

- NOTES**
- ADJUST MH AND CB RIMS TO NEW GRADES.
 - LAMP STANDARDS, HYDRO POLES, AND ANCHORS THAT REQUIRE TEMPORARY SUPPORT, REMOVAL OR REPLACEMENT, TO BE DONE SO AT THE EXPENSE OF THE CONTRACTOR AS NECESSARY.
 - CONTRACTOR TO REGRADE/RENEW EXISTING PRIVATE SIDEWALKS TO LIMITS AS SHOWN. SIDEWALKS TO BE RENEWED WITH CONCRETE UNLESS NOTED OTHERWISE.
 - CONTRACTOR TO TAKE PRECAUTIONARY STEPS TO PROTECT EXISTING TREES WITHIN THE LIMITS OF CONSTRUCTION FROM DAMAGE FROM CONSTRUCTION ACTIVITIES AS OUTLINED IN THE SPECIFICATIONS.
 - CONTRACTOR TO CONFIRM THE LOCATION OF ALL UTILITIES/SERVICES IN THE FIELD PRIOR TO CONSTRUCTION.
 - MODIFIED BARRIER CURB TO BE USED AT ALL INTERSECTION RADII, BACK LANE RADII AND BULLNOSES.
 - CONTRACTOR TO OVERLAY DRIVEWAYS TO ENSURE POSITIVE DRAINAGE TO NEW STREET GRADES. FINAL LIMITS TO BE DETERMINED IN THE FIELD BY CONTRACT ADMINISTRATOR.
 - CB SD-023 & SD-024 OFFSETS ARE DIMENSIONED TO BOC. CB SD-025 OFFSETS ARE DIMENSIONED O/C.
 - REFER TO BID OPPORTUNITY FOR DETAILS REGARDING TRAFFIC MANAGEMENT.
 - ADD 200.000m TO ABBREVIATED ELEVATIONS TO OBTAIN GEODETIC ELEVATIONS.

PLOT: 4/29/2015 6:05:05 PM

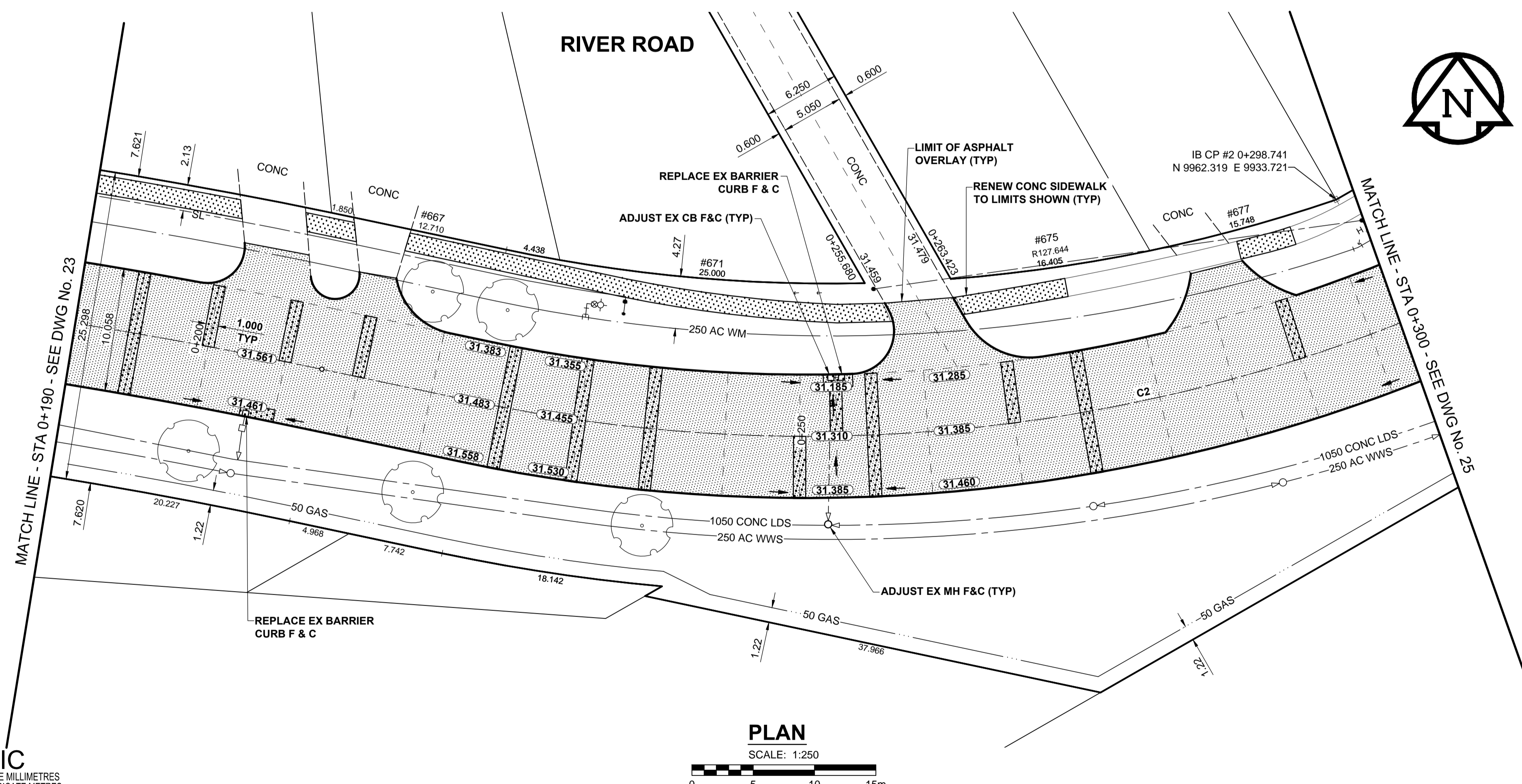

CONTROL LINE - COORDINATES

NAME	NORTHING	EASTING
PC 0+079.812	9956.512	9721.097
PT 0+210.452	9948.754	9851.002
PC 0+223.151	9946.084	9863.417
PT 0+318.735	9960.307	9955.809

CONTROL LINE - CURVES

CURVE	RADIUS	LENGTH	DELTA	TANGENT
C2	131.076	95.584	41°46'54"	50.029

METRIC
WHOLE NUMBERS INDICATE MILLIMETRES
DECIMALIZED NUMBERS INDICATE METRES

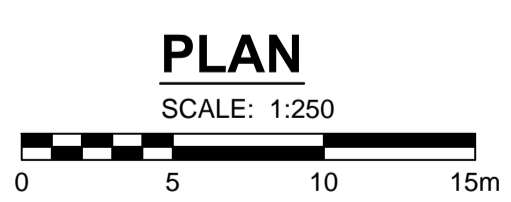

EXISTING	LEGEND - PLAN	NEW	EXISTING	LEGEND - PLAN	NEW	EXISTING	LEGEND - PLAN	NEW
	GAS		MANHOLE		CONCRETE PAVEMENT		LOCATION APPROVED	
	MTS		CATCH BASIN / CATCH PIT		CONC SIDEWALK / MEDIAN		UNDERGROUND STRUCTURES	
	HYDRO		CURB INLET WITH BOX		ASPHALT PAVEMENT		SUPR. U/G STRUCTURES	DATE
	CATV / FIBRE OPTIC		TREE		PAVING STONE		COMMITTEE	
	TRAFFIC SIGNALS / PIT		TEST HOLE		GRAVEL		NOTE:	
	LAND DRAINAGE SEWER		PROPERTY LINE		RAMP CURB		LOCATION APPROVED	
	SANITARY/COMBINED SEWER		SURVEY BAR		PLANING / REMOVAL		LOCATION APPROVED	
	SEWER SERV/DRAINAGE CONN		FENCE					
	WATERMAIN		BOC / EDGE OF PAVEMENT					
	SUBDRAIN		ELEVATION					
	DITCH		TRAFFIC SIGN					

GBM 63-002
ELEV 232.842

N.E. Cor. Minnetonka St. & River Rd., Tpk. in S. Conc. foundation of main wall of Minnetonka School No. 200 Minnetonka St., 2.0 m E. & 0.1 m below track of S.W. Cor. of Bldg.

No.	REVISIONS	DATE	BY
B	ISSUED FOR TENDER	15/04/30	RPB
A	ISSUED FOR CITY REVIEW	15/04/28	RPB

MORRISON HERSHFELD

DESIGNED BY: RPB
DRAWN BY: DML

CHECKED BY: WRJ
APPROVED BY: BWB

HOR. SCALE: 1:250
VERT. SCALE: 1:10

DATE: 15/04/28

PROFESSIONAL'S SEAL

PROVINCE OF MANITOBA
REGISTERED PROFESSIONAL ENGINEER

R.P. BRUCE

CONSULTANT DRAWING No.
W150003 River-PP-02.dwg

THE CITY OF WINNIPEG
PUBLIC WORKS DEPARTMENT
ENGINEERING DIVISION

2015 LOCAL STREET & ALLEY RENEWAL PROGRAM

RIVER ROAD
MINNETONKA ST TO NICOLLET AV
REHABILITATION
HORIZONTAL AND VERTICAL ALIGNMENT
STA 0+190 TO STA 0+300

CITY DRAWING NUMBER: N/A
SHEET 24 OF 31
DRAWING No. 24
REV B

BID OPPORTUNITY No. 18-2015

FILE NAME: W150003 River-PP-02.dwg, Saved By: ddenne