

SEWER SERVICE INFORMATION			
ADDRESS	SIZE (mm)	± DIST	REMARKS
366 MARSHALL BY RESIDENTIAL	-	-	-
367 MARSHALL BY RESIDENTIAL	-	-	SERVED OFF 450 CLAY WWS RUNNING E 1.53 N OF NHL
370 MARSHALL BY RESIDENTIAL	-	4.58 W OF WHL	-
371 MARSHALL BY RESIDENTIAL	-	-	-
374 MARSHALL BY RESIDENTIAL	-	-	-
375 MARSHALL BY RESIDENTIAL	-	-	-
379 MARSHALL BY RESIDENTIAL	-	-	-

NOTE: CHAINAGES SHOWN ARE ALONG E PL OF MARSHALL BAY.

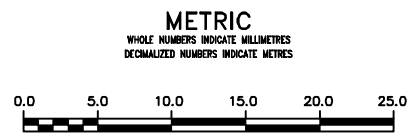
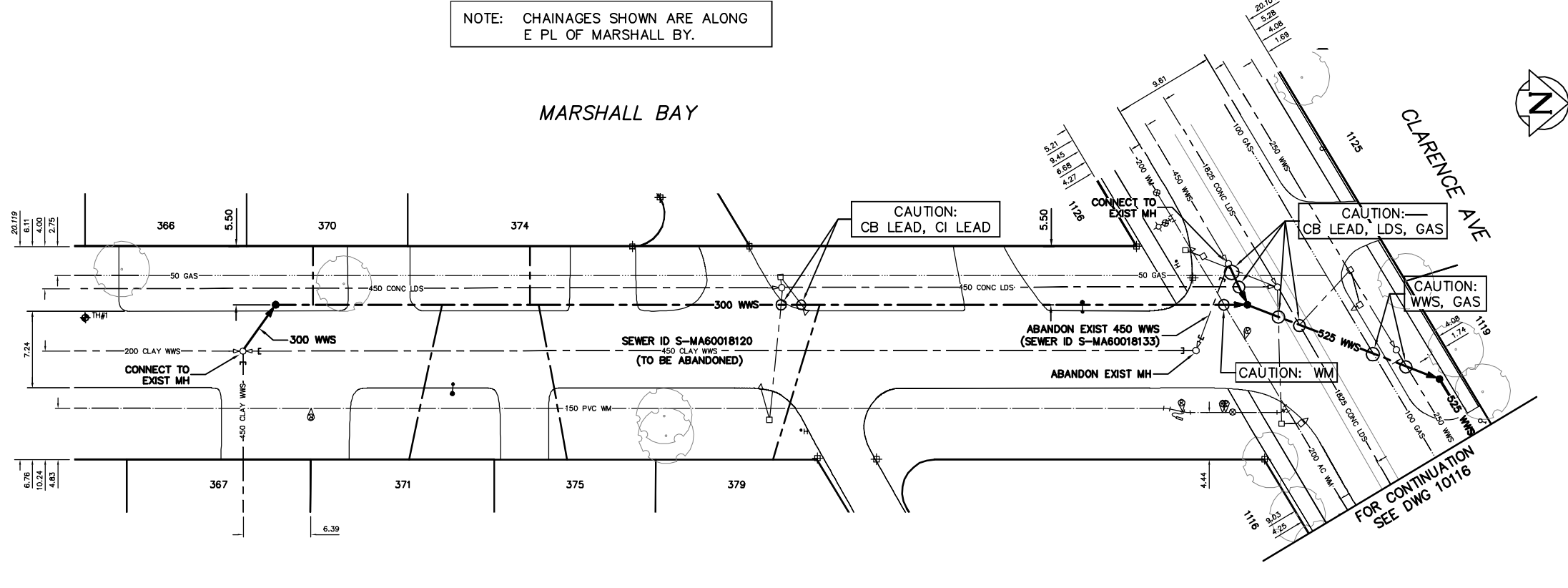

WARNING
 IF POWER EQUIPMENT OR EXPLOSIVES ARE TO BE USED FOR EXCAVATION ON THIS PROJECT THE CONTRACTOR MUST:
 1) NOTIFY THE GAS COMPANY OF THE PROPOSED LOCATION OF EXCAVATION.
 2) TAKE PRECAUTION TO AVOID DAMAGE TO GAS COMPANY INSTALLATIONS.
 SEE PROVINCIAL REGULATION 21072 FOR DETAILS

LOCATION APPROVED UNDERGROUND STRUCTURES
 SUPV. U/G STRUCTURES COMMITTEE DATE
 NOTE:
 LOCATION OF UNDERGROUND STRUCTURES AS SHOWN ARE BASED ON THE BEST INFORMATION AVAILABLE BUT NO GUARANTEE IS GIVEN THAT ALL EXISTING UTILITIES ARE SHOWN OR THAT THE GIVEN LOCATIONS ARE EXACT. CONFIRMATION OF EXISTENCE AND EXACT LOCATION OF ALL SERVICES MUST BE OBTAINED FROM THE INDIVIDUAL UTILITIES BEFORE PROCEEDING WITH CONSTRUCTION.

B.M. ELEV.				
CONSTRUCTION COMPLETION DATE: YYYY MM DD				
DESIGNED BY	TS			
CHECKED BY	SC			
DRAWN BY	CJH			
APPROVED BY	KZ			
SCALE:				
HORIZONTAL	1:250			
VERTICAL	1:50			
RELEASED FOR CONSTRUCTION				
NO.	REVISIONS	DATE	BY	DATE
				2012 05 07
				2012 05 09

ENGINEER'S SEAL
 ORIGINAL SIGNED BY S.R.J. COURNOYER 12/05/07
 CONSULTANT DRAWING NUMBER

THE CITY OF WINNIPEG
 WATER AND WASTE DEPARTMENT
 ENGINEERING DIVISION
 2012 MARSHALL BAY SEWER RENEWAL
 MARSHALL BAY
 1ST MH N OF BRISBANE AVENUE TO CLARENCE AVENUE
 SHEET 2 OF 6
 CITY DRAWING NUMBER 10115