



THE CITY OF WINNIPEG

WATER AND WASTE DEPARTMENT

BID OPPORTUNITY NO. 908-2010

2010 Outfall Maintenance Program Outfall Repairs

DRAWING NO.	TITLE
	COVER SHEET
908-2010-Drawing_LD-5581	CLOUTIER DRIVE OUTFALL (RR-7) PLAN AND PROFILE
908-2010-Drawing_LD-5582	BURROWS AVENUE OUTFALL (RR-76) PLAN AND PROFILE
908-2010-Drawing_LD-5583	POLSON AVENUE OUTFALL (RR-83) PLAN AND PROFILE
908-2010-Drawing_LD-5585	POLSON AVENUE LINING SECTIONS AND MISCELLANEOUS DETAILS
908-2010-Drawing_LD-5586	MISCELLANEOUS DETAILS

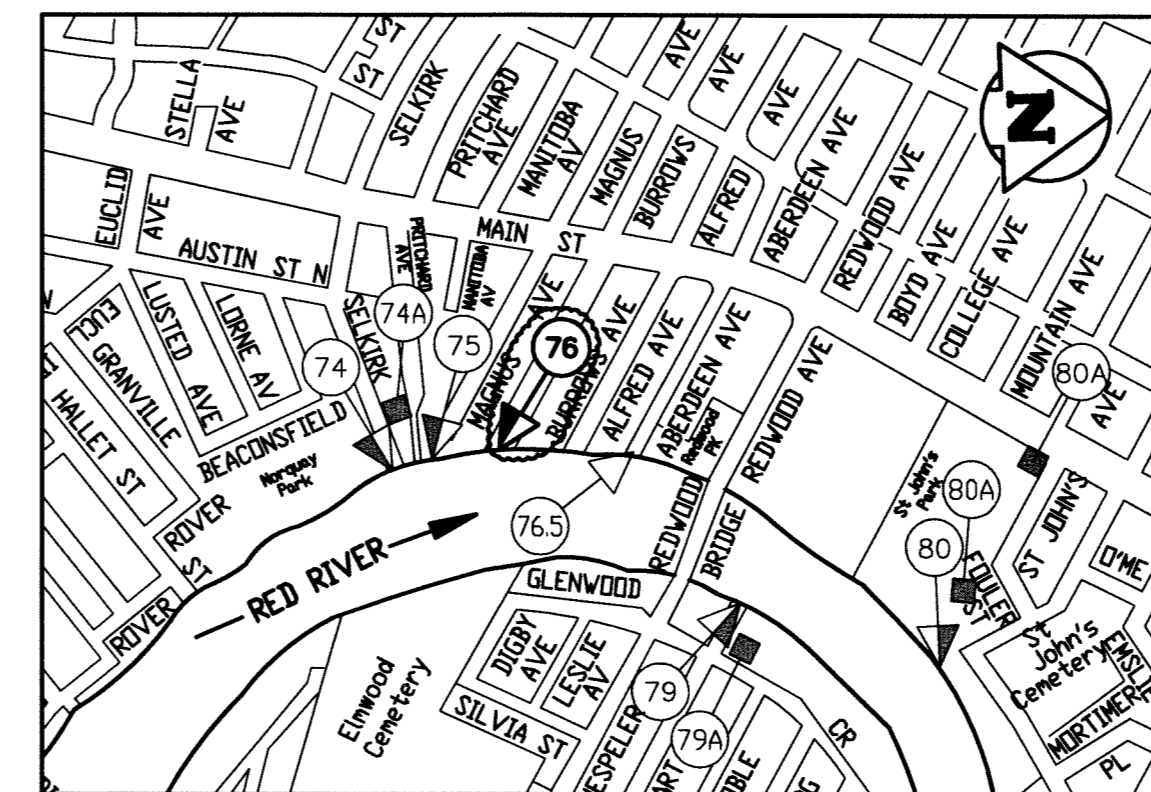

BURROWS AVE. OUTFALL (RR-76)

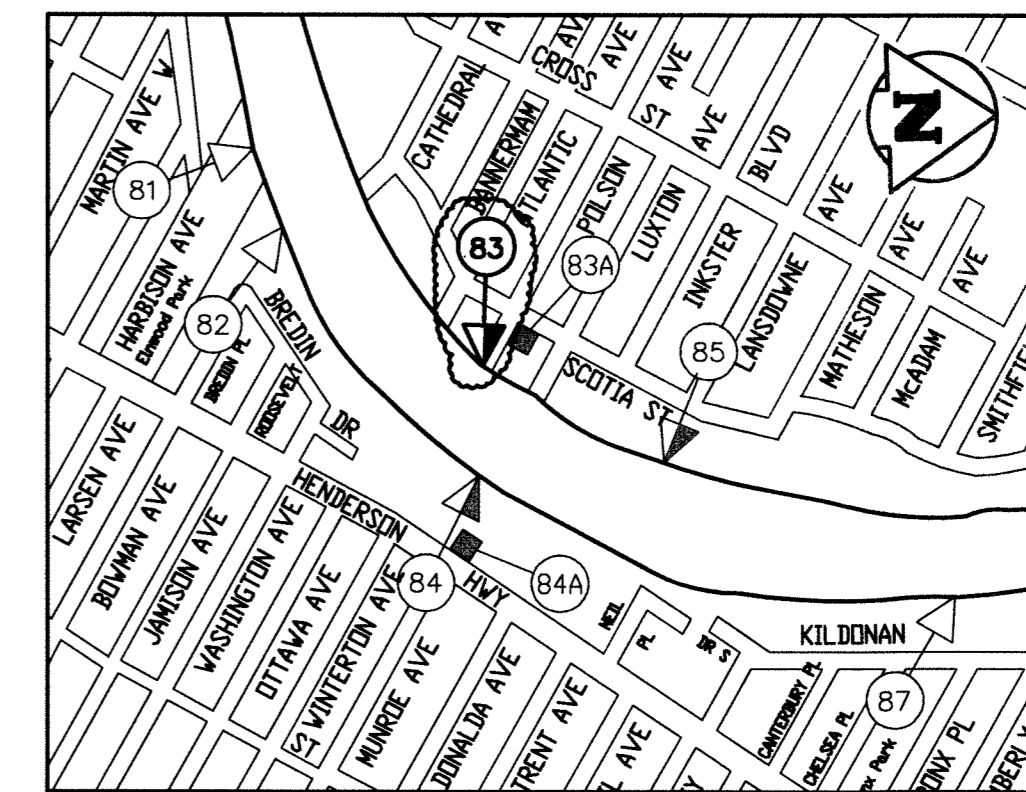

POLSON AVE. OUTFALL (RR-83)

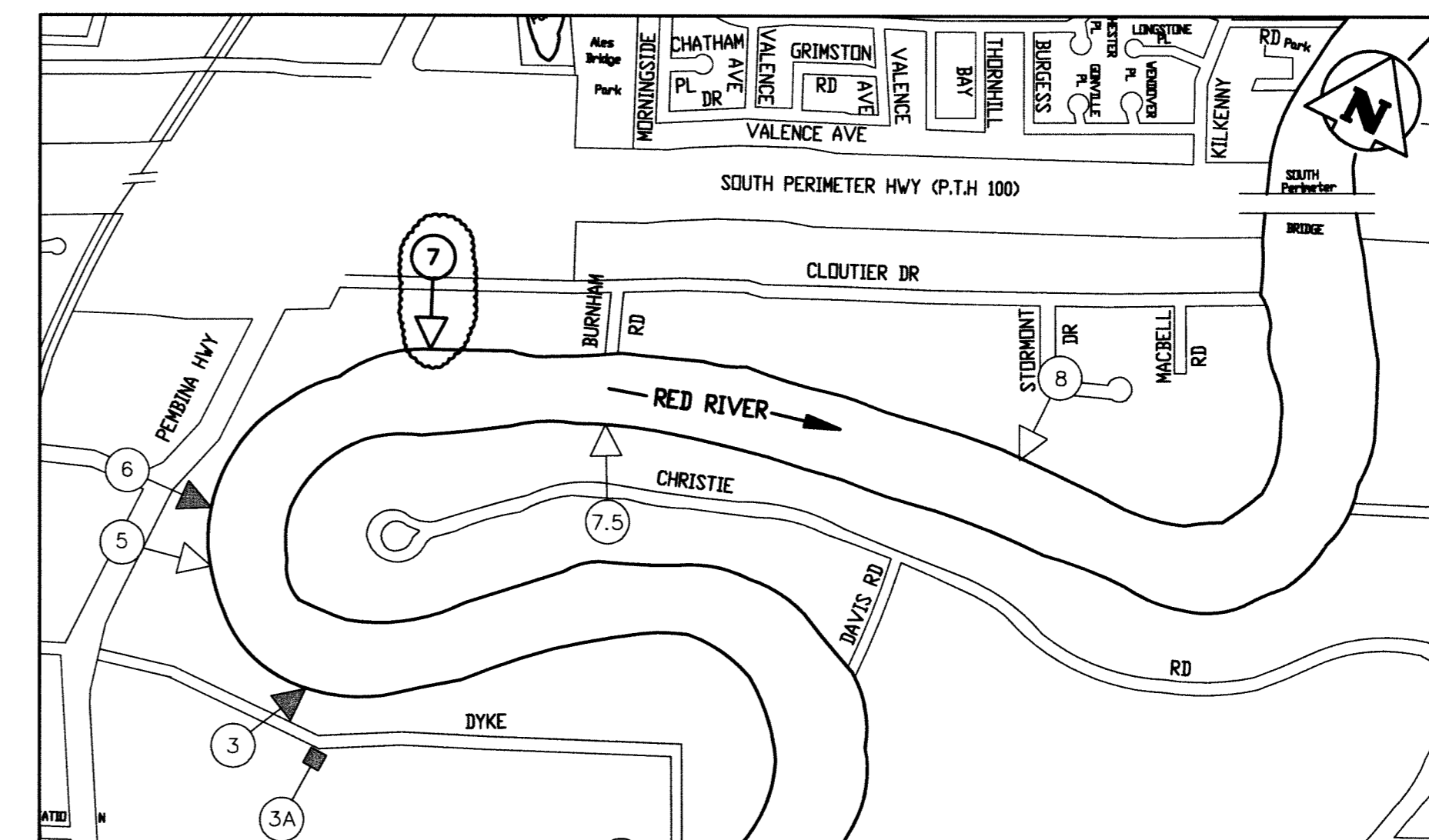

CLOUTIER DR. OUTFALL (RR-7)

LEGEND:

- LAND DRAINAGE (LDS)
- COMBINED SEWER OVERFLOW (CS)
- WASTEWATER OVERFLOW (WWS)
- LIFT STATION

RELEASED FOR CONSTRUCTION BY:

WATER & WASTE DEPARTMENT PROJECT ENGINEER

DATE: _____

