

METALLIZING INSTALLATION DETAIL – AT REPAIRED CONCRETE

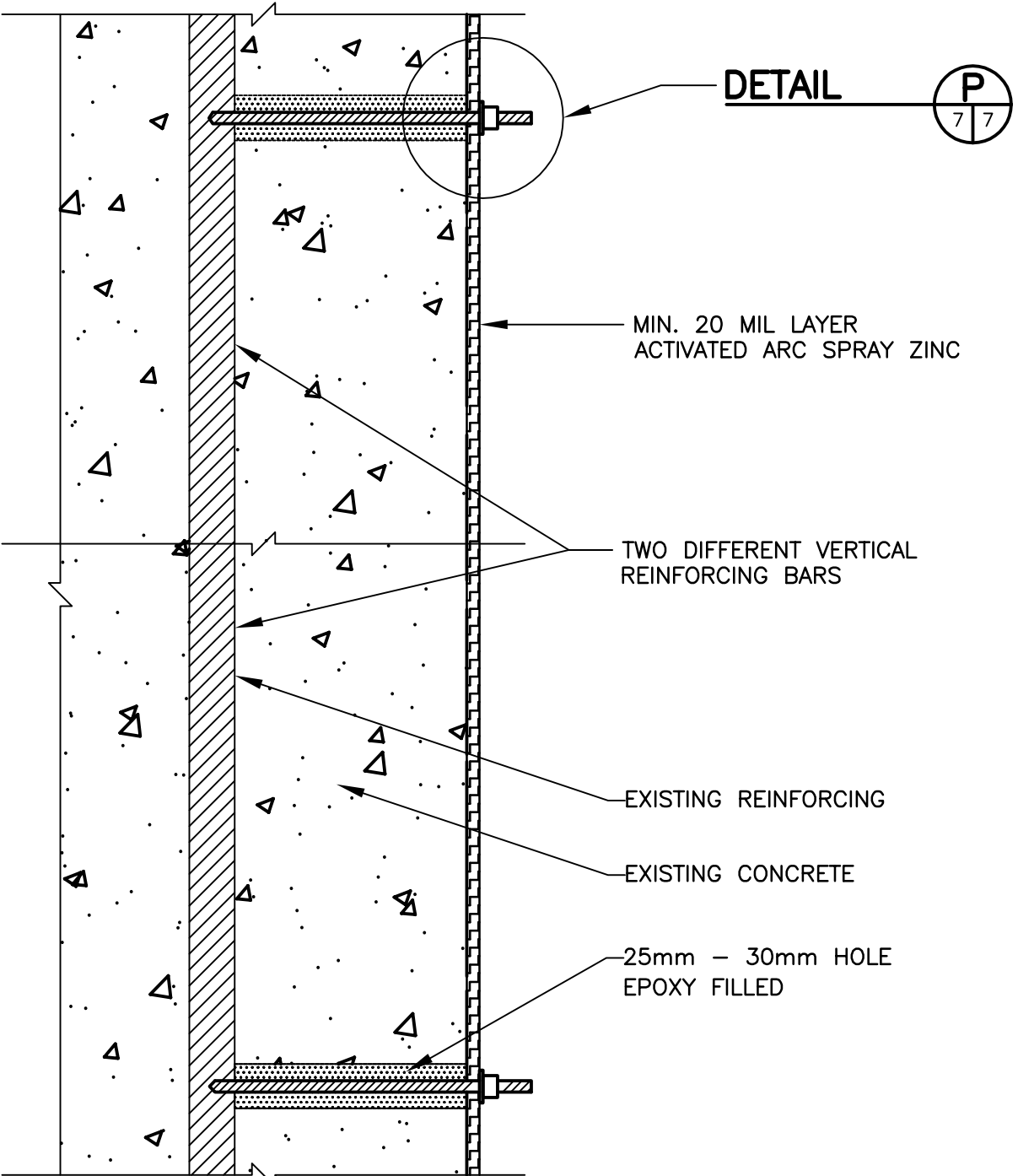

METALLIZING INSTALLATION DETAIL – AT SOUND CONCRETE

- METALLIZING NOTES:**
1. COMPLETE ALL NECESSARY REPAIRS. CONNECTIONS TO EXPOSED REBAR MAY BE MADE AT THIS TIME. ALLOW CONCRETE TO FULLY CURE.
 2. CONNECT THREADED GALVANIZED ROD TO STEEL VIA DRILL AND TAP, BRAZE, OR WELD CONNECTION. TWO CONNECTIONS ARE REQUIRED PER VERTICAL FACE. CONNECTIONS SHALL BE ESTABLISHED WITH TWO DIFFERENT VERTICAL REINFORCING BARS.
 3. CONTINUITY BETWEEN THE TWO CONNECTION LOCATIONS SHALL BE ESTABLISHED PRIOR TO METALLIZING.
 4. CONCRETE SURFACES TO BE METALLIZED ARE TO BE FREE OF ANY BARRIER COATINGS, OIL, DUST, GREASE ETC.
 5. PROVIDE PROTECTION TO BEARINGS.
 6. METALLIZE ALL SURFACES INDICATED.
 7. PLACE 100 X 100 FLATTENED EXPANDED ZINC MESH PLATE, WASHER AND NUT OVER THREADED ROD AND TIGHTEN NUT. THREADED ROD SHOULD EXTEND 50 mm BEYOND THE SURFACE OF THE CONCRETE.
 8. PROVIDE AN ADDITIONAL LAYER OF METALLIZING OVER THE ZINC MESH PLATE. THE ADDITIONAL LAYER SHALL EXTEND 150 mm BEYOND THE PLATE IN ALL DIRECTIONS.
 9. APPLY HUMECTANT TO ALL METALLIZED SURFACES.
 10. SPECIFICATIONS SHALL SUPERCEDE DRAWING NOTES

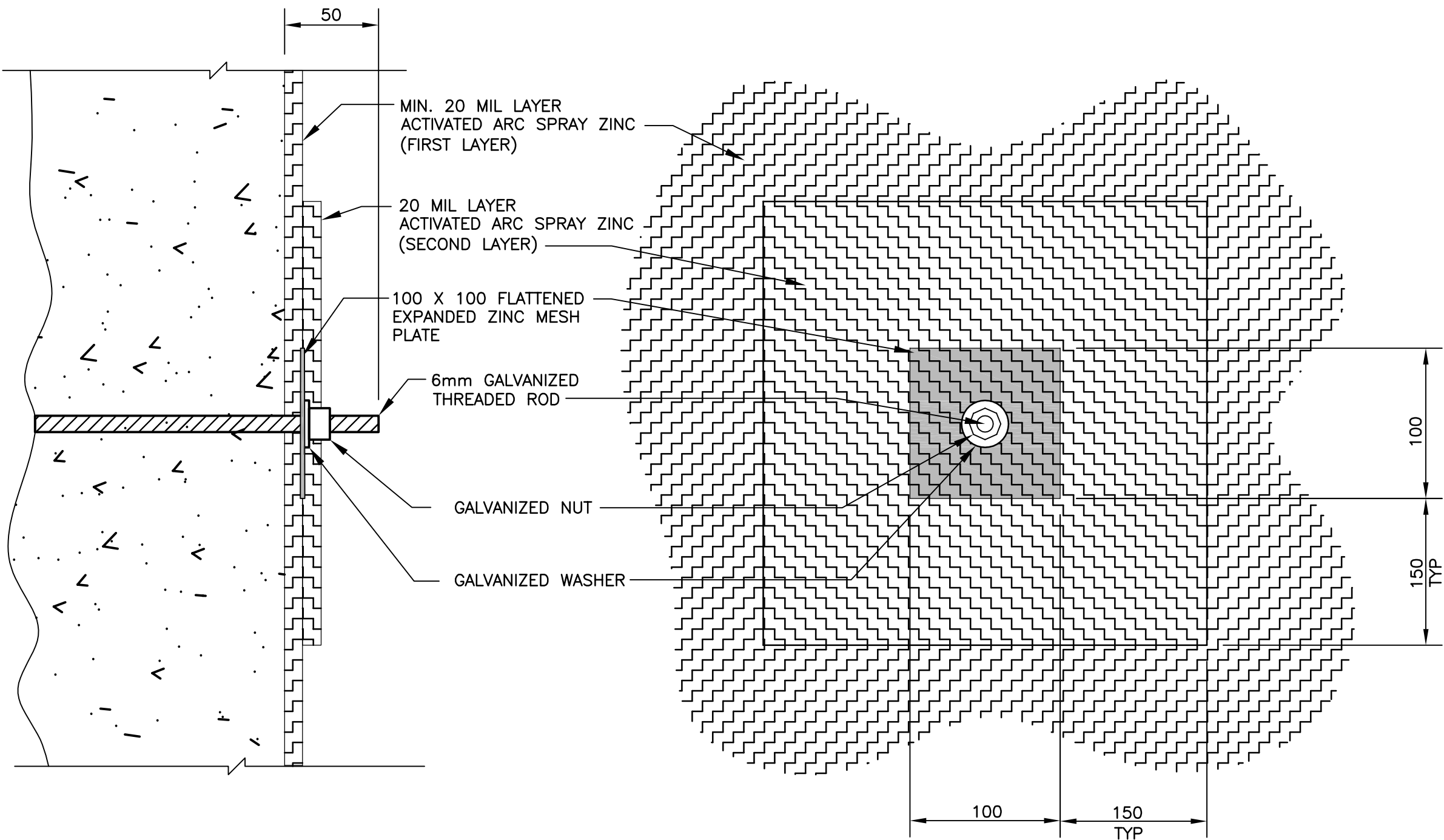

DETAIL P 7/7
N.T.S.

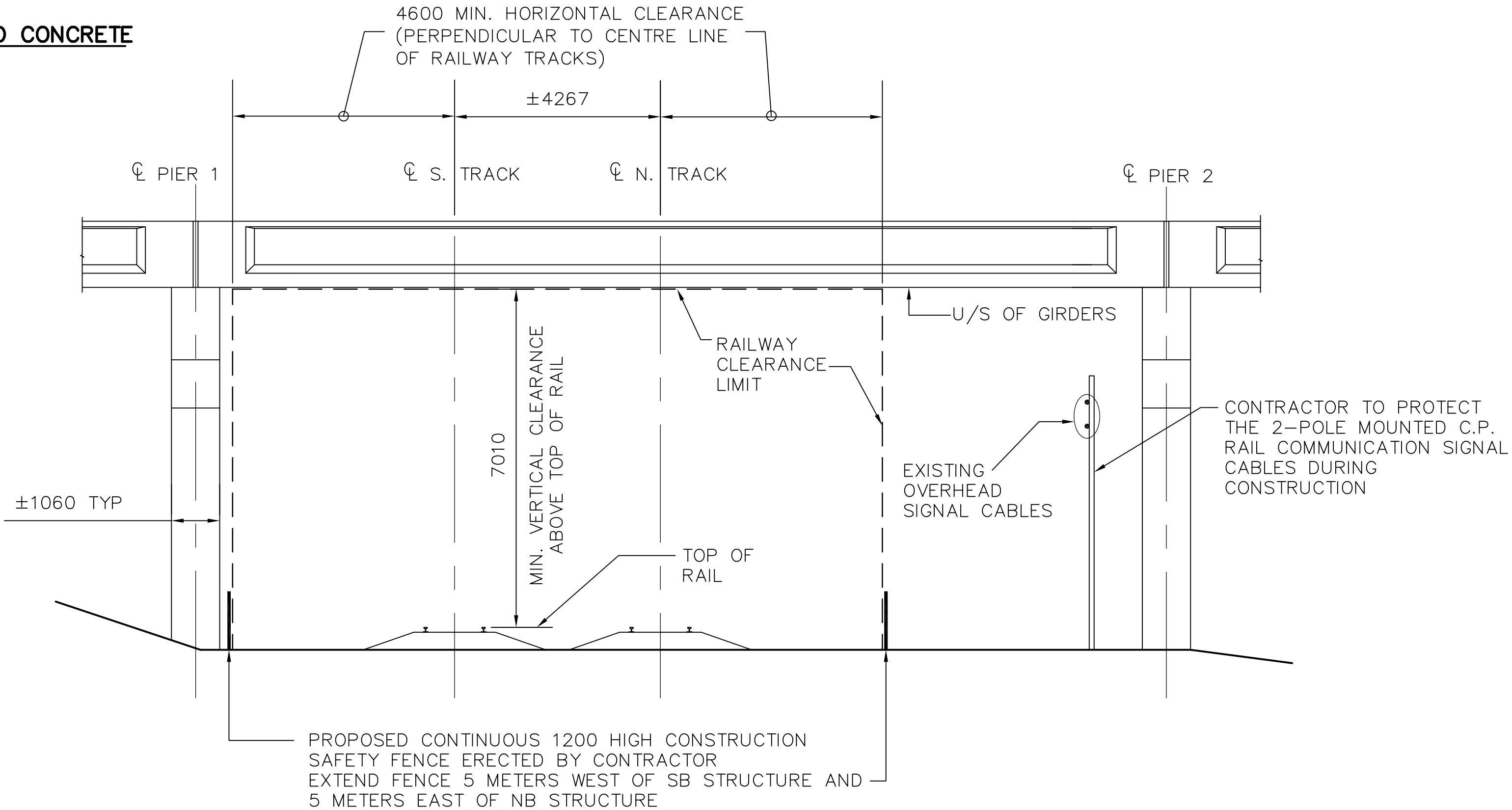

RAILWAY TRACK CLEARANCE DIAGRAM – CPR KEEWATIN
1: 100 TYPICAL FOR NB AND SB STRUCTURES

400DILLON ACAD FILE: C:\CAD\103192\Contract\Current\Bldg-Op\5.6.7.9.10 REPAIR DETS.dwg 4/27/2010



B.M. ELEV.	DESIGNED BY GCL		ENGINEER'S SEAL
	DRAWN BY CDW		
	CHECKED BY		
	APPROVED BY		
	HOR. SCALE AS NOTED	RELEASED FOR CONSTRUCTION	PROVINCE OF MANITOBA
	VERTICAL AS NOTED	ORIGINAL SIGNED BY B.A. NEIRNICK	REGISTERED PROFESSIONAL ENGINEER
0 ISSUED FOR TENDER	05/20/10	MRD	CONSTRUCTANT PROJECT NO. 103192
NO. REVISIONS	DATE	BY	DATE MAY 20, 2010

		THE CITY OF WINNIPEG PUBLIC WORKS DEPARTMENT	
2010 CAPITAL PROGRAM		GIRDER REPAIRS AT ROUTE 20 KEEWATIN OVERPASS	
KEEWATIN OVERPASS – METALLIZING DETAILS AND TRACK CLEARANCE DIAGRAM		CITY DRAWING NUMBER B123-10-07 SHEET 7 OF 10 BID OPPORTUNITY 421-2010	